

1533 Seabreeze Street, Pride, Clearwater, Pinellas County, Florida, United States, 33756

Gross Living Area: 2052 sq. ft

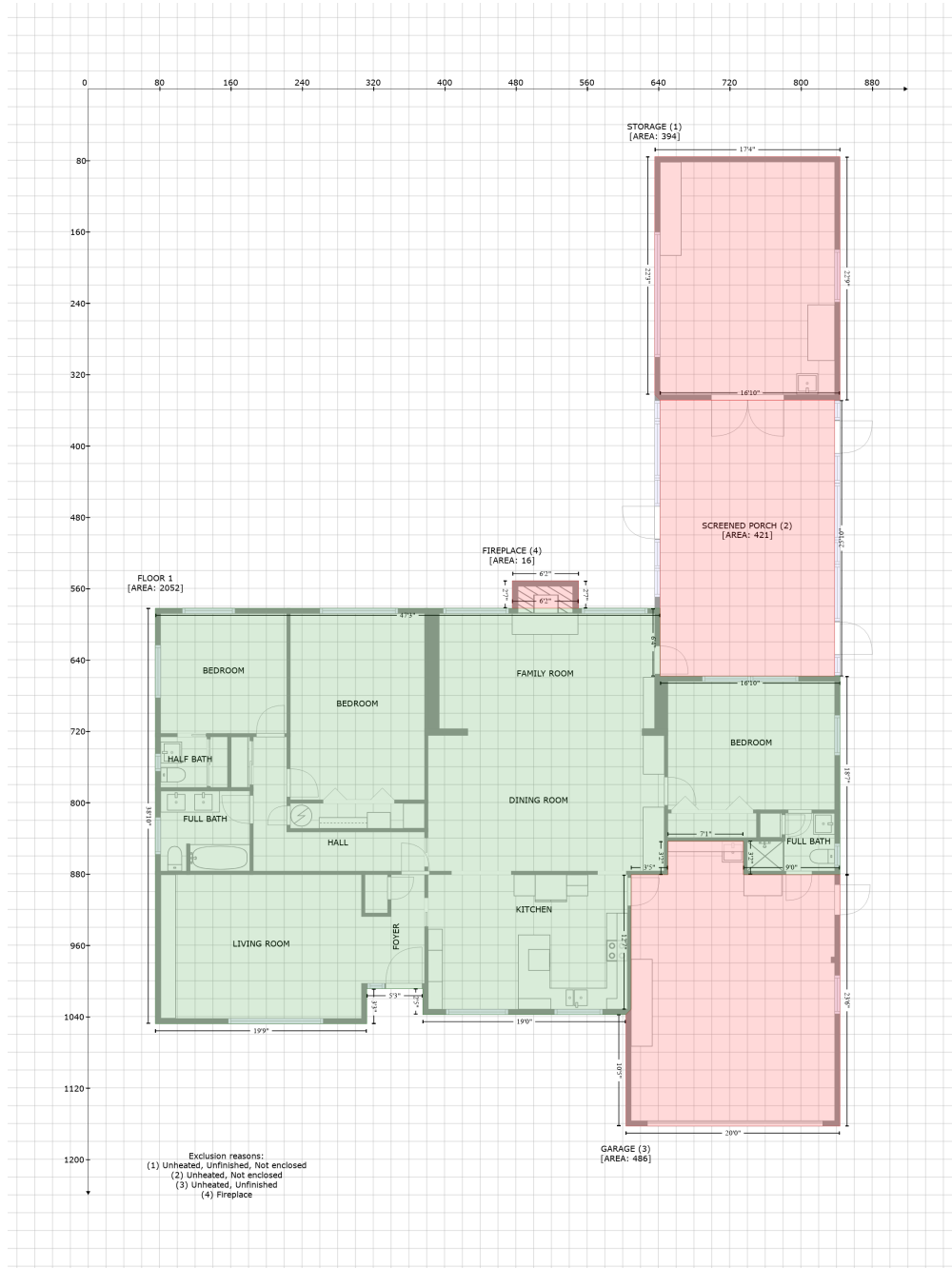

Space

Area (sq. ft)

Calculation Coordinate Polygon Area Algorithm using inches

FLOOR 1
(Living area)

2052

$$\begin{aligned}
 & -((642 + 642) * (582.3 - 658.3) + (642 + 843.9) * (658.3 - 658.3) + (843.9 + 843.9) * (658.3 - 881) \\
 & + (843.9 + 735.5) * (881 - 881) + (735.5 + 735.5) * (881 - 843.4) + (735.5 + 650.8) * (843.4 - \\
 & 843.4) + (650.8 + 650.8) * (843.4 - 881) + (650.8 + 609.5) * (881 - 881) + (609.5 + 609.5) * (881 - \\
 & 1031.9) + (609.5 + 603.5) * (1031.9 - 1037.9) + (603.5 + 375.6) * (1037.9 - 1037.9) + (375.6 + \\
 & 375.6) * (1037.9 - 1008.8) + (375.6 + 312.8) * (1008.8 - 1008.8) + (312.8 + 312.8) * (1008.8 - \\
 & 1048.2) + (312.8 + 75.3) * (1048.2 - 1048.2) + (75.3 + 75.3) * (1048.2 - 582.3) + (75.3 + 642) * \\
 & (582.3 - 582.3)) * 0.5 * 0.00694
 \end{aligned}$$

1533 Seabreeze Street, Pride, Clearwater, Pinellas County, Florida, United States, 33756

Gross Living Area: 2052 sq. ft

Space	Area (sq. ft)	Calculation <small>Coordinate Polygon Area Algorithm using inches</small>
STORAGE (Non-living area)	394	$-\left((843.9 + 843.9) * (76 - 348.8) + (843.9 + 642) * (348.8 - 348.8) + (642 + 636) * (348.8 - 342.8) + (636 + 636) * (342.8 - 76) + (636 + 843.9) * (76 - 76)\right) * 0.5 * 0.00694$
SCREENED PORCH (Non-living area)	421	$-\left((837.9 + 837.9) * (348.8 - 658.3) + (837.9 + 642) * (658.3 - 658.3) + (642 + 642) * (658.3 - 348.8) + (642 + 837.9) * (348.8 - 348.8)\right) * 0.5 * 0.00694$
GARAGE (Non-living area)	486	$-\left((735.5 + 735.5) * (843.4 - 881) + (735.5 + 843.9) * (881 - 881) + (843.9 + 843.9) * (881 - 1162.9) + (843.9 + 603.5) * (1162.9 - 1162.9) + (603.5 + 603.5) * (1162.9 - 1037.9) + (603.5 + 609.5) * (1037.9 - 1031.9) + (609.5 + 609.5) * (1031.9 - 881) + (609.5 + 650.8) * (881 - 881) + (650.8 + 650.8) * (881 - 843.4) + (650.8 + 735.5) * (843.4 - 843.4)\right) * 0.5 * 0.00694$
FIREPLACE (Non-living area)	16	$-\left((550.6 + 550.6) * (551.4 - 582.3) + (550.6 + 476.1) * (582.3 - 582.3) + (476.1 + 476.1) * (582.3 - 551.4) + (476.1 + 550.6) * (551.4 - 551.4)\right) * 0.5 * 0.00694$