

Building Sketch

Borrower/Client			
Property Address 5229 Mt. Holly Huntersville Road			
City Charlotte	County	State NC	Zip Code 28216
Lender			

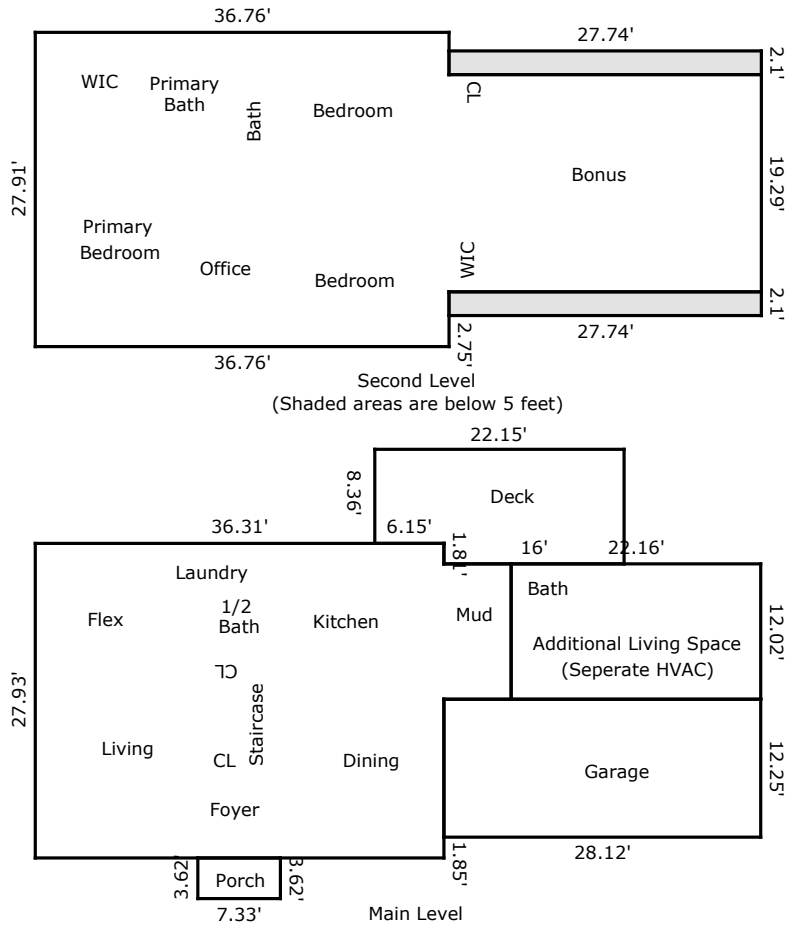

TOTAL Sketch by a la mode

Area Calculations Summary

Living Area	Calculation Details	
Main Living Area	1085.78 Sq ft	12.02 × 5.96 = 71.64 36.31 × 27.93 = 1014.14
Second Level	1561.08 Sq ft	27.91 × 36.76 = 1025.97 27.74 × 19.29 = 535.1
Additional Living Space	266.36 Sq ft	22.16 × 12.02 = 266.36
Total Living Area (Rounded):	2913 Sq ft	
Non-living Area		
Garage	344.47 Sq ft	12.25 × 28.12 = 344.47
Porch	26.53 Sq ft	7.33 × 3.62 = 26.53
Deck	214.13 Sq ft	8.36 × 6.15 = 51.41 16 × 10.17 = 162.72
Area Below 5 Feet	58.25 Sq ft	27.74 × 2.1 = 58.25
Area Below 5 Feet	58.25 Sq ft	2.1 × 27.74 = 58.25

Building Sketch

Borrower/Client

Property Address

City County State Zip Code

Lender

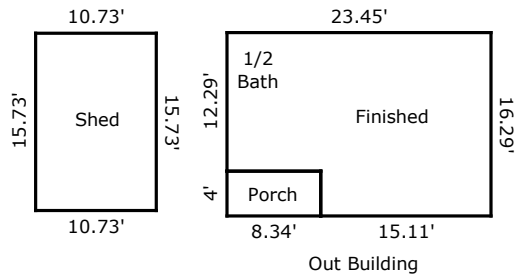

TOTAL Sketch by a la mode

Area Calculations Summary

Non-living Area

Shed	168.74 Sq ft	$15.73 \times 10.73 = 168.74$
Shed	348.64 Sq ft	$16.29 \times 15.11 = 246.14$ $8.34 \times 12.29 = 102.5$
Porch	33.36 Sq ft	$4 \times 8.34 = 33.36$