

Home Data Report

944 Burlington Heights Drive, Burlington, Skagit County, Washington, United States, 98233



Property Summary

 **2** garages

 **2** bedrooms

 **2** bathrooms

 **0** half baths

 **2** floors

 **2,213**
Gross Living Area sqft

 **4,798**
total sqft

Home Data Report

944 Burlington Heights Drive, Burlington, Skagit
County, Washington, United States, 98233

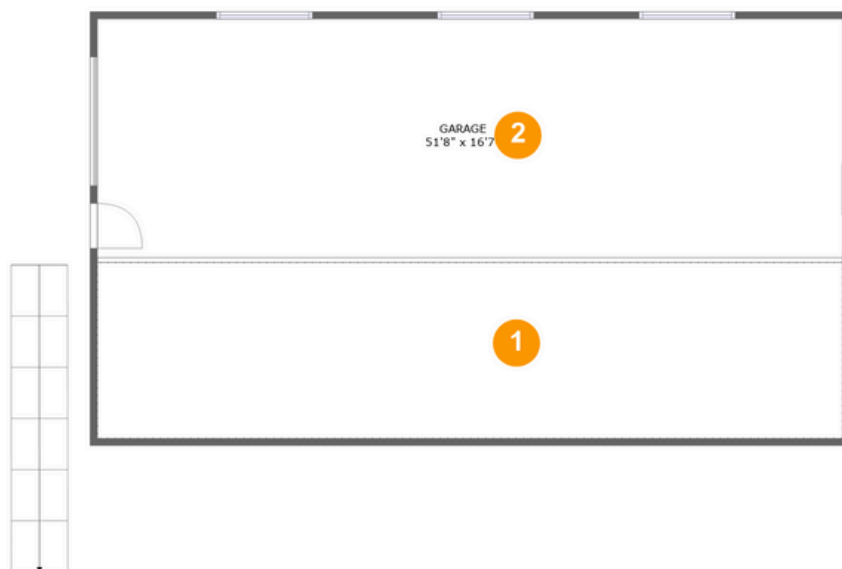

Room Dimensions

Floor 1

Total sqft: 1586

Living area: 0

#	Room name	Dimensions	Area (sqft)	Counted as Living Area
1	Crawl Space	51'8" x 12'2"	631 sq. ft	No
2	Garage	51'8" x 16'7"	873 sq. ft	No

Home Data Report

944 Burlington Heights Drive, Burlington, Skagit County, Washington, United States, 98233

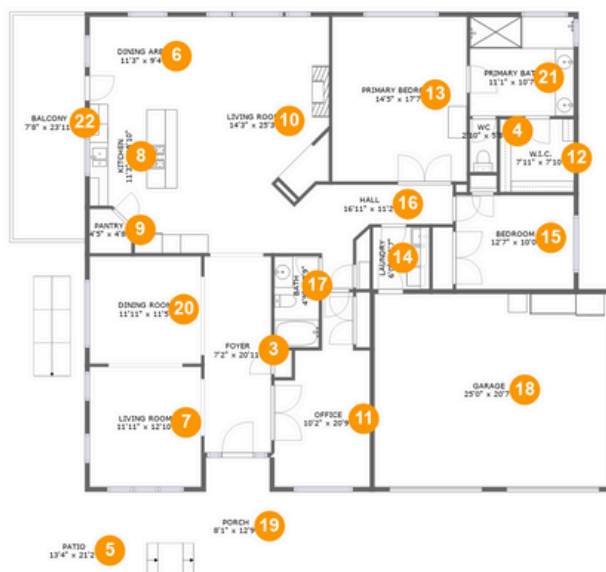

Room Dimensions

Floor 2

Total sqft: 3212

Living area: 2213

#	Room name	Dimensions	Area (sqft)	Counted as Living Area
3	Foyer	7'2" x 20'11"	150 sq. ft	Yes
4	Wc	2'10" x 5'8"	16 sq. ft	Yes
5	Patio	13'4" x 21'2"	175 sq. ft	No
6	Dining Area	11'3" x 9'4"	106 sq. ft	Yes
7	Living Room	11'11" x 12'10"	153 sq. ft	Yes
8	Kitchen	11'3" x 15'10"	158 sq. ft	Yes
9	Pantry	4'5" x 4'8"	19 sq. ft	Yes
10	Living Room	14'3" x 25'3"	330 sq. ft	Yes
11	Office	10'2" x 20'9"	162 sq. ft	Yes
12	W.i.c.	7'11" x 7'10"	62 sq. ft	Yes
13	Primary Bedroom	14'5" x 17'7"	253 sq. ft	Yes

Scan captured on Thu, 20 Jun 2024 03:26:27 GMT

Information is calculated by CubiCasa technology; deemed highly reliable but not guaranteed.

Home Data Report

944 Burlington Heights Drive, Burlington, Skagit
County, Washington, United States, 98233

#	Room name	Dimensions	Area (sqft)	Counted as Living Area
14	Laundry	6'0" x 6'7"	40 sq. ft	Yes
15	Bedroom	12'7" x 10'0"	126 sq. ft	Yes
16	Hall	16'11" x 11'2"	102 sq. ft	Yes
17	Bath	4'9" x 9'9"	46 sq. ft	Yes
18	Garage	25'0" x 20'7"	516 sq. ft	No
19	Porch	8'1" x 12'9"	99 sq. ft	No
20	Dining Room	11'11" x 11'5"	136 sq. ft	Yes
21	Primary Bath	11'1" x 10'7"	118 sq. ft	Yes
22	Balcony	7'8" x 23'11"	184 sq. ft	No

944 Burlington Heights Drive, Burlington, Skagit
County, Washington, United States, 98233

1 Floor 1 - Crawl Space



Dimensions: 51'8" x 12'2"
Area: 631 sq. ft
Counted as Living Area: No

Heated: No
Finished: No
Enclosed: No
Contiguous: Yes
Permitted: No
Wet Space: No
Addition: No
Conversion: No

2 Floor 1 - Garage

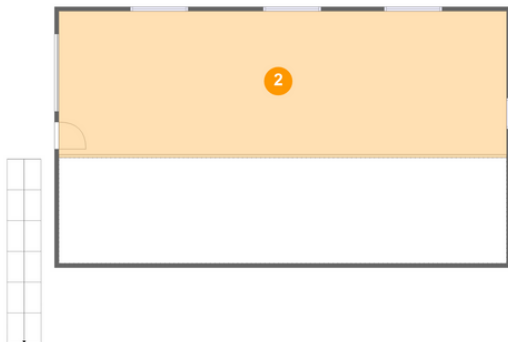

Dimensions: 51'8" x 16'7"
Area: 873 sq. ft
Counted as Living Area: No

Heated: No
Finished: No
Enclosed: Yes
Contiguous: Yes
Permitted: Yes
Wet Space: No
Addition: No
Conversion: No

944 Burlington Heights Drive, Burlington, Skagit
County, Washington, United States, 98233

3 Floor 2 - Foyer



Dimensions: 7'2" x 20'11"
Area: 150 sq. ft
Counted as Living Area:
Yes

Heated: Yes
Finished: Yes
Enclosed: Yes
Contiguous:
Yes Permitted:
Yes Wet
Space: No
Addition: No
Conversion: No

4 Floor 2 - Wc



Dimensions: 2'10" x 5'8"
Area: 16 sq. ft
Counted as Living Area:
Yes

Heated: Yes
Finished: Yes
Enclosed: Yes
Contiguous:
Yes
Permitted: Yes
Wet Space: Yes
Addition: No
Conversion: No

5 Floor 2 - Patio



Dimensions: 13'4" x 21'2"
Area: 175 sq. ft
Counted as Living Area: No

Heated: No
Finished: Yes
Enclosed: No
Contiguous: Yes
Permitted: Yes
Wet Space: No
Addition: No
Conversion: No

944 Burlington Heights Drive, Burlington, Skagit
County, Washington, United States, 98233

6 Floor 2 - Dining Area



Dimensions: 11'3" x 9'4"
Area: 106 sq. ft
Counted as Living Area:
Yes

Heated: Yes
Finished: Yes
Enclosed: Yes
Contiguous:
Yes Permitted:
Yes Wet
Space: No
Addition: No
Conversion: No

7 Floor 2 - Living Room



Dimensions: 11'11" x 12'10"
Area: 153 sq. ft
Counted as Living Area:
Yes

Heated: Yes
Finished: Yes
Enclosed: Yes
Contiguous:
Yes Permitted:
Yes Wet
Space: No
Addition: No
Conversion: No

8 Floor 2 - Kitchen



Dimensions: 11'3" x 15'10"
Area: 158 sq. ft
Counted as Living Area:
Yes

Heated: Yes
Finished: Yes
Enclosed: Yes
Contiguous:
Yes Permitted:
Yes Wet
Space: No
Addition: No
Conversion: No

944 Burlington Heights Drive, Burlington, Skagit
County, Washington, United States, 98233

9 Floor 2 - Pantry



Dimensions: 4'5" x 4'8"
Area: 19 sq. ft
Counted as Living Area:
Yes

Heated: Yes
Finished: Yes
Enclosed: Yes
Contiguous:
Yes Permitted:
Yes Wet
Space: No
Addition: No
Conversion: No

10 Floor 2 - Living Room



Dimensions: 14'3" x 25'3"
Area: 330 sq. ft
Counted as Living Area:
Yes

Heated: Yes
Finished: Yes
Enclosed: Yes
Contiguous:
Yes Permitted:
Yes Wet
Space: No
Addition: No
Conversion: No

11 Floor 2 - Office



Dimensions: 10'2" x 20'9"
Area: 162 sq. ft
Counted as Living Area:
Yes

Heated: Yes
Finished: Yes
Enclosed: Yes
Contiguous:
Yes Permitted:
Yes Wet
Space: No
Addition: No
Conversion: No

944 Burlington Heights Drive, Burlington, Skagit
County, Washington, United States, 98233

12 Floor 2 - W.i.c.



Dimensions: 7'11" x 7'10"
Area: 62 sq. ft
Counted as Living Area:
Yes

Heated: Yes
Finished: Yes
Enclosed: Yes
Contiguous:
Yes Permitted:
Yes Wet
Space: No
Addition: No
Conversion: No

13 Floor 2 - Primary Bedroom



Dimensions: 14'5" x 17'7"
Area: 253 sq. ft
Counted as Living Area:
Yes

Heated: Yes
Finished: Yes
Enclosed: Yes
Contiguous:
Yes Permitted:
Yes Wet
Space: No
Addition: No
Conversion: No

14 Floor 2 - Laundry



Dimensions: 6'0" x 6'7"
Area: 40 sq. ft
Counted as Living Area:
Yes

Heated: Yes
Finished: Yes
Enclosed: Yes
Contiguous:
Yes Permitted:
Yes Wet
Space: No
Addition: No
Conversion: No

944 Burlington Heights Drive, Burlington, Skagit
County, Washington, United States, 98233

15 Floor 2 - Bedroom



Dimensions: 12'7" x 10'0"
Area: 126 sq. ft
Counted as Living Area:
Yes

Heated: Yes
Finished: Yes
Enclosed: Yes
Contiguous:
Yes Permitted:
Yes Wet
Space: No
Addition: No
Conversion: No

16 Floor 2 - Hall



Dimensions: 16'11" x 11'2"
Area: 102 sq. ft
Counted as Living Area:
Yes

Heated: Yes
Finished: Yes
Enclosed: Yes
Contiguous:
Yes Permitted:
Yes Wet
Space: No
Addition: No
Conversion: No

17 Floor 2 - Bath



Dimensions: 4'9" x 9'9"
Area: 46 sq. ft
Counted as Living Area:
Yes

Heated: Yes
Finished: Yes
Enclosed: Yes
Contiguous:
Yes
Permitted: Yes
Wet Space: Yes
Addition: No
Conversion: No

944 Burlington Heights Drive, Burlington, Skagit
County, Washington, United States, 98233

18 Floor 2 - Garage



Dimensions: 25'0" x 20'7"
Area: 516 sq. ft
Counted as Living Area: No

Heated: No
Finished: No
Enclosed: Yes
Contiguous: Yes
Permitted: Yes
Wet Space: No
Addition: No
Conversion: No

19 Floor 2 - Porch



Dimensions: 8'1" x 12'9"
Area: 99 sq. ft
Counted as Living Area: No

Heated: No
Finished: Yes
Enclosed: No
Contiguous: Yes
Permitted: Yes
Wet Space: No
Addition: No
Conversion: No

20 Floor 2 - Dining Room



Dimensions: 11'11" x 11'5"
Area: 136 sq. ft
Counted as Living Area:
Yes

Heated: Yes
Finished: Yes
Enclosed: Yes
Contiguous:
Yes Permitted:
Yes Wet
Space: No
Addition: No
Conversion: No

944 Burlington Heights Drive, Burlington, Skagit
County, Washington, United States, 98233

21 Floor 2 - Primary Bath



Dimensions: 11'1" x 10'7"
Area: 118 sq. ft
Counted as Living Area:
Yes

Heated: Yes
Finished: Yes
Enclosed: Yes
Contiguous:
Yes
Permitted: Yes
Wet Space: Yes
Addition: No
Conversion: No

22 Floor 2 - Balcony



Dimensions: 7'8" x 23'11"
Area: 184 sq. ft
Counted as Living Area: No

Heated: No
Finished: Yes
Enclosed: No
Contiguous: Yes
Permitted: Yes
Wet Space: No
Addition: No
Conversion: No