

# Building Sketch

Borrower/Client				
Property Address 9415 Maltese Drive				
City	Gastonia	County	State NC	Zip Code 28056
Lender				

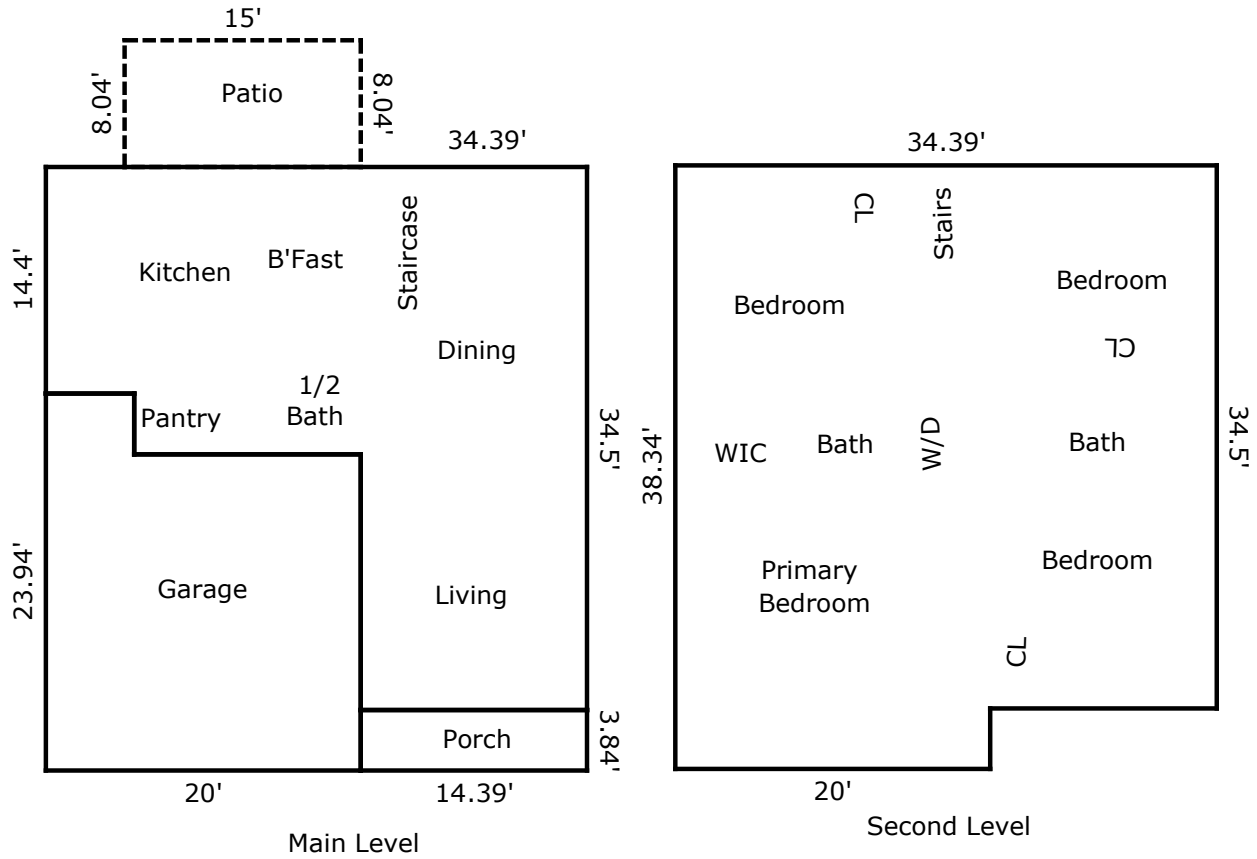

TOTAL Sketch by a la mode

### Area Calculations Summary

<b>Living Area</b>	
Main Level	1263.26 Sq ft
Main Level	840.14 Sq ft
<b>Total Living Area (Rounded):</b>	<b>2103 Sq ft</b>
<b>Non-living Area</b>	
Garage	423.11 Sq ft
Porch	55.26 Sq ft
Patio	120.6 Sq ft