

Building Sketch

Borrower/Client			
Property Address 1116 E Franklin Blvd			
City	Gastonia	County	State NC
Lender		Zip Code 28054	

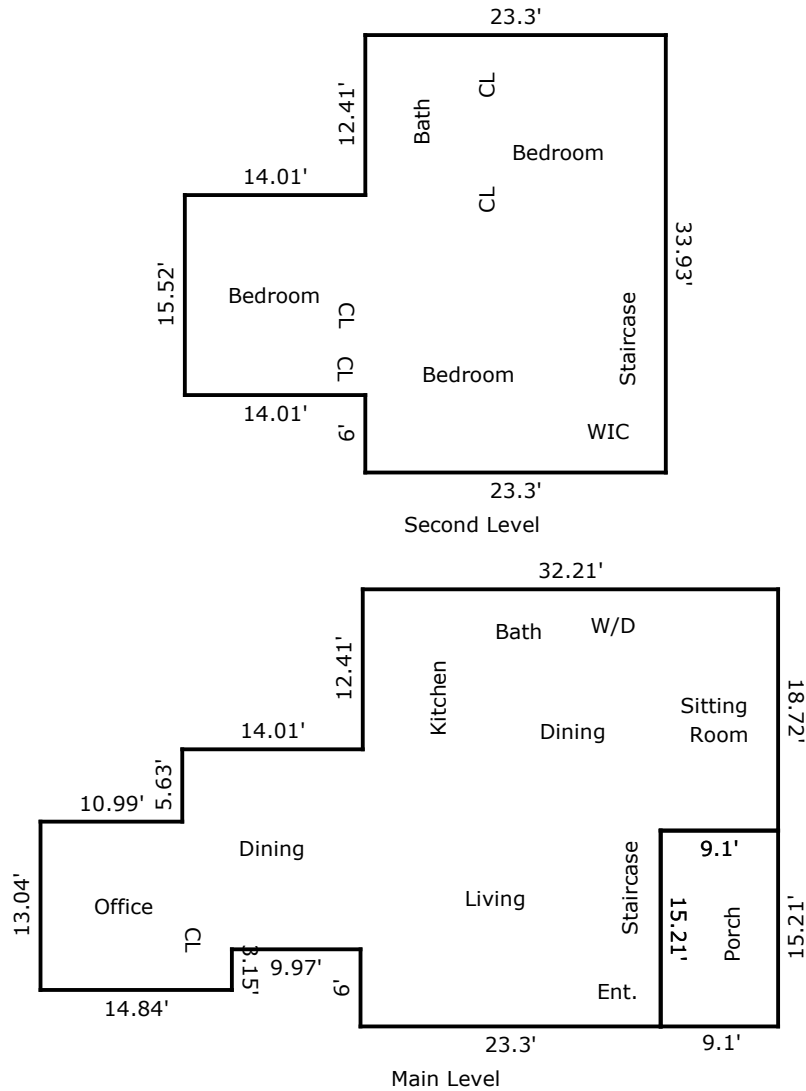

TOTAL Sketch by a la mode

Area Calculations Summary

Living Area	Area	Calculation Details
Main Living Area	1328.49 Sq ft	$13.04 \times 10.99 = 143.31$
		$18.72 \times 9.1 = 170.35$
		$33.93 \times 23.11 = 784.12$
		$14.01 \times 15.52 = 217.44$
		$3.85 \times 3.15 = 12.13$
		$0.19 \times 6 = 1.14$
Second Level	1008 Sq ft	$15.52 \times 14.01 = 217.44$ $23.3 \times 33.93 = 790.57$
Total Living Area (Rounded):	2336 Sq ft	
Non-living Area		
Porch	138.41 Sq ft	$15.21 \times 9.1 = 138.41$

Building Sketch

Borrower/Client

Property Address 1116 E Franklin Blvd

City Gastonia

County

State NC

Zip Code 28054

Lender

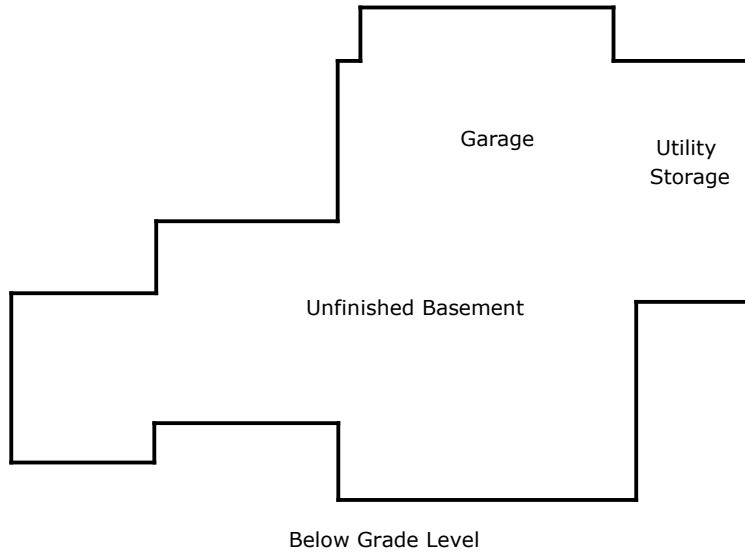

TOTAL Sketch by a la mode

Area Calculations Summary

Non-living Area

Below Grade	1408.84 Sq ft	
		$19.62 \times 4.13 = 81.03$
		$13.14 \times 11.11 = 145.99$
		$18.72 \times 9.08 = 169.98$
		$34.08 \times 23.13 = 788.27$
		$14.26 \times 10.1 = 144.03$
		$5.59 \times 14.07 = 78.65$
		$18.03 \times 0.05 = 0.9$