

## Building Sketch

Borrower/Client

Property Address 3845 Carl palmer Drive

City Harrisburg

County

State NC

Zip Code 28075

Lender

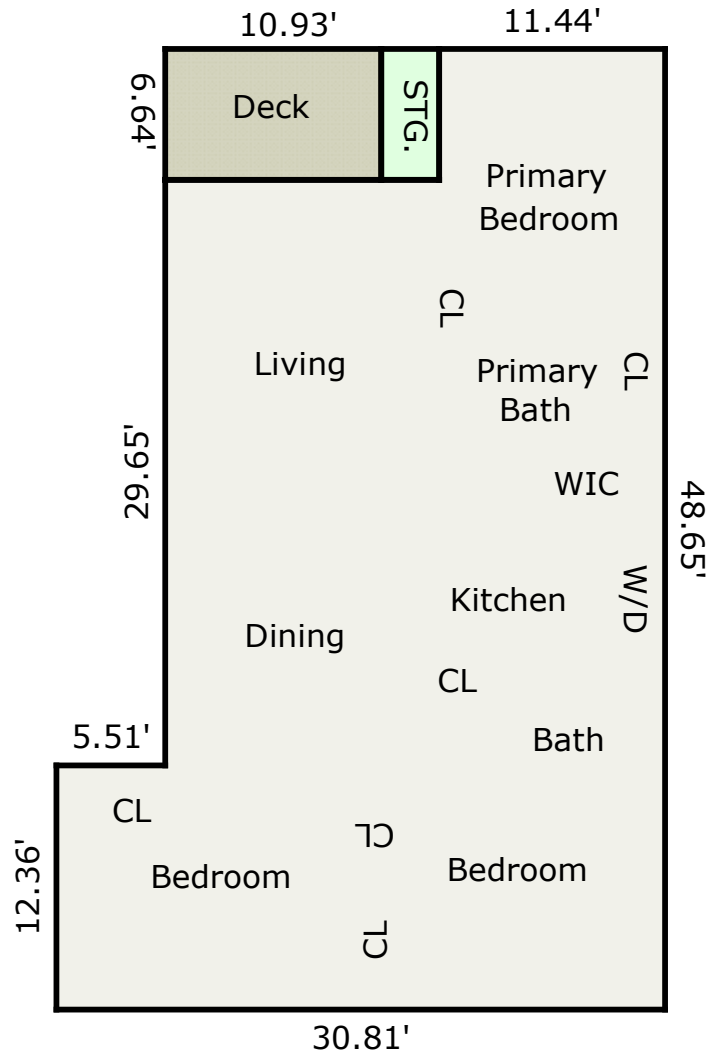

The measured square footage for this Condominium  
is calculated by interior dimensions only.

TOTAL Sketch by a la mode

### Area Calculations Summary

Living Area		Calculation Details
Main Living Area	1206.92 Sq ft	$11.44 \times 6.64 = 75.96$ $25.3 \times 29.65 = 750.14$ $30.81 \times 12.36 = 380.81$
<b>Total Living Area (Rounded):</b>		<b>1207 Sq ft</b>
Non-living Area		
Deck	72.58 Sq ft	$6.64 \times 10.93 = 72.58$
Storage	19.46 Sq ft	$6.64 \times 2.93 = 19.46$