

Building Sketch

Borrower/Client				
Property Address 185 Crystal Bay Drive				
City	Mooreville	County	State NC	Zip Code 28115
Lender				

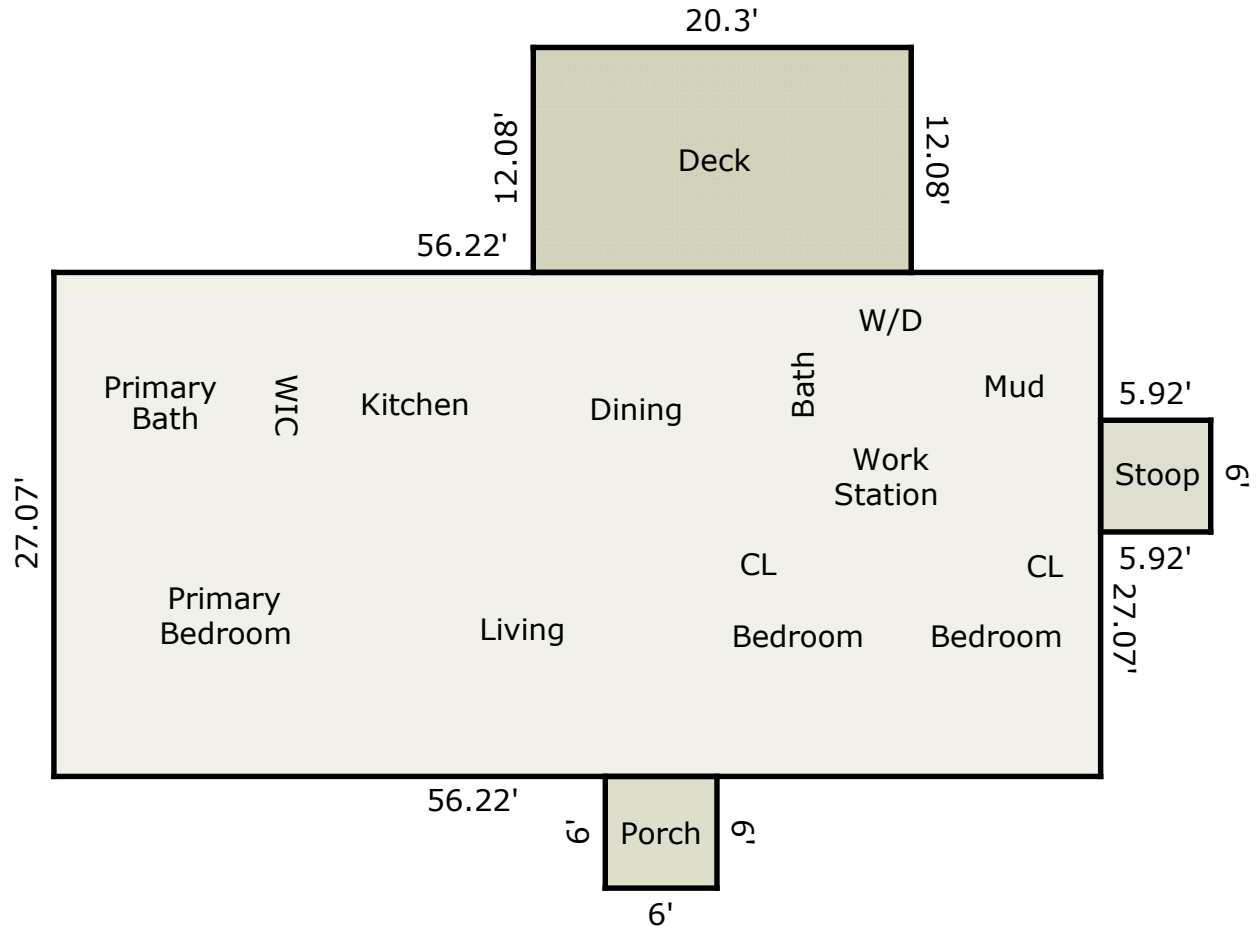

TOTAL Sketch by a la mode

Area Calculations Summary

Living Area		Calculation Details
Main Living Area	1521.88 Sq ft	$27.07 \times 56.22 = 1521.88$
Total Living Area (Rounded):		1522 Sq ft
Non-living Area		
Deck	245.22 Sq ft	$20.3 \times 12.08 = 245.22$
Stoop	35.52 Sq ft	$6 \times 5.92 = 35.52$
Porch	36 Sq ft	$6 \times 6 = 36$