



Home report

12 Country Club Lane, Belleair, Pinellas County, Florida, United States, 33756



Property summary

 **1** Garages

 **3** Bedrooms

 **2** Bathrooms

 **1** Half baths

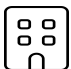
 **2** Floors

 **2,086** Gross living area sqft

 **2,844** Total sqft

Home report

12 Country Club Lane, Belleair, Pinellas County, Florida, United States, 33756



Room dimensions

Floor 1

Total sqft: 1496

Living area: 878

#		Max Dimensions	sqft	Included
1	Elevator	4'8" x 4'4"	20 sq. ft	No
2	Living Room	23'1" x 18'0"	368 sq. ft	Yes
3	W.I.C.	4'8" x 6'0"	28 sq. ft	Yes
4	Porch	13'11" x 8'5"	117 sq. ft	No
5	WC	4'4" x 8'0"	35 sq. ft	Yes
6	Garage	23'0" x 20'9"	459 sq. ft	No
7	Kitchen	18'0" x 11'9"	208 sq. ft	Yes
8	Dining Area	18'4" x 9'11"	182 sq. ft	Yes

Home report

12 Country Club Lane, Belleair, Pinellas County, Florida, United States, 33756

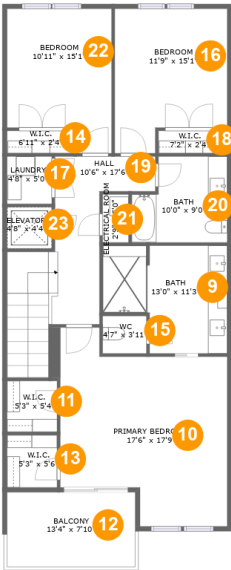

Room dimensions

Floor 2

Total sqft: 1348

Living area: 1208

#		Max Dimensions	sqft	Included
9	Bath	13'0" x 11'3"	125 sq. ft	Yes
10	Primary Bedroom	17'6" x 17'9"	293 sq. ft	Yes
11	W.I.C.	5'3" x 5'4"	28 sq. ft	Yes
12	Balcony	13'4" x 7'10"	105 sq. ft	No
13	W.I.C.	5'3" x 5'6"	29 sq. ft	Yes
14	W.I.C.	6'11" x 2'4"	16 sq. ft	Yes
15	WC	4'7" x 3'11"	18 sq. ft	Yes
16	Bedroom	11'9" x 15'1"	158 sq. ft	Yes
17	Laundry	4'8" x 5'0"	23 sq. ft	Yes
18	W.I.C.	7'2" x 2'4"	17 sq. ft	Yes
19	Hall	10'6" x 17'6"	165 sq. ft	Yes

Home report

12 Country Club Lane, Belleair, Pinellas County, Florida, United States, 33756

#		Max Dimensions	sqft	Included
20	Bath	10'0" x 9'0"	79 sq. ft	Yes
21	Electrical Room	2'9" x 5'0"	14 sq. ft	No
22	Bedroom	10'11" x 15'1"	146 sq. ft	Yes
23	Elevator	4'8" x 4'4"	20 sq. ft	No

12 Country Club Lane, Belleair, Pinellas County, Florida, United States, 33756

1 Floor 1 - Elevator



Max Dimensions: 4'8" x 4'4"
Calculated Area: 20 sq. ft
Included: No

Heated: No
Finished: No
Enclosed: Yes
Contiguous: Yes
Permitted: Yes
Wet space: No
Addition: No
Conversion: No

2 Floor 1 - Living Room



Max Dimensions: 23'1" x 18'0"
Calculated Area: 368 sq. ft
Included: Yes

Heated: Yes
Finished: Yes
Enclosed: Yes
Contiguous: Yes
Permitted: Yes
Wet space: No
Addition: No
Conversion: No

12 Country Club Lane, Belleair, Pinellas County, Florida, United States, 33756

3 Floor 1 - W.I.C.



Max Dimensions: 4'8" x 6'0"
Calculated Area: 28 sq. ft
Included: Yes

Heated: Yes
Finished: Yes
Enclosed: Yes
Contiguous: Yes
Permitted: Yes
Wet space: No
Addition: No
Conversion: No

4 Floor 1 - Porch



Max Dimensions: 13'11" x 8'5"
Calculated Area: 117 sq. ft
Included: No

Heated: No
Finished: Yes
Enclosed: No
Contiguous: Yes
Permitted: Yes
Wet space: No
Addition: No
Conversion: No

5 Floor 1 - WC



Max Dimensions: 4'4" x 8'0"
Calculated Area: 35 sq. ft
Included: Yes

Heated: Yes
Finished: Yes
Enclosed: Yes
Contiguous: Yes
Permitted: Yes
Wet space: Yes
Addition: No
Conversion: No

6 Floor 1 - Garage



Max Dimensions: 23'0" x 20'9"
Calculated Area: 459 sq. ft
Included: No

Heated: No
Finished: No
Enclosed: Yes
Contiguous: Yes
Permitted: Yes
Wet space: No
Addition: No
Conversion: No

7 Floor 1 - Kitchen



Max Dimensions: 18'0" x 11'9"
Calculated Area: 208 sq. ft
Included: Yes

Heated: Yes
Finished: Yes
Enclosed: Yes
Contiguous: Yes
Permitted: Yes
Wet space: No
Addition: No
Conversion: No

8 Floor 1 - Dining Area



Max Dimensions: 18'4" x 9'11"
Calculated Area: 182 sq. ft
Included: Yes

Heated: Yes
Finished: Yes
Enclosed: Yes
Contiguous: Yes
Permitted: Yes
Wet space: No
Addition: No
Conversion: No

12 Country Club Lane, Belleair, Pinellas County, Florida, United States, 33756

9 Floor 2 - Bath



Max Dimensions: 13'0" x 11'3"
Calculated Area: 125 sq. ft
Included: Yes

Heated: Yes
Finished: Yes
Enclosed: Yes
Contiguous: Yes
Permitted: Yes
Wet space: Yes
Addition: No
Conversion: No

10 Floor 2 - Primary Bedroom



Max Dimensions: 17'6" x 17'9"
Calculated Area: 293 sq. ft
Included: Yes

Heated: Yes
Finished: Yes
Enclosed: Yes
Contiguous: Yes
Permitted: Yes
Wet space: No
Addition: No
Conversion: No

11 Floor 2 - W.I.C.



Max Dimensions: 5'3" x 5'4"
Calculated Area: 28 sq. ft
Included: Yes

Heated: Yes
Finished: Yes
Enclosed: Yes
Contiguous: Yes
Permitted: Yes
Wet space: No
Addition: No
Conversion: No

12 Floor 2 - Balcony



Max Dimensions: 13'4" x 7'10"
Calculated Area: 105 sq. ft
Included: No

Heated: No
Finished: Yes
Enclosed: No
Contiguous: Yes
Permitted: Yes
Wet space: No
Addition: No
Conversion: No

13 Floor 2 - W.I.C.



Max Dimensions: 5'3" x 5'6"
Calculated Area: 29 sq. ft
Included: Yes

Heated: Yes
Finished: Yes
Enclosed: Yes
Contiguous: Yes
Permitted: Yes
Wet space: No
Addition: No
Conversion: No

14 Floor 2 - W.I.C.



Max Dimensions: 6'11" x 2'4"
Calculated Area: 16 sq. ft
Included: Yes

Heated: Yes
Finished: Yes
Enclosed: Yes
Contiguous: Yes
Permitted: Yes
Wet space: No
Addition: No
Conversion: No

12 Country Club Lane, Belleair, Pinellas County, Florida, United States, 33756

15 Floor 2 - WC



Max Dimensions: 4'7" x 3'11"
Calculated Area: 18 sq. ft
Included: Yes

Heated: Yes
Finished: Yes
Enclosed: Yes
Contiguous: Yes
Permitted: Yes
Wet space: Yes
Addition: No
Conversion: No

16 Floor 2 - Bedroom



Max Dimensions: 11'9" x 15'1"
Calculated Area: 158 sq. ft
Included: Yes

Heated: Yes
Finished: Yes
Enclosed: Yes
Contiguous: Yes
Permitted: Yes
Wet space: No
Addition: No
Conversion: No

17 Floor 2 - Laundry



Max Dimensions: 4'8" x 5'0"
Calculated Area: 23 sq. ft
Included: Yes

Heated: Yes
Finished: Yes
Enclosed: Yes
Contiguous: Yes
Permitted: Yes
Wet space: No
Addition: No
Conversion: No

18 Floor 2 - W.I.C.



Max Dimensions: 7'2" x 2'4"
Calculated Area: 17 sq. ft
Included: Yes

Heated: Yes
Finished: Yes
Enclosed: Yes
Contiguous: Yes
Permitted: Yes
Wet space: No
Addition: No
Conversion: No

19 Floor 2 - Hall



Max Dimensions: 10'6" x 17'6"
Calculated Area: 165 sq. ft
Included: Yes

Heated: Yes
Finished: Yes
Enclosed: Yes
Contiguous: Yes
Permitted: Yes
Wet space: No
Addition: No
Conversion: No

20 Floor 2 - Bath



Max Dimensions: 10'0" x 9'0"
Calculated Area: 79 sq. ft
Included: Yes

Heated: Yes
Finished: Yes
Enclosed: Yes
Contiguous: Yes
Permitted: Yes
Wet space: Yes
Addition: No
Conversion: No

12 Country Club Lane, Belleair, Pinellas County, Florida, United States, 33756

21 Floor 2 - Electrical Room



Max Dimensions: 2'9" x 5'0"
Calculated Area: 14 sq. ft
Included: No

Heated: No
Finished: No
Enclosed: Yes
Contiguous: Yes
Permitted: Yes
Wet space: No
Addition: No
Conversion: No

22 Floor 2 - Bedroom



Max Dimensions: 10'11" x 15'1"
Calculated Area: 146 sq. ft
Included: Yes

Heated: Yes
Finished: Yes
Enclosed: Yes
Contiguous: Yes
Permitted: Yes
Wet space: No
Addition: No
Conversion: No

23 Floor 2 - Elevator



Max Dimensions: 4'8" x 4'4"
Calculated Area: 20 sq. ft
Included: No

Heated: No
Finished: No
Enclosed: Yes
Contiguous: Yes
Permitted: Yes
Wet space: No
Addition: No
Conversion: No