

TOTAL Sketch by a la mode

Area Calculations Summary

Living Area		Calculation Details	
Main Living Area	2766.38 Sq ft	$41.31 \times 15.81 = 653.11$	
		$43.37 \times 14.2 = 615.85$	
		$25.8 \times 7.07 = 182.41$	
		$38.01 \times 31.35 = 1191.6$	
		$1.88 \times 7.91 = 14.89$	
		$4.95 \times 12.33 = 61.07$	
		$2.9 \times 14.92 = 43.31$	
		$0.5 \times 2.9 \times 2.85 = 4.14$	
Total Living Area (Rounded):	2766 Sq ft		
Non-living Area			
Deck	1521.55 Sq ft	$7.91 \times 3.07 = 24.28$	
		$56.47 \times 7.91 = 446.68$	
		$12.21 \times 7.07 = 86.35$	
		$68.02 \times 8.19 = 557.11$	
		$68.02 \times 4.91 = 333.99$	
		$15.81 \times 2.06 = 32.57$	
		$17.77 \times 2.05 = 36.43$	
		$0.5 \times 2.85 \times 2.9 = 4.14$	

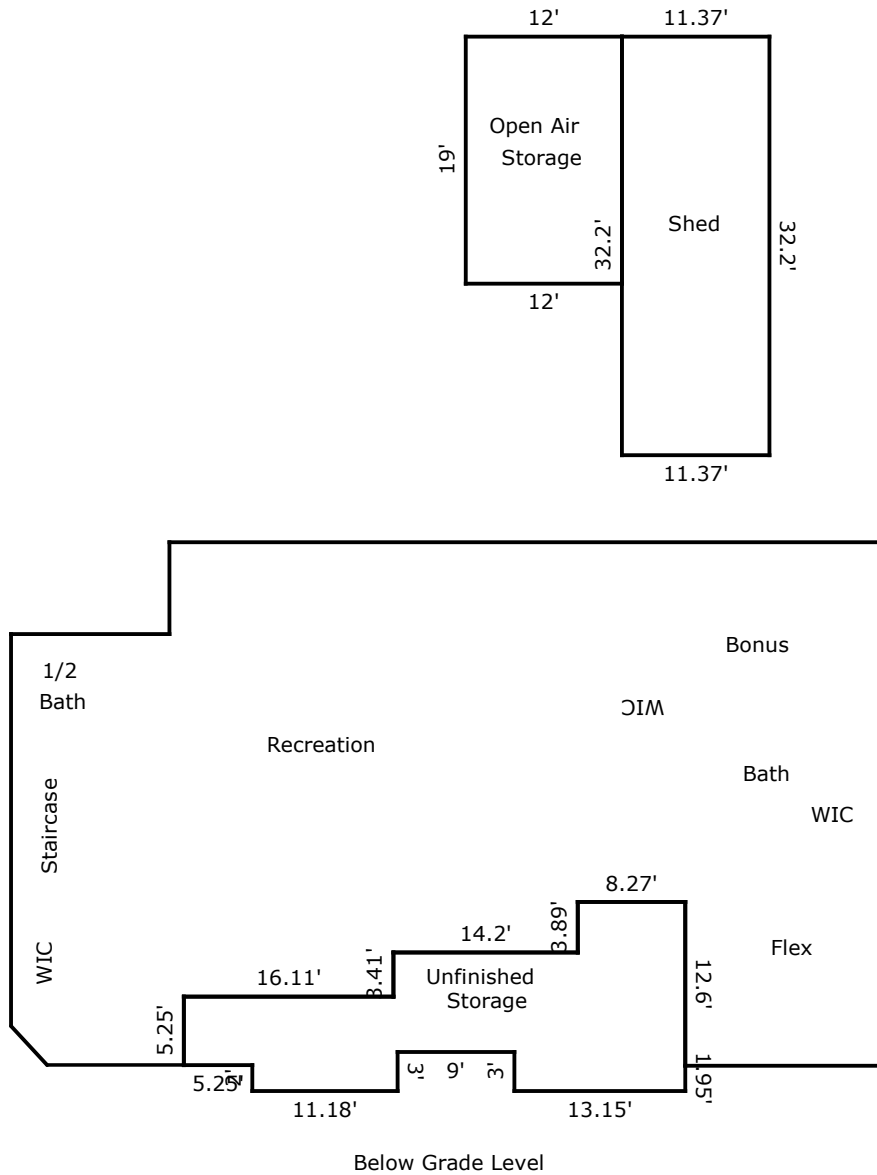

TOTAL Sketch by a la mode

Area Calculations Summary

Living Area		Calculation Details	
Below Grade	2306.18 Sq ft	$15.41 \times 12.6 = 194.17$	
		$27.67 \times 23.68 = 655.23$	
		$31.56 \times 14.2 = 448.15$	
		$34.97 \times 16.11 = 563.37$	
		$1.13 \times 7.05 = 7.97$	
		$13.31 \times 30.17 = 401.56$	
		$3 \times 10.52 = 31.56$	
		$0.5 \times 3 \times 2.79 = 4.18$	
Total Living Area (Rounded):	2306 Sq ft		
Non-living Area			
Shed	366.11 Sq ft	$32.2 \times 11.37 = 366.11$	
Storage	228 Sq ft	$19 \times 12 = 228$	
Storage	351 Sq ft	$5.25 \times 5.25 = 27.56$	
		$7.25 \times 10.86 = 78.74$	
		$14.55 \times 8.27 = 120.33$	
		$4.88 \times 3 = 14.64$	
		$7.66 \times 13.88 = 106.32$	
		$0.32 \times 10.66 = 3.41$	