

# #121-3333 Dewdney Trunk Rd

Port Moody BC V3H 2E4

Lower Level Area: 71 SQ.FT.  
Main Level Area: 620 SQ.FT.  
Upper Level Area: 590 SQ.FT.  
Total Area 1,281 SQ.FT.

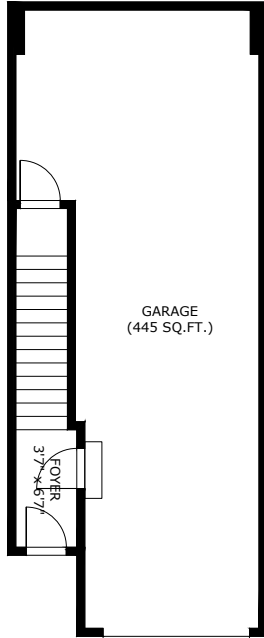

Lower Level Area:  
Ceiling Height: 8'7"

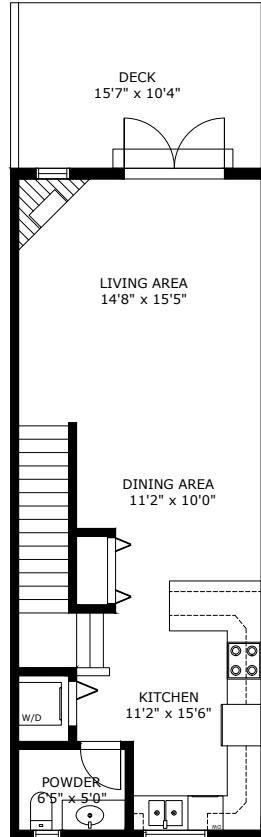

Main Level Area:  
Ceiling Height: 9'0"

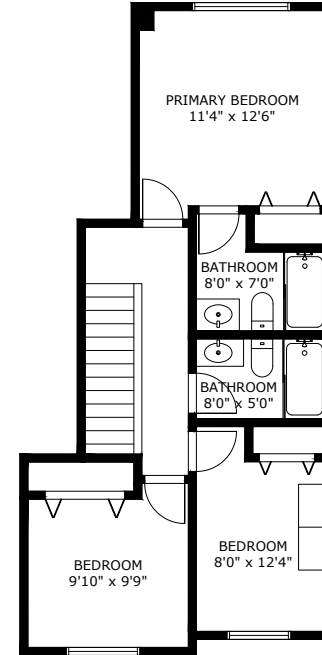

Upper Level Area:  
Ceiling Height: 8'0"

3 BEDROOMS  
3 BATHROOMS  
1,261 TOTAL SQ.FT.



604.837.8686 | email: christinetossa@gmail.com

