

810 Lake Wright Rd,3d,China Grove,North Carolina,United States, 3d

Gross Living Area: 4787 sq. ft

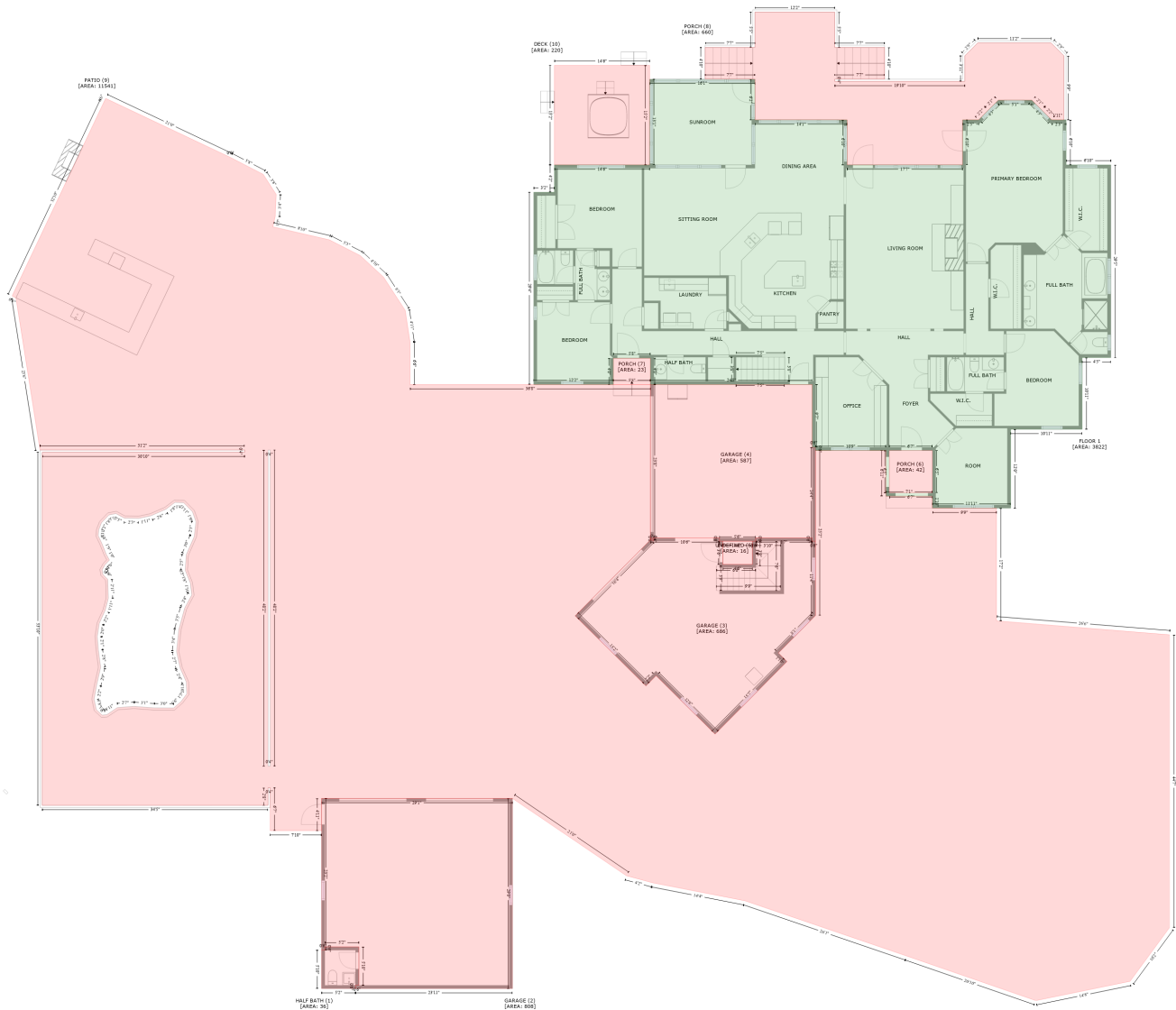

Space	Area (sq. ft)	Calculation
FLOOR 1 (Living area)	3822	Coordinate Polygon Area Algorithm using inches $-((1284.6 + 1284.6) * (339.9 - 414.3) + (1284.6 + 1453.2) * (414.3 - 414.3) + (1453.2 + 1453.2) * (414.3 - 496.7) + (1453.2 + 1664.5) * (496.7 - 496.7) + (1664.5 + 1664.5) * (496.7 - 414.3) + (1664.5 + 1693.9) * (414.3 - 414.3) + (1693.9 + 1730) * (414.3 - 378.2) + (1730 + 1791.1) * (378.2 - 378.2) + (1791.1 + 1827.2) * (378.2 - 414.3) + (1827.2 + 1853.8) * (414.3 - 414.3) + (1853.8 + 1853.8) * (414.3 - 496.7) + (1853.8 + 1935.8) * (496.7 - 496.7) + (1935.8 + 1935.8) * (496.7 - 849.2) + (1935.8 + 1883.2) * (849.2 - 849.2) + (1883.2 + 1883.2) * (849.2 - 980.4) + (1883.2 + 1752.4) * (980.4 - 980.4) + (1752.4 + 1752.4) * (980.4 - 1124.8) + (1752.4 + 1609.2) * (1124.8 - 1124.8) + (1609.2 + 1609.2) * (1124.8 - 1102.8) + (1609.2 + 1524.3) * (1102.8 - 1102.8) + (1524.3 + 1524.3) * (1102.8 - 1019.3) + (1524.3 + 1395.3) * (1019.3 - 1019.3) + (1395.3 + 1395.3) * (1019.3 - 1013.3) + (1395.3 + 1389.3) * (1013.3 - 1013.3) + (1389.3 +$

810 Lake Wright Rd,3d,China Grove,North Carolina,United States, 3d

Gross Living Area: 4787 sq. ft

Space	Area (sq. ft)	Calculation <small>Coordinate Polygon Area Algorithm using inches</small>
		$1389.3 * (1013.3 - 898.5) + (1389.3 + 1093.4) * (898.5 - 898.5) + (1093.4 + 1093.4) * (898.5 - 850.4) + (1093.4 + 1025.5) * (850.4 - 850.4) + (1025.5 + 1025.5) * (850.4 - 898.5) + (1025.5 + 879.8) * (898.5 - 898.5) + (879.8 + 879.8) * (898.5 - 546.7) + (879.8 + 917.7) * (546.7 - 546.7) + (917.7 + 917.7) * (546.7 - 496.7) + (917.7 + 1092) * (496.7 - 496.7) + (1092 + 1092) * (496.7 - 339.9) + (1092 + 1284.6) * (339.9 - 339.9) * 0.5 * 0.00694 - ((1609.2 + 1530.3) * (1019.3 - 1019.3) + (1530.3 + 1530.3) * (1019.3 - 1096.8) + (1530.3 + 1609.2) * (1096.8 - 1096.8) + (1609.2 + 1609.2) * (1096.8 - 1019.3)) * 0.5 * 0.00694$
HALF BATH (Non-living area)	36	$-((560 + 560) * (1927.4 - 1997.8) + (560 + 554) * (1997.8 - 1997.8) + (554 + 554) * (1997.8 - 2003.8) + (554 + 491.7) * (2003.8 - 2003.8) + (491.7 + 491.7) * (2003.8 - 1933.4) + (491.7 + 497.7) * (1933.4 - 1933.4) + (497.7 + 497.7) * (1933.4 - 1927.4) + (497.7 + 560) * (1927.4 - 1927.4)) * 0.5 * 0.00694$
GARAGE (Non-living area)	808	$-((841 + 841) * (1655.9 - 2003.8) + (841 + 554) * (2003.8 - 2003.8) + (554 + 554) * (2003.8 - 1997.8) + (554 + 560) * (1997.8 - 1997.8) + (560 + 560) * (1997.8 - 1927.4) + (560 + 497.7) * (1927.4 - 1927.4) + (497.7 + 497.7) * (1927.4 - 1933.4) + (497.7 + 491.7) * (1933.4 - 1933.4) + (491.7 + 491.7) * (1933.4 - 1655.9) + (491.7 + 841) * (1655.9 - 1655.9)) * 0.5 * 0.00694$
GARAGE (Non-living area)	686	$-((1219.8 + 1219.8) * (1179.2 - 1185.2) + (1219.8 + 1225.8) * (1185.2 - 1185.2) + (1225.8 + 1225.8) * (1185.2 - 1227.6) + (1225.8 + 1279.9) * (1227.6 - 1227.6) + (1279.9 + 1279.9) * (1227.6 - 1185.2) + (1279.9 + 1285.9) * (1185.2 - 1185.2) + (1285.9 + 1285.9) * (1185.2 - 1179.2) + (1285.9 + 1389.3) * (1179.2 - 1179.2) + (1389.3 + 1389.3) * (1179.2 - 1185.2) + (1389.3 + 1395.3) * (1185.2 - 1185.2) + (1395.3 + 1395.3) * (1185.2 - 1321.2) + (1395.3 + 1327.4) * (1321.2 - 1389.8) + (1327.4 + 1343.1) * (1389.8 - 1405.3) + (1343.1 + 1211.6) * (1405.3 - 1538.1) + (1211.6 + 1103.7) * (1538.1 - 1431.2) + (1103.7 + 1085.1) * (1431.2 - 1449.9) + (1085.1 + 955.7) * (1449.9 - 1321.8) + (955.7 + 1093.4) * (1321.8 - 1182.8) + (1093.4 + 1093.4) * (1182.8 - 1179.2) + (1093.4 + 1219.8) * (1179.2 - 1179.2)) * 0.5 * 0.00694$
GARAGE (Non-living area)	587	$-((1389.3 + 1389.3) * (898.5 - 1013.3) + (1389.3 + 1395.3) * (1013.3 - 1013.3) + (1395.3 + 1395.3) * (1013.3 - 1185.2) + (1395.3 + 1389.3) * (1185.2 - 1185.2) + (1389.3 + 1389.3) * (1185.2 - 1179.2) + (1389.3 + 1285.9) * (1179.2 - 1179.2) + (1285.9 + 1285.9) * (1179.2 - 1185.2) + (1285.9 + 1219.8) * (1185.2 - 1185.2) + (1219.8 + 1219.8) * (1185.2 - 1179.2) + (1219.8 + 1099.4) * (1179.2 - 1179.2) + (1099.4 + 1099.4) * (1179.2 - 1185.2) + (1099.4 + 1093.4) * (1185.2 - 1182.8) + (1093.4 + 1093.4) * (1182.8 - 898.5) + (1093.4 + 1389.3) * (898.5 - 898.5)) * 0.5 * 0.00694$
UNDEFINED (Non-living area)	16	$-((1279.9 + 1279.9) * (1185.2 - 1227.6) + (1279.9 + 1225.8) * (1227.6 - 1227.6) + (1225.8 + 1225.8) * (1227.6 - 1185.2) + (1225.8 + 1279.9) * (1185.2 - 1185.2)) * 0.5 * 0.00694$
PORCH (Non-living area)	42	$-((1609.2 + 1609.2) * (1019.3 - 1096.8) + (1609.2 + 1530.3) * (1096.8 - 1096.8) + (1530.3 + 1530.3) * (1096.8 - 1019.3) + (1530.3 + 1609.2) * (1019.3 - 1019.3)) * 0.5 * 0.00694$
PORCH (Non-living area)	23	$-((1093.4 + 1093.4) * (850.4 - 898.6) + (1093.4 + 1025.5) * (898.6 - 898.5) + (1025.5 + 1025.5) * (898.5 - 850.4) + (1025.5 + 1093.4) * (850.4 - 850.4)) * 0.5 * 0.00694$
PORCH (Non-living area)	660	$-((1430.5 + 1430.5) * (217.1 - 281.7) + (1430.5 + 1521.7) * (281.7 - 281.7) + (1521.7 + 1521.7) * (281.7 - 339.9) + (1521.7 + 1430.5) * (339.9 - 339.9) + (1430.5 + 1430.5) * (339.9 - 343.9) + (1430.5 + 1668.5) * (343.9 - 343.9) + (1668.5 + 1668.5) * (343.9 - 297.1) + (1668.5 + 1692.2) * (297.1 - 273.4) + (1692.2 + 1826.2) * (273.4 - 273.4) + (1826.2 + 1849.8) * (273.4 - 297) + (1849.8 + 1849.8) * (297 - 414.3) + (1849.8 + 1827.2) * (414.3 - 414.3) + (1827.2 + 1809.1) * (414.3 - 396.1) + (1809.1 + 1791.1) * (396.1 - 378.2) + (1791.1 + 1730) * (378.2 - 378.2) + (1730 + 1711.8) * (378.2 - 396.1) + (1711.8 + 1693.9) * (396.1 - 414.3) + (1693.9 + 1664.5) * (414.3 - 414.3) + (1664.5 + 1664.5) * (414.3 - 496.7) + (1664.5 + 1453.2) * (496.7 - 496.7) + (1453.2 + 1453.2) * (496.7 - 414.3) + (1453.2 + 1284.6) * (414.3 - 414.3) + (1284.6 + 1284.6) * (414.3 - 339.9) + (1284.6 + 1193.5) * (339.9 - 339.9) + (1193.5 + 1193.5) * (339.9 - 281.7) + (1193.5 + 1284.6) * (281.7 - 281.7) + (1284.6 + 1284.6) * (281.7 - 217.1) + (1284.6 + 1430.5) * (217.1 - 217.1)) * 0.5 * 0.00694$
PATIO (Non-living area)	11541	$-((96.7 + 324.6) * (375 - 482.8) + (324.6 + 324.7) * (482.8 - 482.8) + (324.7 + 385) * (482.8 - 514) + (385 + 408.6) * (514 - 550.6) + (408.6 + 406.8) * (550.6 - 591.1) + (406.8 + 402.6) * (591.1 - 610) + (402.6 + 506.1) * (610 - 633.8) + (506.1 + 562.4) * (633.8 - 662.6) + (562.4 + 604.9) * (662.6 - 701.8) + (604.9 + 644.7) * (701.8 - 762.8) + (644.7 + 653.5) * (762.8 - 820.8) + (653.5 + 653.5) * (820.8 - 898.5) + (653.5 + 1093.4) * (898.5 - 898.5) + (1093.4 + 1093.4) * (898.5 - 1182.8) + (1093.4 + 955.7) * (1182.8 - 1321.8) + (955.7 + 1085.1) * (1321.8 - 1449.9) + (1085.1 + 1103.7) * (1449.9 - 1431.2) + (1103.7 + 1211.6) * (1431.2 - 1538.1) + (1211.6 + 1343.1) * (1538.1 - 1405.3) + (1343.1 + 1327.4) * (1405.3 - 1389.8) + (1327.4 + 1395.3) * (1389.8 - 1321.2) + (1395.3 + 1395.3) * (1321.2 - 1019.3) + (1395.3 + 1524.3) * (1019.3 - 1019.3) + (1524.3 + 1524.3) * (1019.3 - 1102.8) + (1524.3 + 1609.2) * (1102.8 - 1102.8) + (1609.2 +$

810 Lake Wright Rd,3d,China Grove,North Carolina,United States, 3d

Gross Living Area: 4787 sq. ft

Space	Area (sq. ft)	Calculation <small>Coordinate Polygon Area Algorithm using inches</small>
		$ \begin{aligned} &1609.2) * (1102.8 - 1124.8) + (1609.2 + 1726.6) * (1124.8 - 1124.8) + (1726.6 + 1726.6) * \\ &(1124.8 - 1330.9) + (1726.6 + 2043.3) * (1330.9 - 1356.5) + (2043.3 + 2043.3) * (1356.5 - \\ &1891.8) + (2043.3 + 1970.9) * (1891.8 - 1990.5) + (1970.9 + 1798.5) * (1990.5 - 2025.8) + \\ &(1798.5 + 1562.2) * (2025.8 - 1944.2) + (1562.2 + 1266.3) * (1944.2 - 1843.1) + (1266.3 + \\ &1097.5) * (1843.1 - 1810.2) + (1097.5 + 1049.3) * (1810.2 - 1797.3) + (1049.3 + 841) * (1797.3 - \\ &1655.9) + (841 + 491.7) * (1655.9 - 1655.9) + (491.7 + 491.7) * (1655.9 - 1714.9) + (491.7 + \\ &397.8) * (1714.9 - 1714.9) + (397.8 + 397.8) * (1714.9 - 1636.3) + (397.8 + 393.8) * (1636.3 - \\ &1636.3) + (393.8 + 393.8) * (1636.3 - 1668.5) + (393.8 + -19.3) * (1668.5 - 1668.5) + (-19.3 + \\ &-19.3) * (1668.5 - 1022.4) + (-19.3 + 351) * (1022.4 - 1022.4) + (351 + 351) * (1022.4 - 1018.4) + \\ &(351 + -23.3) * (1018.4 - 1018.4) + (-23.3 + -67.3) * (1018.4 - 740.2) + (-67.3 + -74.5) * (740.2 - \\ &736.6) + (-74.5 + 94.1) * (736.6 - 380.3) + (94.1 + 96.7) * (380.3 - 375) * 0.5 * 0.00694 + -(397.8 \\ &+ 393.8) * (1018.4 - 1018.4) + (393.8 + 393.8) * (1018.4 - 1596.8) + (393.8 + 397.8) * (1596.8 - \\ &1596.8) + (397.8 + 397.8) * (1596.8 - 1018.4) * 0.5 * 0.00694 + -(223.4 + 207.3) * (1114.2 - \\ &1126.6) + (207.3 + 179.4) * (1126.6 - 1138.8) + (179.4 + 157.3) * (1138.8 - 1143.4) + (157.3 + \\ &130.8) * (1143.4 - 1142.9) + (130.8 + 115.6) * (1142.9 - 1134.7) + (115.6 + 102.7) * (1134.7 - \\ &1137.2) + (102.7 + 89) * (1137.2 - 1151.5) + (89 + 84.1) * (1151.5 - 1164.3) + (84.1 + 83.1) * \\ &(1164.3 - 1175.1) + (83.1 + 89.9) * (1175.1 - 1189.4) + (89.9 + 97.8) * (1189.4 - 1209.3) + (97.8 + \\ &103.7) * (1209.3 - 1219.8) + (103.7 + 95.4) * (1219.8 - 1228.5) + (95.4 + 90.3) * (1228.5 - 1237.5) \\ &+ (90.3 + 91.8) * (1237.5 - 1246.3) + (91.8 + 100.5) * (1246.3 - 1254.9) + (100.5 + 101.6) * \\ &(1254.9 - 1289.8) + (101.6 + 95.7) * (1289.8 - 1312) + (95.7 + 85) * (1312 - 1335.8) + (85 + 81.4) \\ &* (1335.8 - 1359.6) + (81.4 + 83.4) * (1359.6 - 1384.2) + (83.4 + 87.6) * (1384.2 - 1415.9) + (87.6 \\ &+ 80.2) * (1415.9 - 1448.5) + (80.2 + 75.5) * (1448.5 - 1474.1) + (75.5 + 79.5) * (1474.1 - 1493.2) \\ &+ (79.5 + 90.5) * (1493.2 - 1503.4) + (90.5 + 98.6) * (1503.4 - 1502.8) + (98.6 + 118.1) * (1502.8 - \\ &1489.7) + (118.1 + 148.7) * (1489.7 - 1487.5) + (148.7 + 185.4) * (1487.5 - 1490.2) + (185.4 + \\ &221) * (1490.2 - 1490.4) + (221 + 234.8) * (1490.4 - 1478.4) + (234.8 + 245.1) * (1478.4 - \\ &1464.6) + (245.1 + 244.4) * (1464.6 - 1443.1) + (244.4 + 233.1) * (1443.1 - 1417.4) + (233.1 + \\ &226.5) * (1417.4 - 1387) + (226.5 + 230.6) * (1387 - 1347.1) + (230.6 + 241.2) * (1347.1 - \\ &1307.8) + (241.2 + 254.4) * (1307.8 - 1283.4) + (254.4 + 251.6) * (1283.4 - 1261.7) + (251.6 + \\ &244.2) * (1261.7 - 1243.3) + (244.2 + 242.4) * (1243.3 - 1238.4) + (242.4 + 244.2) * (1238.4 - \\ &1209.9) + (244.2 + 258.8) * (1209.9 - 1176.7) + (258.8 + 262) * (1176.7 - 1149.6) + (262 + 255.4) \\ &* (1149.6 - 1131) + (255.4 + 239.3) * (1131 - 1114.6) + (239.3 + 223.4) * (1114.6 - 1114.2) * 0.5 \\ &* 0.00694 \end{aligned} $
DECK (Non-living area)	220	$ \begin{aligned} &-((1092 + 1092) * (314.5 - 496.7) + (1092 + 917.7) * (496.7 - 496.7) + (917.7 + 917.7) * (496.7 - \\ &314.5) + (917.7 + 1092) * (314.5 - 314.5)) * 0.5 * 0.00694 \end{aligned} $

810 Lake Wright Rd,3d,China Grove,North Carolina,United States, 3d

Gross Living Area: 4787 sq. ft

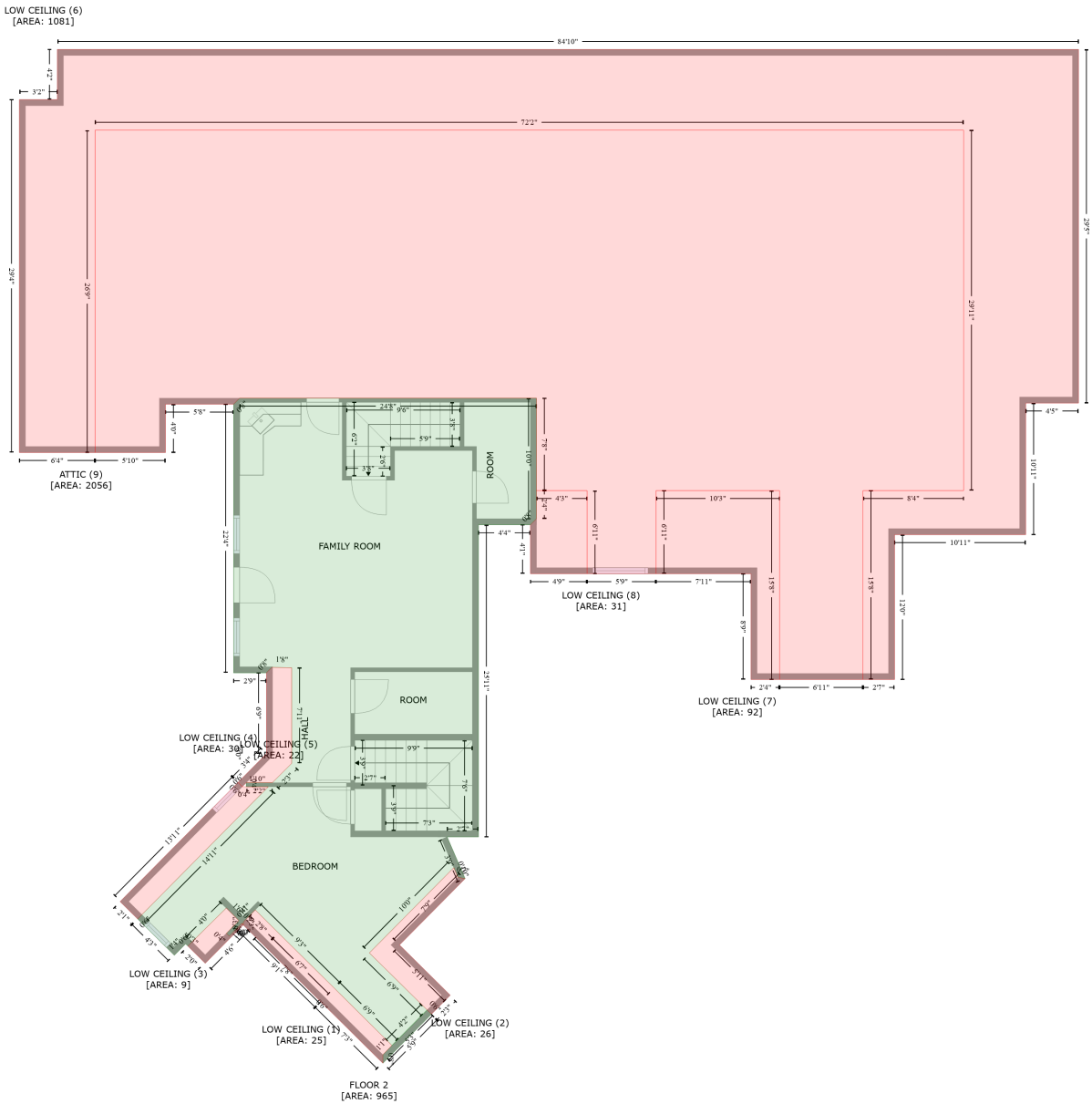

Space	Area (sq. ft)	Calculation
FLOOR 2 (Living area)	965	Coordinate Polygon Area Algorithm using inches $-((1286.4 + 1290.6) * (1454.1 - 1458.3) + (1290.6 + 1242.2) * (1458.3 - 1507.2) + (1242.2 + 1242.2) * (1507.2 - 1498.7) + (1242.2 + 1286.4) * (1498.7 - 1454.1)) * 0.5 * 0.00694 + -((1001.9 + 1002) * (1359.1 - 1359.1) + (1002 + 1128) * (1359.1 - 1231.6) + (1128 + 1106) * (1231.6 - 1231.6) + (1106 + 1106) * (1231.6 - 1227.6) + (1106 + 1131.9) * (1227.6 - 1227.6) + (1131.9 + 1151.3) * (1227.6 - 1208.3) + (1151.3 + 1151.3) * (1208.3 - 1113) + (1151.3 + 1131.5) * (1113 - 1112.6) + (1131.5 + 1126.1) * (1112.6 - 1118.1) + (1126.1 + 1093.4) * (1118.1 - 1118.1) + (1093.4 + 1093.4) * (1118.1 - 850.4) + (1093.4 + 1099.4) * (850.4 - 844.4) + (1099.4 + 1395.3) *$

810 Lake Wright Rd,3d,China Grove,North Carolina,United States, 3d

Gross Living Area: 4787 sq. ft

Space	Area (sq. ft)	Calculation
		Coordinate Polygon Area Algorithm using inches
		$(844.4 - 844.4) + (1395.3 + 1395.3) * (844.4 - 964.5) + (1395.3 + 1389.3) * (964.5 - 970.5) + (1389.3 + 1337.5) * (970.5 - 970.5) + (1337.5 + 1337.5) * (970.5 - 1281.6) + (1337.5 + 1306.3) * (1281.6 - 1281.6) + (1306.3 + 1324.2) * (1281.6 - 1323.2) + (1324.2 + 1317.1) * (1323.2 - 1321.9) + (1317.1 + 1312.9) * (1321.9 - 1312.2) + (1312.9 + 1228.7) * (1312.2 - 1397.2) + (1228.7 + 1286.2) * (1397.2 - 1453.9) + (1286.2 + 1251.2) * (1453.9 - 1489.4) + (1251.2 + 1193.7) * (1489.4 - 1432.3) + (1193.7 + 1115) * (1432.3 - 1354.4) + (1115 + 1105.7) * (1354.4 - 1363.7) + (1105.7 + 1103.2) * (1363.7 - 1366.5) + (1103.2 + 1103) * (1366.5 - 1369.3) + (1103 + 1101.6) * (1369.3 - 1367.7) + (1101.6 + 1089.1) * (1367.7 - 1380.5) + (1089.1 + 1086.2) * (1380.5 - 1377.7) + (1086.2 + 1098.6) * (1377.7 - 1365) + (1098.6 + 1086.2) * (1365 - 1352.4) + (1086.2 + 1052) * (1352.4 - 1386.2) + (1052 + 1047.8) * (1386.2 - 1390.4) + (1047.8 + 1045.6) * (1390.4 - 1388.2) + (1045.6 + 1034.3) * (1388.2 - 1399.6) + (1034.3 + 997.7) * (1399.6 - 1363.4) + (997.7 + 1001.9) * (1363.4 - 1359.1) * 0.5 * 0.00694$
LOW CEILING (Non-living area)	25	$-((1115 + 1137.8) * (1354.4 - 1377.1) + (1137.8 + 1193.7) * (1377.1 - 1432.3) + (1193.7 + 1251.2) * (1432.3 - 1489.4) + (1251.2 + 1242.2) * (1489.4 - 1498.7) + (1242.2 + 1242.2) * (1498.7 - 1507.2) + (1242.2 + 1180.4) * (1507.2 - 1446) + (1180.4 + 1103.2) * (1446 - 1369.3) + (1103.2 + 1103.2) * (1369.3 - 1366.5) + (1103.2 + 1105.7) * (1366.5 - 1363.7) + (1105.7 + 1115) * (1363.7 - 1354.4) * 0.5 * 0.00694 + -((1119.3 + 1184.6) * (1377.1 - 1441.7) + (1184.6 + 1189) * (1441.7 - 1446) + (1189 + 1119.3) * (1446 - 1377.1)) * 0.5 * 0.00694 + -((1101.6 + 1103.2) * (1367.7 - 1369.3) + (1103.2 + 1103) * (1369.3 - 1369.3) + (1103 + 1101.6) * (1369.3 - 1367.7)) * 0.5 * 0.00694$
LOW CEILING (Non-living area)	26	$-((1312.9 + 1317.1) * (1312.2 - 1321.9) + (1317.1 + 1324.2) * (1321.9 - 1323.2) + (1324.2 + 1258.8) * (1323.2 - 1389.3) + (1258.8 + 1309.4) * (1389.3 - 1439.4) + (1309.4 + 1290.6) * (1439.4 - 1458.3) + (1290.6 + 1286.4) * (1458.3 - 1454.1) + (1286.4 + 1228.7) * (1454.1 - 1397.2) + (1228.7 + 1312.9) * (1397.2 - 1312.2)) * 0.5 * 0.00694$
LOW CEILING (Non-living area)	9	$-((1086.2 + 1098.6) * (1352.4 - 1365) + (1098.6 + 1086.2) * (1365 - 1377.7) + (1086.2 + 1089.1) * (1377.7 - 1380.5) + (1089.1 + 1101.6) * (1380.5 - 1367.7) + (1101.6 + 1103) * (1367.7 - 1369.3) + (1103 + 1065.1) * (1369.3 - 1407.6) + (1065.1 + 1047.8) * (1407.6 - 1390.4) + (1047.8 + 1052) * (1390.4 - 1386.2) + (1052 + 1086.2) * (1386.2 - 1352.4) * 0.5 * 0.00694$
LOW CEILING (Non-living area)	30	$-((1097.8 + 1102) * (1227.3 - 1231.6) + (1102 + 1106) * (1231.6 - 1231.6) + (1106 + 1106) * (1231.6 - 1231.6) + (1106 + 1128) * (1231.6 - 1231.6) + (1128 + 1001.9) * (1231.6 - 1359.1) + (1001.9 + 997.7) * (1359.1 - 1363.4) + (997.7 + 980.2) * (1363.4 - 1346.1) + (980.2 + 1097.8) * (1346.1 - 1227.3)) * 0.5 * 0.00694$
LOW CEILING (Non-living area)	22	$-((1131.5 + 1151.3) * (1112.6 - 1113) + (1151.3 + 1151.3) * (1113 - 1208.3) + (1151.3 + 1131.9) * (1208.3 - 1227.6) + (1131.9 + 1106) * (1227.6 - 1227.6) + (1106 + 1102) * (1227.6 - 1231.6) + (1102 + 1097.8) * (1231.6 - 1227.3) + (1097.8 + 1126.1) * (1227.3 - 1198.7) + (1126.1 + 1126.1) * (1198.7 - 1118.1) + (1126.1 + 1131.5) * (1118.1 - 1112.6)) * 0.5 * 0.00694$
LOW CEILING (Non-living area)	1081	$-((1935.8 + 1935.8) * (496.7 - 849.2) + (1935.8 + 1883.2) * (849.2 - 849.2) + (1883.2 + 1883.2) * (849.2 - 980.4) + (1883.2 + 1752.4) * (980.4 - 980.4) + (1752.4 + 1752.4) * (980.4 - 1124.8) + (1752.4 + 1721) * (1124.8 - 1124.8) + (1721 + 1721) * (1124.8 - 936.5) + (1721 + 1821.2) * (936.5 - 936.5) + (1821.2 + 1821.2) * (936.5 - 577.2) + (1821.2 + 955.3) * (577.2 - 577.2) + (955.3 + 955.3) * (577.2 - 898.5) + (955.3 + 879.8) * (898.5 - 898.5) + (879.8 + 879.8) * (898.5 - 546.7) + (879.8 + 917.7) * (546.7 - 546.7) + (917.7 + 917.7) * (546.7 - 496.7) + (917.7 + 1935.8) * (496.7 - 496.7)) * 0.5 * 0.00694$
LOW CEILING (Non-living area)	92	$-((1637.7 + 1637.7) * (936.5 - 1124.8) + (1637.7 + 1609.2) * (1124.8 - 1124.8) + (1609.2 + 1609.2) * (1124.8 - 1019.3) + (1609.2 + 1514.6) * (1019.3 - 1019.3) + (1514.6 + 1514.6) * (1019.3 - 936.5) + (1514.6 + 1637.7) * (936.5 - 936.5)) * 0.5 * 0.00694$
LOW CEILING (Non-living area)	31	$-((1445.8 + 1445.8) * (936.5 - 1019.3) + (1445.8 + 1389.3) * (1019.3 - 1019.3) + (1389.3 + 1389.3) * (1019.3 - 970.5) + (1389.3 + 1395.3) * (970.5 - 964.5) + (1395.3 + 1395.3) * (964.5 - 936.5) + (1395.3 + 1445.8) * (936.5 - 936.5)) * 0.5 * 0.00694$
ATTIC (Non-living area)	2056	$-((1821.2 + 1821.2) * (577.2 - 936.5) + (1821.2 + 1721) * (936.5 - 936.5) + (1721 + 1721) * (936.5 - 1124.8) + (1721 + 1637.7) * (1124.8 - 1124.8) + (1637.7 + 1637.7) * (1124.8 - 936.5) + (1637.7 + 1514.6) * (936.5 - 936.5) + (1514.6 + 1514.6) * (936.5 - 1019.3) + (1514.6 + 1445.8) * (1019.3 - 1019.3) + (1445.8 + 1445.8) * (1019.3 - 936.5) + (1445.8 + 1395.3) * (936.5 - 936.5) + (1395.3 + 1395.3) * (936.5 - 844.4) + (1395.3 + 1099.4) * (844.4 - 844.4) + (1099.4 + 1093.4) * (844.4 - 850.4) + (1093.4 + 1025.5) * (850.4 - 850.4) + (1025.5 + 1025.5) * (850.4 - 898.5) + (1025.5 + 955.3) * (898.5 - 898.5) + (955.3 + 955.3) * (898.5 - 577.2) + (955.3 + 1821.2) * (577.2 - 577.2)) * 0.5 * 0.00694$