

Building Sketch

Borrower/Client			
Property Address 123 Foster Glen Place			
City Mooresville	County	State NC	Zip Code 28115
Lender			

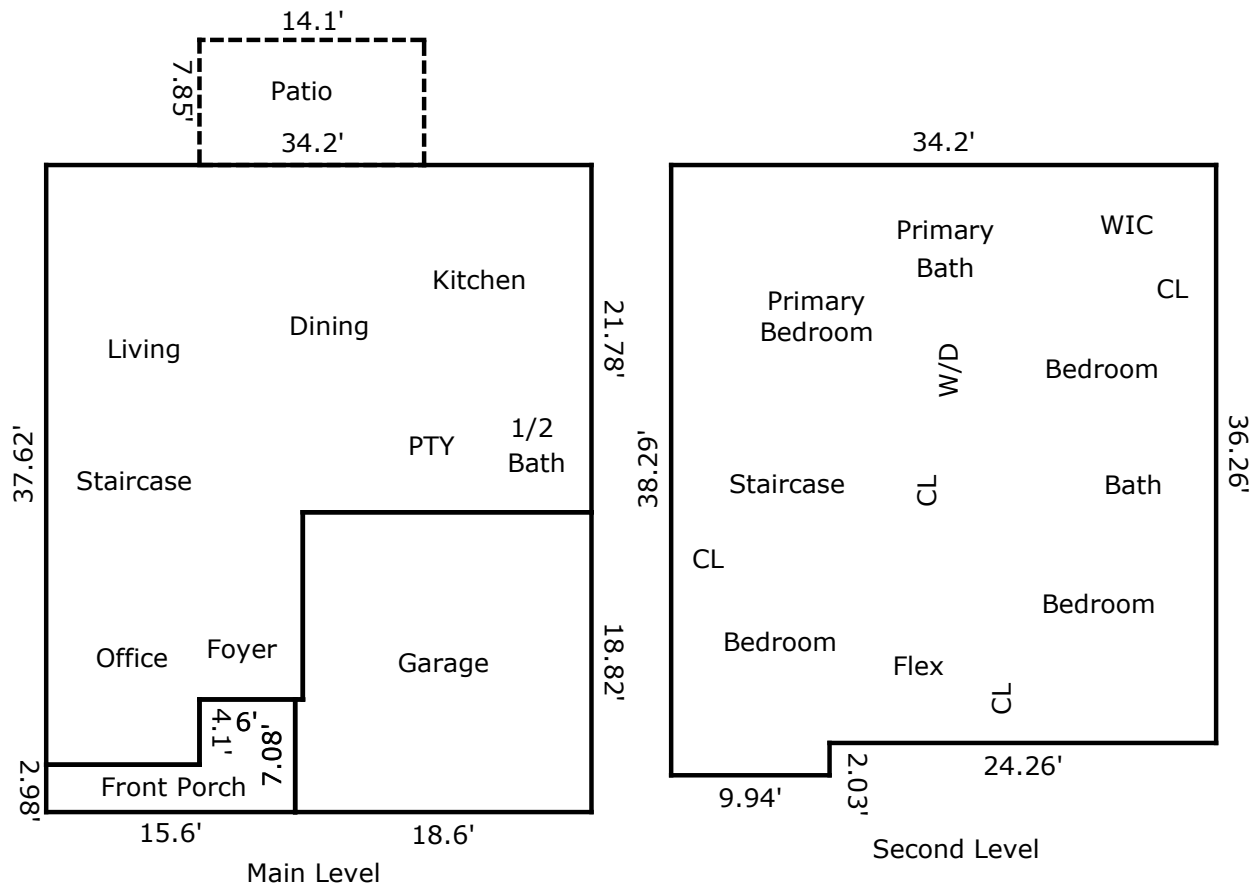

TOTAL Sketch by a la mode

Area Calculations Summary

Living Area	Calculation Details	
Main Living Area	973.25 Sq ft	21.78 × 18.1 = 394.22 16.1 × 33.52 = 539.67 4.1 × 9.6 = 39.36
Second Level	1260.27 Sq ft	34.2 × 36.26 = 1240.09 2.03 × 9.94 = 20.18
Total Living Area (Rounded):	2234 Sq ft	
Non-living Area		
Garage	344.18 Sq ft	18.82 × 18.1 = 340.64 0.5 × 7.08 = 3.54
Patio	110.68 Sq ft	14.1 × 7.85 = 110.68
Porch	71.09 Sq ft	7.08 × 6 = 42.48 9.6 × 2.98 = 28.61