

Massachusetts Cultural Resource Information System

Scanned Record Cover Page

Inventory No:	SBR.327
Historic Name:	Dando, Thomas J. House
Common Name:	
Address:	157 Parkerville Rd
City/Town:	Southborough
Village/Neighborhood:	
Local No:	19-10;
Year Constructed:	C 1936
Architectural Style(s):	No style;
Architect(s):	Dando, Thomas J.;
Use(s):	Single Family Dwelling House;
Significance:	Architecture;
Area(s):	
Designation(s):	
Building Materials:	Roof: Asphalt Shingle; Wall: Stone, Uncut; Wood; Wood Shingle; Foundation: Stone, Uncut;
Demolished	No



The Massachusetts Historical Commission (MHC) has converted this paper record to digital format as part of ongoing projects to scan records of the Inventory of Historic Assets of the Commonwealth and National Register of Historic Places nominations for Massachusetts. Efforts are ongoing and not all inventory or National Register records related to this resource may be available in digital format at this time.

The MACRIS database and scanned files are highly dynamic; new information is added daily and both database records and related scanned files may be updated as new information is incorporated into MHC files. Users should note that there may be a considerable lag time between the receipt of new or updated records by MHC and the appearance of related information in MACRIS. Users should also note that not all source materials for the MACRIS database are made available as scanned images. Users may consult the records, files and maps available in MHC's public research area at its offices at the State Archives Building, 220 Morrissey Boulevard, Boston, open M-F, 9-5.

Users of this digital material acknowledge that they have read and understood the MACRIS Information and Disclaimer (<http://mhc-macris.net/macrisdisclaimer.htm>)

Data available via the MACRIS web interface, and associated scanned files are for information purposes only. THE ACT OF CHECKING THIS DATABASE AND ASSOCIATED SCANNED FILES DOES NOT SUBSTITUTE FOR COMPLIANCE WITH APPLICABLE LOCAL, STATE OR FEDERAL LAWS AND REGULATIONS. IF YOU ARE REPRESENTING A DEVELOPER AND/OR A PROPOSED PROJECT THAT WILL REQUIRE A PERMIT, LICENSE OR FUNDING FROM ANY STATE OR FEDERAL AGENCY YOU MUST SUBMIT A PROJECT NOTIFICATION FORM TO MHC FOR MHC'S REVIEW AND COMMENT. You can obtain a copy of a PNF through the MHC web site (www.sec.state.ma.us/mhc) under the subject heading "MHC Forms."

Commonwealth of Massachusetts
Massachusetts Historical Commission
220 Morrissey Boulevard, Boston, Massachusetts 02125
www.sec.state.ma.us/mhc

This file was accessed on: Monday, April 28, 2025 at 9:15 PM

FORM B – BUILDING

MASSACHUSETTS HISTORICAL COMMISSION
MASSACHUSETTS ARCHIVES BUILDING
220 MORRISSEY BOULEVARD
BOSTON, MASSACHUSETTS 02125

Assessor's Number USGS Quad Area(s) Form Number

19-10 Marlboro 327

Town SOUTHBOROUGH

Place (neighborhood or village)

157 Parkerville Road

Name Eleanor and Thomas J. Dando House

Present residential

Original residential

Construction ca. 1936

deed and assessors reports

Form side gable cottage

Architect/Builder Thomas J. Dando (designer and builder)

Primary Material:

Foundation stone

Wall/Trim stone / wood shingles

Roof wood shingles

Outbuildings/Secondary Structures ca. 1945 one-car stone and shingle garage, ca. 1936 dilapidated sunken greenhouse, ca. 1950 two-car stone garage (MHC #328).

Major Alterations (with dates) none

Condition good

Moved ☒ no ☐ yes Date

Acres 1.86 acres

Setting Rural main route connecting Southville with Turnpike Road and Southborough Center. Near abutments of former trolley route that crossed over Parkerville Road, just north of property. Wooded area surrounding property, scattered mid 20th century residential development.

Sketch Map

Draw a map showing the building's location in relation to the nearest cross streets and/or major natural features. Show all buildings between inventoried building and nearest intersection or natural feature. Label streets including route numbers, if any. Circle and number the inventoried building. Indicate north.

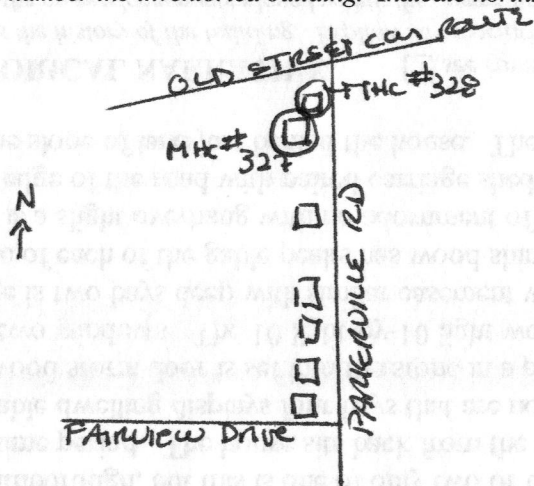

Recorded by Schuler/Forbes

Organization Southborough Historical Commission

Date (month / year) 4/00

RECEIVED

JUL 03 2000

Follow Massachusetts Historical Commission Survey Manual instructions for completing this form.

MASS. HIST. COMM

BUILDING FORM

ARCHITECTURAL DESCRIPTION

☐ see continuation sheet*Describe architectural features. Evaluate the characteristics of this building in terms of other buildings within the community.*

Situated on the west side of a main road connecting Southville with Southborough north of the old toll road, now Route 9, this stone cottage is unique for its use of materials. There are a few other important stone houses in Southborough, but this is one of only two or three modest cottages built of stone from the area in this later ca. 1936 time period. The house sits back from the road raised slightly on a terrace with stone retaining wall. The side gable dwelling displays four bays that are not symmetrically placed on the main facade. The paneled door with wood storm door is set into the stone in a plain wood frame. On one side is a single window and on the other two windows. The 10 light-by-10 light wood casement windows also are set into the stone facade. The cottage is two bays deep with similar casement windows and one smaller window in the gable peaks. The wall surface of each of the gable peaks has wood shingled sheathing. The stone chimney is centered on the ridge. There is a slight overhang with no adornment of the eave edges of the roof. The stone garage (**MHC #328**) built at the edge of the road with paired carriage shed doors was constructed to replace the tiny one-car garage built into the slope of land just behind the house. The new stone garage was built ca. 1950.

HISTORICAL NARRATIVE

☐ see continuation sheet*Discuss the history of the building. Explain its associations with local (or state) history. Include uses of the building, and the role(s) the owners/occupants played within the community.*

Parkerville Road was the main connection from Southville north to the old toll road and Southborough Center from the early 1800s. Scattered farmsteads dotted the landscape with at least three Ward properties on Parkerville, Gilmore and Middle Roads just south of this property. The land for this property was part of the early twentieth century John A. Flanders farm and was that part called the Braithwait land for which Flanders, a farmer, was assessed. Throughout the 1920s he was assessed for 17 acres, 34,573 square feet and in 1936 he was assessed for 16 acres, 20,383 square feet after he and his wife Kristinia Flanders had given this 1 acre, 14,190 square feet to their niece, **Eleanor Dando**, and her husband, **Thomas Dando**. Thomas Dando built this house for his wife using local stone and his own design to be similar to stone houses in Strathaven, Scotland where he had been raised. He started with the north end of the house and ended with the garages. In 1941 Eleanor Dando was assessed for the house and greenhouse and by 1947 the tiny one-car garage had been added at the end of the dirt driveway and built into the slope of the land. In the early 1950s Dando built the two-car garage with the help of his son in anticipation of needing additional space for his son's car after college. In the late 1940s Dando purchased some of the adjacent land from the **Boston & Worcester Street Railway**, the **abutments (MHC #937)** of which remain just north of this property at the former Parkerville Road crossing as evidence of this early twentieth century mode of transportation. Only scattered residential development occurred until the mid 1900s so that this is one of the few examples of construction from the 1920s to the 1950s in the southern part of Southborough and it is the only stone building from that period. Today much of the farm land along Parkerville Road has been subdivided into small house lots with large 1990s and 2000 new housing.

BIBLIOGRAPHY and/or REFERENCES

☐ see continuation sheet

Assessors Reports: 1909, 1915, 1921, 1927, 1936, 1941, 1947

Noble, Richard. Fences of Stone, 1990.

Oral History. Ann Dando Leavitt, daughter of owner/builder.

Worcester Registry of Deeds: Plan Book 1852/Page 583 - Plan of Land in Southville, Mass. owned by Eleanor Dando, April 1935, J. Francis Granger, CE

☒ Recommended for listing in the National Register of Historic Places. *If checked, you must attach a completed National Register Criteria Statement form.*

MASSACHUSETTS HISTORICAL COMMISSION
MASSACHUSETTS ARCHIVES BUILDING
220 MORRISSEY BOULEVARD
BOSTON, MASSACHUSETTS 02125

Community Property Address
SOUTHBOROUGH 157 PARKERVILLE RD.

Area(s) Form No.

	327
--	-----

National Register of Historic Places Criteria Statement Form

Check all that apply:

- ☒ Individually eligible ☐ Eligible **only** in a historic district
☐ Contributing to a potential historic district ☐ Potential historic district

Criteria: ☒ A ☐ B ☒ C ☐ D

Criteria Considerations: ☐ A ☐ B ☐ C ☐ D ☐ E ☐ F ☐ G

Statement of Significance by Schuler/Forbes, Consultants
The criteria that are checked in the above sections must be justified here.

The Eleanor and Thomas J. Dando House is eligible for listing on the National Register as a somewhat unique local unaltered example of 1930s stone construction using local materials and representing a Scotsman's introduction of his cultural roots by designing and building a house and accompanying outbuildings to resemble dwellings of his homeland. The property retains integrity of location, design, setting, materials, workmanship, association and feeling.