

Building Sketch

Borrower/Client			
Property Address 8010 Cottsbroke Drive			
City	Huntersville	County	State NC Zip Code 28078
Lender			

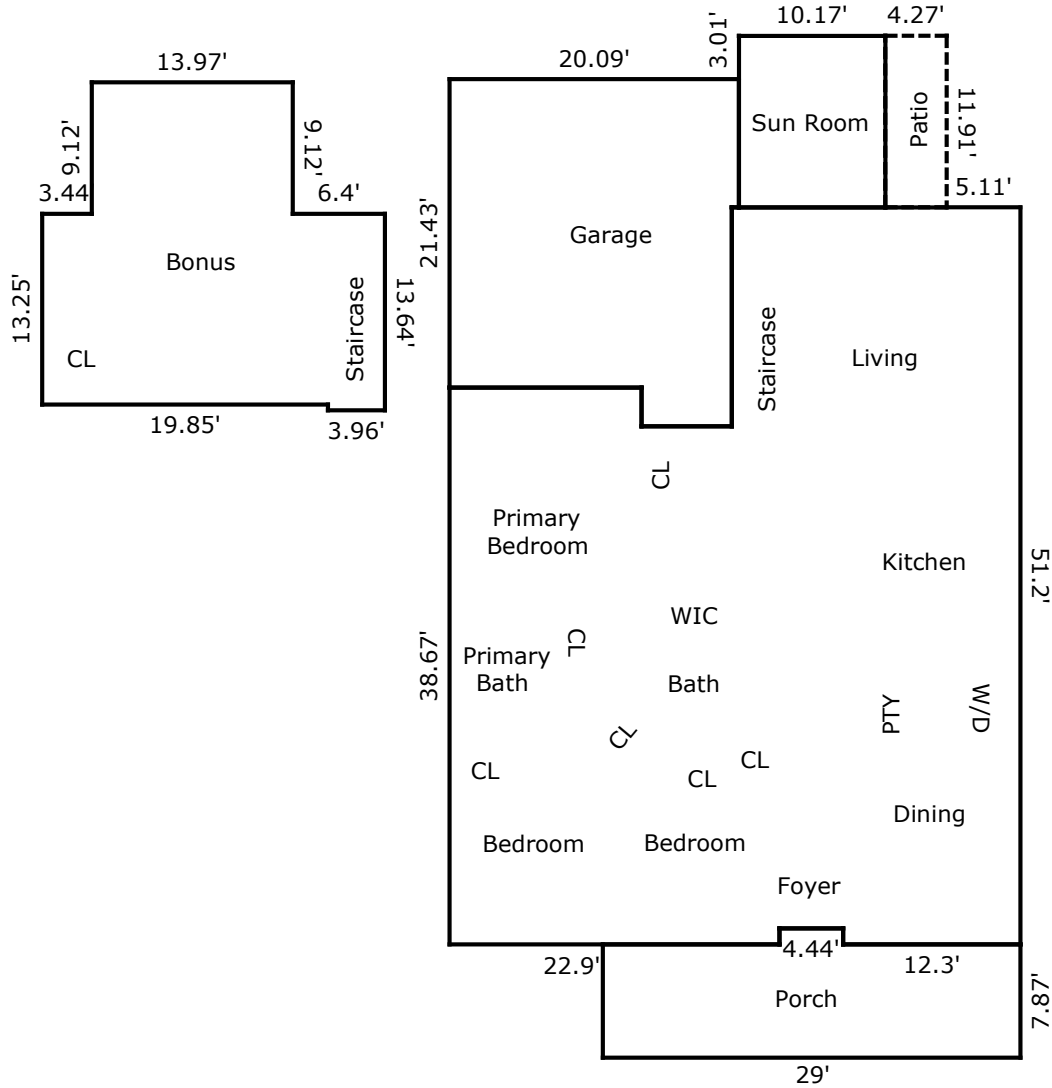

TOTAL Sketch by a la mode

Area Calculations Summary

Living Area	
Main Level	1762.44 Sq ft
Second Floor	444.43 Sq ft
Total Living Area (Rounded):	2207 Sq ft
Non-living Area	
Garage	441 Sq ft
Patio	50.86 Sq ft
Porch	233.16 Sq ft
Sunroom	121.12 Sq ft