

Building Sketch

Borrower/Client

Property Address 605 Heatherwood Drive

City Monroe

County

State NC

Zip Code 28112

Lender

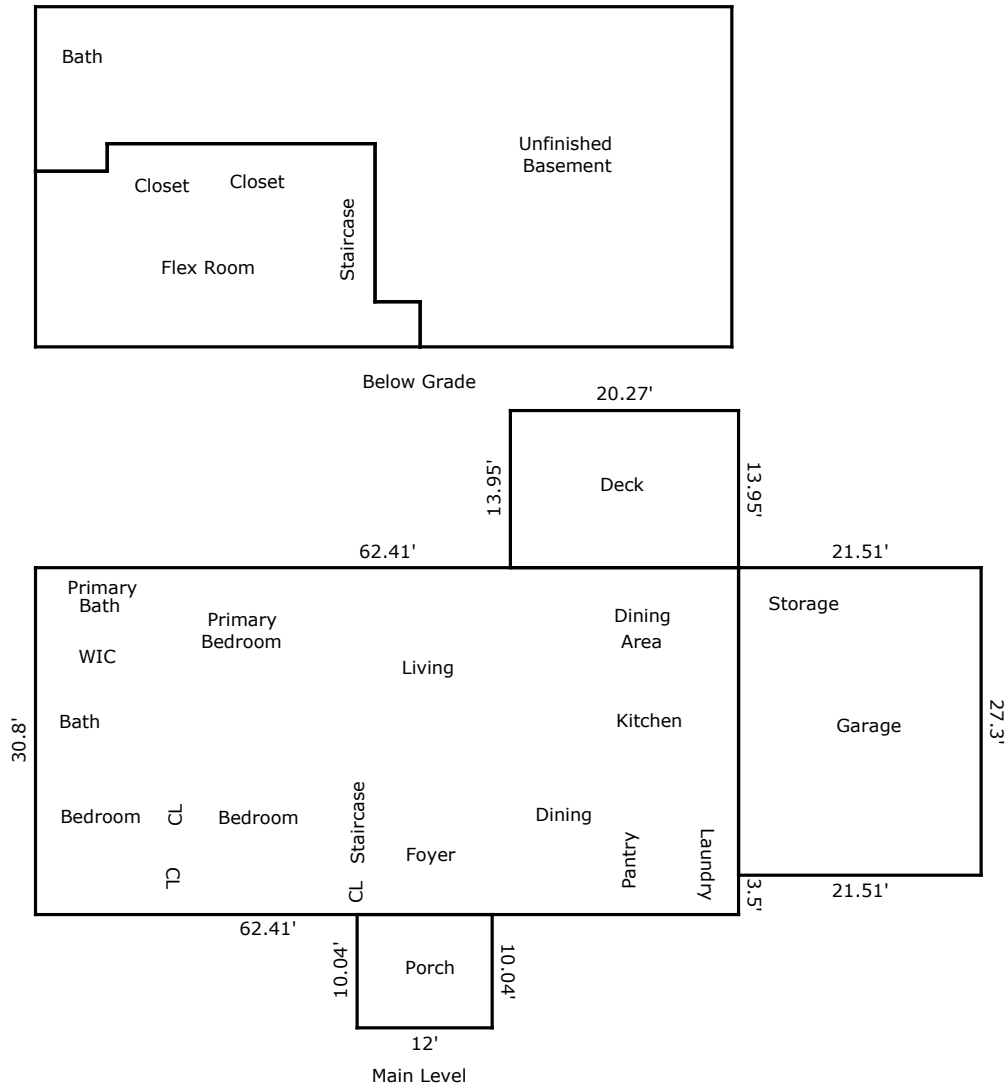

TOTAL Sketch by a la mode

Area Calculations Summary

| Living Area | |
|-------------------------------------|-------------------|
| Main Level | 1922.23 Sq ft |
| Below Grade | 543.59 Sq ft |
| Total Living Area (Rounded): | 2466 Sq ft |
| Non-living Area | |
| Porch | 120.48 Sq ft |
| Deck | 282.77 Sq ft |
| Garage | 587.22 Sq ft |
| Below Grade | 1322.77 Sq ft |