

FLOORPLAN SKETCH

Borrower: _____ File No.: 16677
 Property Address: 14009 Island Dr _____ Case No.: _____
 City: Huntersville _____ State: NC _____ Zip: 28078
 Lender: _____

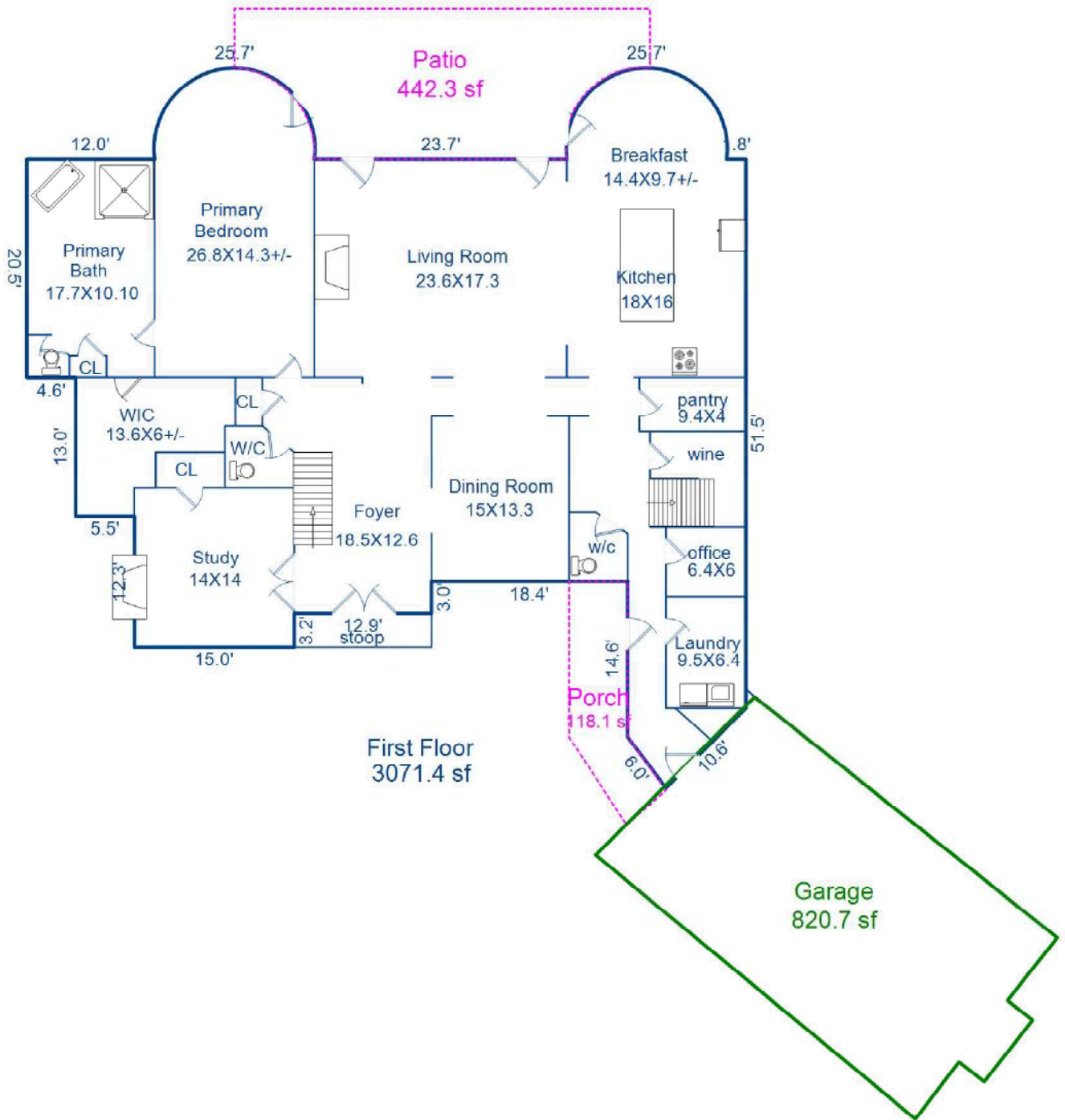

Sketch by ApexSketch

AREA CALCULATIONS SUMMARY						AREA CALCULATIONS BREAKDOWN				
Code	Description	Factor	Net Size	Perimeter	Net Totals	Name	Base x	Height x	Width =	Area
GLA1	First Floor	1.0	3071.4	280.1	3071.4	First Floor	0.5 x	8.4 x	4.8 =	20.2
GAR	Garage	1.0	820.7	123.8	820.7		0.5 x	3.8 x	1.9 =	3.6
P/P	Porch	1.0	118.1	55.7				8.4 x	2.7 =	22.7
	Patio	1.0	442.3	99.8	560.5			42.6 x	27.9 =	1188.5
								15.0 x	3.2 =	48.0
								39.6 x	29.5 =	1168.2
								33.5 x	5.5 =	184.3
								11.9 x	11.1 =	132.1
								20.5 x	4.6 =	94.3
							Curve	15.0 @	195° =	104.8
							Curve	15.0 @	195° =	104.8
	Net LIVABLE	cnt	1 (rounded)		3,071	11 total items			(rounded)	3,071

FLOORPLAN SKETCH

Borrower:	File No.: 16677
Property Address: 14009 Island Dr	Case No.:
City: Huntersville	State: NC
Lender:	Zip: 28078

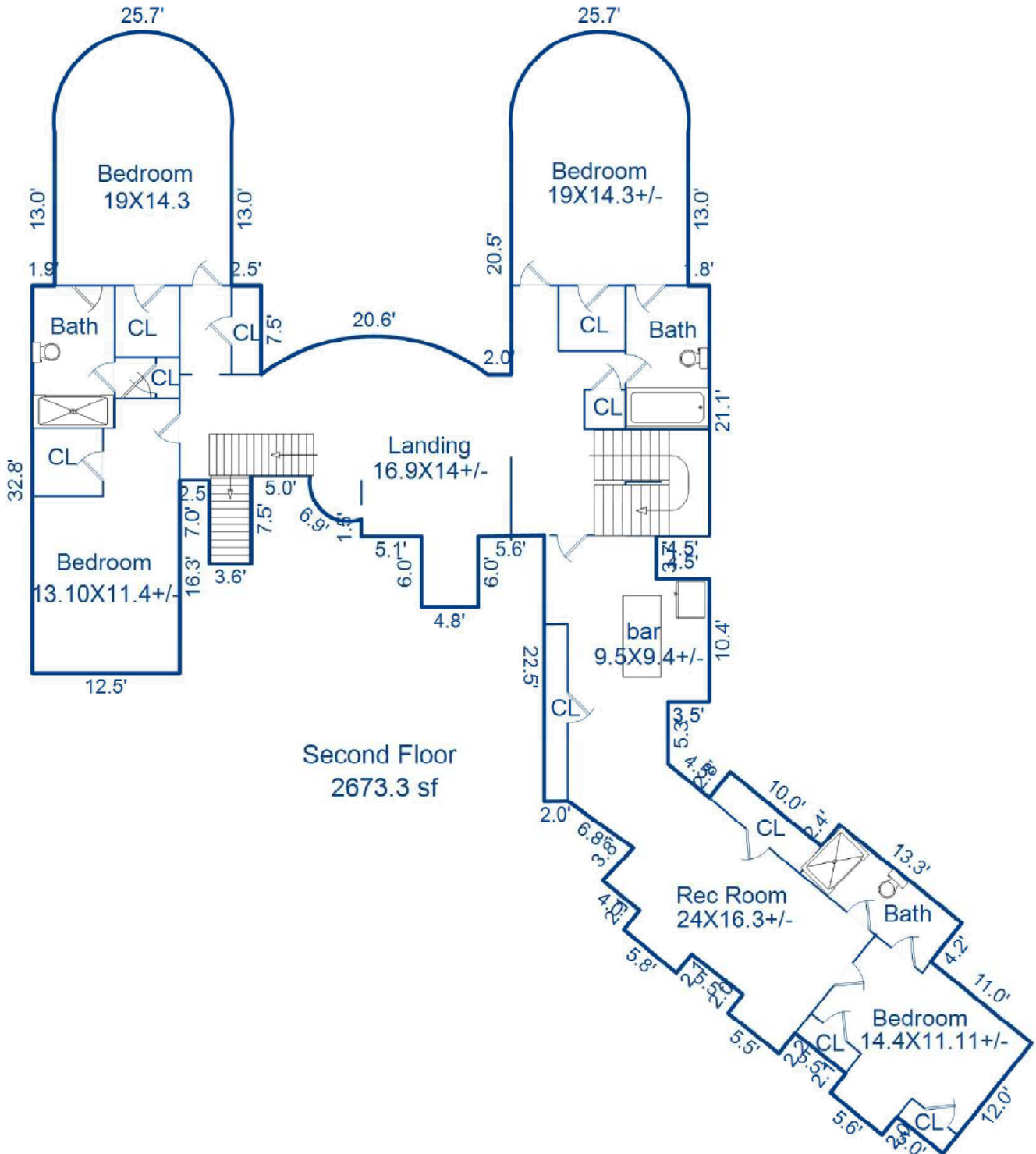

Second Floor
2673.3 sf

Sketch by ApexSketch

AREA CALCULATIONS SUMMARY					AREA CALCULATIONS BREAKDOWN					
Code	Description	Factor	Net Size	Perimeter	Net Totals	Name	Base x	Height x	Width =	Area
GLA2	Second Floor	1.0	2673.3	468.2	2673.3	Second Floor		15.0 x	13.0 =	195.0
								6.0 x	4.8 =	28.8
							0.5 x	5.6 x	0.1 =	0.3
								34.1 x	15.0 =	511.5
								13.6 x	2.0 =	27.2
								21.1 x	1.8 =	38.0
								13.6 x	0.8 =	10.9
								18.6 x	16.5 =	306.1
								7.0 x	3.6 =	25.2
								16.3 x	12.5 =	204.2
								16.0 x	0.8 =	13.0
								14.2 x	8.5 =	121.0
							0.5 x	5.7 x	2.8 =	8.0
								9.9 x	5.2 =	51.5
								8.5 x	4.2 =	35.4
								12.0 x	5.0 =	60.0
	Net LIVABLE	cnt	1 (rounded)		2,673	54 addl items			(rounded)	2,673
						70 total items				

