

Main Building: Total Exterior Area Above Grade 1688.00 sq ft

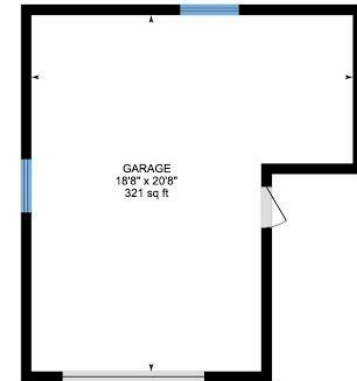

Main Floor  
Exterior Area 1637.18 sq ft



Garage  
Exterior Area 50.82 sq ft



White regions are excluded from total floor area in iGUIDE floor plans. All room dimensions and floor areas must be considered approximate and are subject to independent verification.



PREPARED: May 2021



Garage Total Exterior Area 50.82 sq ft

HomeSmart Realty Pros

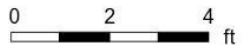
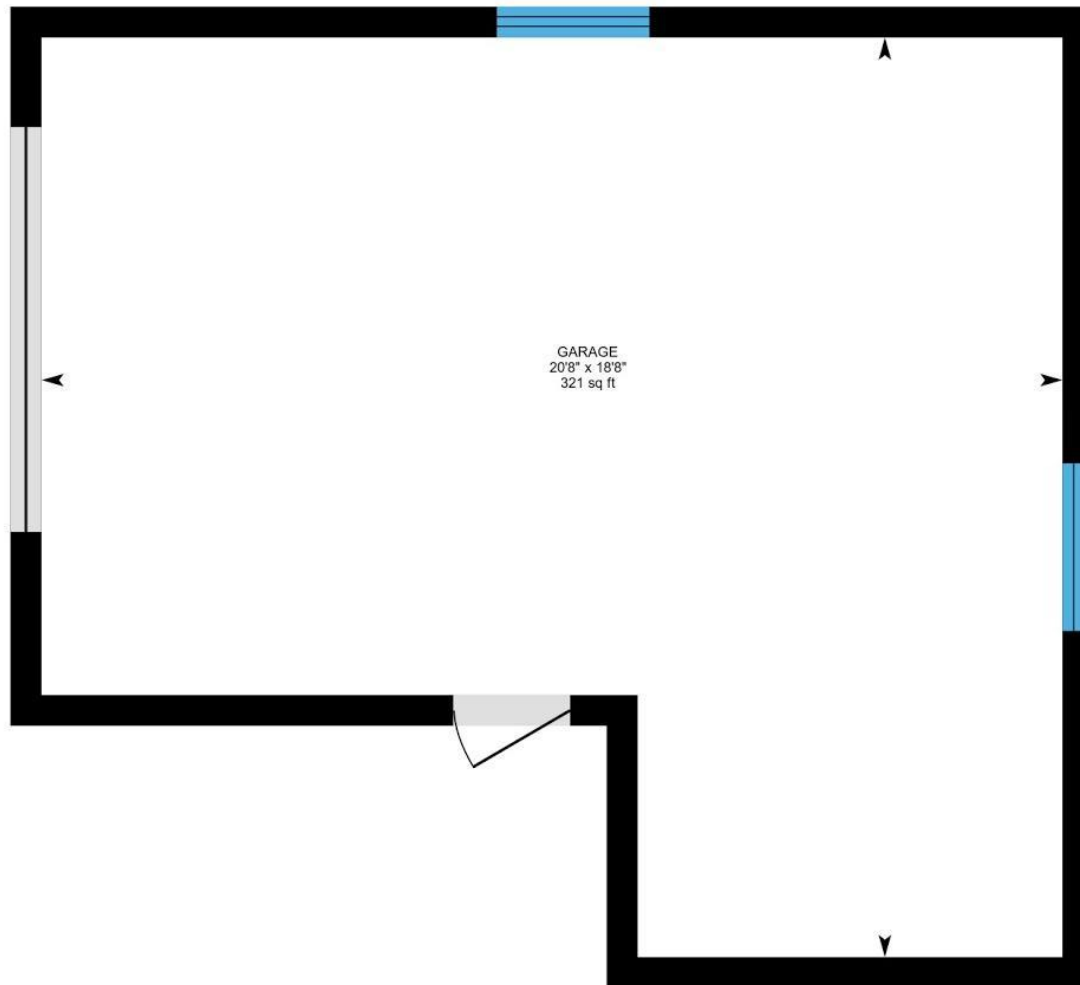

PREPARED: May 2021



## Property Details

HomeSmart Realty Pros

### Room Measurements

Only major rooms are listed. Some listed rooms may be excluded from total interior floor area (e.g. garage). Room dimensions are largest length and width; parts of room may be smaller. Room area is not always equal to product of length and width.

#### MAIN FLOOR

Bath: 8'5" x 4'11" (8.4' x 4.9') | 41 sq ft

Bath: 3'11" x 4'6" (3.9' x 4.5') | 18 sq ft

Bedroom: 14'1" x 10' (14.1' x 10') | 123 sq ft

Bedroom: 12' x 10'11" (12' x 10.9') | 131 sq ft

Dining: 12'3" x 10' (12.3' x 10') | 122 sq ft

Family: 10'10" x 19'11" (10.9' x 19.9') | 217 sq ft

Kitchen: 8'6" x 16' (8.5' x 16') | 136 sq ft

Laundry: 11'1" x 4'5" (11.1' x 4.4') | 49 sq ft

Living: 14'5" x 12'11" (14.4' x 12.9') | 186 sq ft

Primary: 14'1" x 14'4" (14.1' x 14.3') | 174 sq ft

#### GARAGE

Garage: 18'8" x 20'8" (18.6' x 20.7') | 321 sq ft

### Floor Area Information

Floor areas include footprint area of interior walls. All displayed floor areas are rounded to two decimal places. Total area is computed before rounding and may not equal to sum of displayed floor areas.

#### MAIN FLOOR

Interior Area: 1525.09 sq ft

Perimeter Wall Length: 179 ft

Perimeter Wall Thickness: 7.5 in

Exterior Area: 1637.18 sq ft

#### GARAGE

Excluded Area: 320.89 sq ft

Perimeter Wall Length: 81 ft

Perimeter Wall Thickness: 7.5 in

Total Above Grade Floor Area

Main Building Exterior: 1688.00 sq ft