

17563 Hewlett Road, Beaverdam, Hanover County, Virginia, United States, 23015

Gross Living Area: 1487 sq. ft

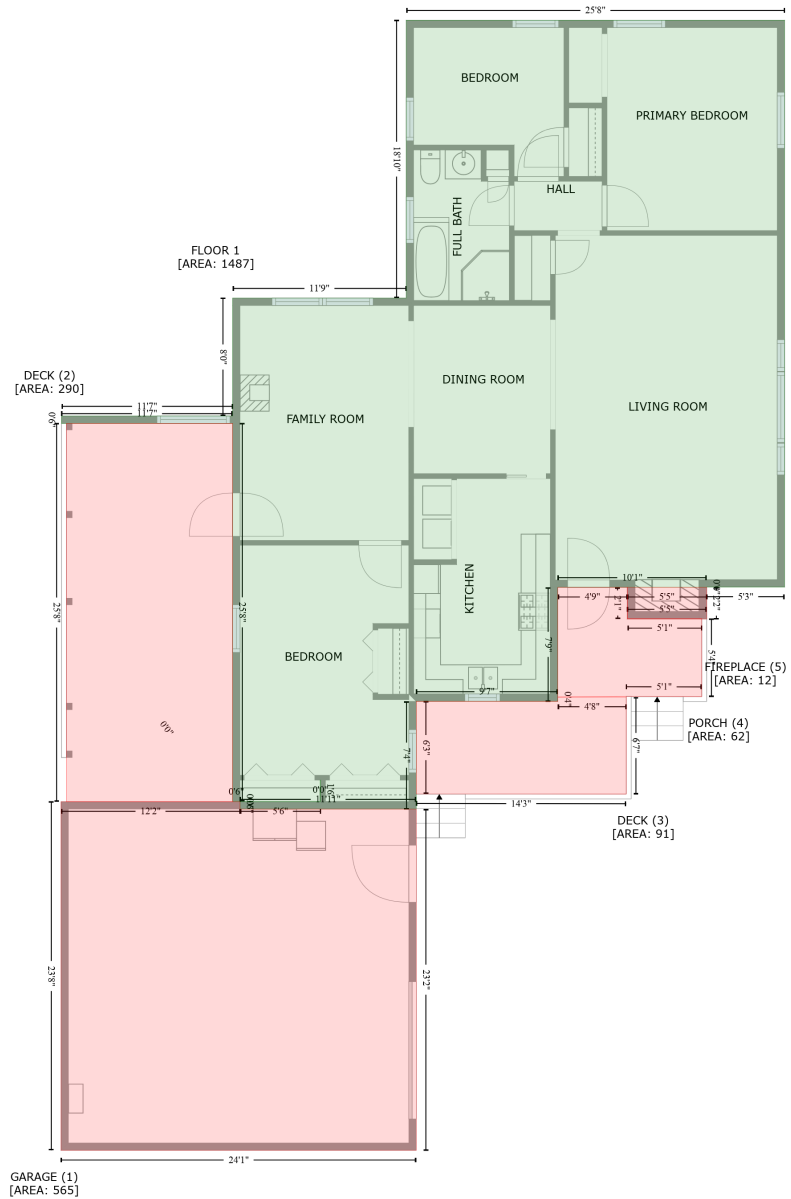

Space	Area (sq. ft)	Calculation <small>Coordinate Polygon Area Algorithm using inches</small>
FLOOR 1 (Living area)	1487	$ \begin{aligned} & -((768.5 + 768.5) * (-148.1 - 313.6) + (768.5 + 705.1) * (313.6 - 313.6) + (705.1 + 705.1) * (313.6 - \\ & 313.9) + (705.1 + 583.9) * (313.9 - 313.9) + (583.9 + 583.9) * (313.9 - 406.8) + (583.9 + 468.6) * \\ & (406.8 - 406.8) + (468.6 + 468.6) * (406.8 - 494.5) + (468.6 + 325.1) * (494.5 - 494.5) + (325.1 + \\ & 325.1) * (494.5 - 488.5) + (325.1 + 390.7) * (488.5 - 488.5) + (390.7 + 390.7) * (488.5 - 470.9) + \\ & (390.7 + 390.3) * (470.9 - 470.9) + (390.3 + 390.3) * (470.9 - 488.4) + (390.3 + 325.1) * (488.4 - \\ & 488.4) + (325.1 + 325.1) * (488.4 - 488.2) + (325.1 + 319.1) * (488.2 - 488.2) + (319.1 + 319.1) * \\ & (488.2 - 180.3) + (319.1 + 179.7) * (180.3 - 180.3) + (179.7 + 179.7) * (180.3 - 174.3) + (179.7 + \end{aligned} $

17563 Hewlett Road, Beaverdam, Hanover County, Virginia, United States, 23015

Gross Living Area: 1487 sq. ft

Space	Area (sq. ft)	Calculation <small>Coordinate Polygon Area Algorithm using inches</small>
GARAGE (Non-living area)	565	$319.1 * (174.3 - 174.3) + (319.1 + 319.1) * (174.3 - 78.3) + (319.1 + 460.4) * (78.3 - 78.3) + (460.4 + 460.4) * (78.3 - -148.1) + (460.4 + 768.5) * (-148.1 - -148.1)) * 0.5 * 0.00694$
DECK (Non-living area)	290	$-((325.1 + 325.1) * (488.5 - 494.5) + (325.1 + 468.6) * (494.5 - 494.5) + (468.6 + 468.6) * (494.5 - 772.5) + (468.6 + 179.3) * (772.5 - 772.5) + (179.3 + 179.3) * (772.5 - 488.5) + (179.3 + 325.1) * (488.5 - 488.5)) * 0.5 * 0.00694$
DECK (Non-living area)	91	$-((319.1 + 319.1) * (180.3 - 488.2) + (319.1 + 319.4) * (488.2 - 488.5) + (319.4 + 183.7) * (488.5 - 488.5) + (183.7 + 183.7) * (488.5 - 180.3) + (183.7 + 319.1) * (180.3 - 180.3)) * 0.5 * 0.00694$
PORCH (Non-living area)	62	$-((639.6 + 639.6) * (403.3 - 482.3) + (639.6 + 468.6) * (482.3 - 482.1) + (468.6 + 468.6) * (482.1 - 406.8) + (468.6 + 583.9) * (406.8 - 406.8) + (583.9 + 583.9) * (406.8 - 403.3) + (583.9 + 639.6) * (403.3 - 403.3)) * 0.5 * 0.00694$
FIREPLACE (Non-living area)	12	$-((640.4 + 640.6) * (313.9 - 339.2) + (640.6 + 701.1) * (339.2 - 339.2) + (701.1 + 701.1) * (339.2 - 402.9) + (701.1 + 639.6) * (402.9 - 402.8) + (639.6 + 583.9) * (402.8 - 403.3) + (583.9 + 583.9) * (403.3 - 313.9) + (583.9 + 640.4) * (313.9 - 313.9)) * 0.5 * 0.00694$