

Home report

1983 Stoney Battery Road, Troutville, Botetourt County, Virginia,
United States, 24175



Total Area: 1028 sq. ft

Floor 1: 1028 sq. ft

Excluded: Garage 584 sq. ft, Outdoor Porch 66 sq. ft, Outdoor Deck 215 sq. ft

Property summary

1 Floors

3 Bedrooms

1 Bathrooms

1 Garages

Home report

1983 Stoney Battery Road, Troutville, Botetourt County, Virginia,
United States, 24175

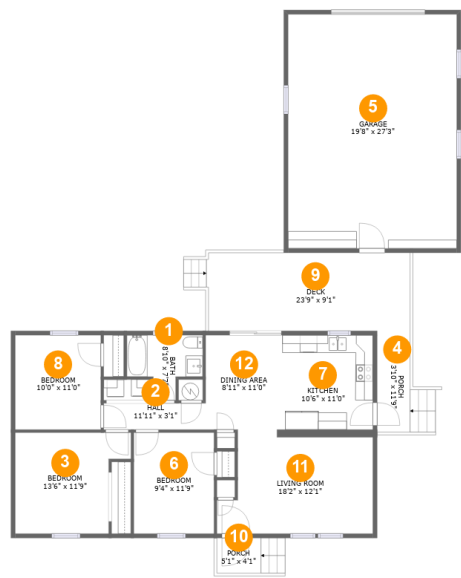

Room dimensions

Floor 1

Total:1028sqft

Excluded: 865sqft

#		Max Dimensions	sqft	Included
1	Bath	8'10" x 7'7"	50 sq. ft	Yes
2	Hall	11'11" x 3'1"	37 sq. ft	Yes
3	Bedroom	13'6" x 11'9"	136 sq. ft	Yes
4	Porch	3'10" x 11'9"	45 sq. ft	No
5	Garage	19'8" x 27'3"	536 sq. ft	No
6	Bedroom	9'4" x 11'9"	110 sq. ft	Yes
7	Kitchen	10'6" x 11'0"	116 sq. ft	Yes
8	Bedroom	10'0" x 11'0"	110 sq. ft	Yes
9	Deck	23'9" x 9'1"	218 sq. ft	No
10	Porch	5'1" x 4'1"	21 sq. ft	No
11	Living Room	18'2" x 12'1"	190 sq. ft	Yes

Home report

1983 Stoney Battery Road, Troutville, Botetourt County, Virginia,
United States, 24175

#		Max Dimensions	sqft	Included
12	Dining Area	8'11" x 11'0"	98 sq. ft	Yes

1 Floor 1 - Bath



Max Dimensions: 8'10" x 7'7"
Calculated Area: 50 sq. ft
Included: Yes

Heated: Yes
Finished: Yes
Enclosed: Yes
Contiguous: Yes
Permitted: Yes
Wet space: Yes
Addition: No
Conversion: No

2 Floor 1 - Hall



Max Dimensions: 11'11" x 3'1"
Calculated Area: 37 sq. ft
Included: Yes

Heated: Yes
Finished: Yes
Enclosed: Yes
Contiguous: Yes
Permitted: Yes
Wet space: No
Addition: No
Conversion: No

3 Floor 1 - Bedroom



Max Dimensions: 13'6" x 11'9"
Calculated Area: 136 sq. ft
Included: Yes

Heated: Yes
Finished: Yes
Enclosed: Yes
Contiguous: Yes
Permitted: Yes
Wet space: No
Addition: No
Conversion: No

4 Floor 1 - Porch



Max Dimensions: 3'10" x 11'9"
Calculated Area: 45 sq. ft
Included: No

Heated: No
Finished: Yes
Enclosed: No
Contiguous: Yes
Permitted: Yes
Wet space: No
Addition: No
Conversion: No

5 Floor 1 - Garage



Max Dimensions: 19'8" x 27'3"
Calculated Area: 536 sq. ft
Included: No

Heated: No
Finished: No
Enclosed: Yes
Contiguous: Yes
Permitted: Yes
Wet space: No
Addition: No
Conversion: No

6 Floor 1 - Bedroom



Max Dimensions: 9'4" x 11'9"
Calculated Area: 110 sq. ft
Included: Yes

Heated: Yes
Finished: Yes
Enclosed: Yes
Contiguous: Yes
Permitted: Yes
Wet space: No
Addition: No
Conversion: No

7 Floor 1 - Kitchen



Max Dimensions: 10'6" x 11'0"
Calculated Area: 116 sq. ft
Included: Yes

Heated: Yes
Finished: Yes
Enclosed: Yes
Contiguous: Yes
Permitted: Yes
Wet space: No
Addition: No
Conversion: No

8 Floor 1 - Bedroom



Max Dimensions: 10'0" x 11'0"
Calculated Area: 110 sq. ft
Included: Yes

Heated: Yes
Finished: Yes
Enclosed: Yes
Contiguous: Yes
Permitted: Yes
Wet space: No
Addition: No
Conversion: No

9 Floor 1 - Deck



Max Dimensions: 23'9" x 9'1"
Calculated Area: 218 sq. ft
Included: No

Heated: No
Finished: Yes
Enclosed: No
Contiguous: Yes
Permitted: Yes
Wet space: No
Addition: No
Conversion: No

10 Floor 1 - Porch



Max Dimensions: 5'1" x 4'1"
Calculated Area: 21 sq. ft
Included: No

Heated: No
Finished: Yes
Enclosed: No
Contiguous: Yes
Permitted: Yes
Wet space: No
Addition: No
Conversion: No

11 Floor 1 - Living Room



Max Dimensions: 18'2" x 12'1"
Calculated Area: 190 sq. ft
Included: Yes

Heated: Yes
Finished: Yes
Enclosed: Yes
Contiguous: Yes
Permitted: Yes
Wet space: No
Addition: No
Conversion: No

12 Floor 1 - Dining Area



Max Dimensions: 8'11" x 11'0"
Calculated Area: 98 sq. ft
Included: Yes

Heated: Yes
Finished: Yes
Enclosed: Yes
Contiguous: Yes
Permitted: Yes
Wet space: No
Addition: No
Conversion: No