

Building Sketch (Page - 2)

Client	CAW, LLC					
Property Address	3829 Dauphine St					
City	New Orleans	County		State	LA	Zip Code 70117
Appraiser	Otis G Shipman					

All measurements, calculations, and reporting of GLA and non-GLA is in adherence to the ANSI® Z765-2021 Standard.

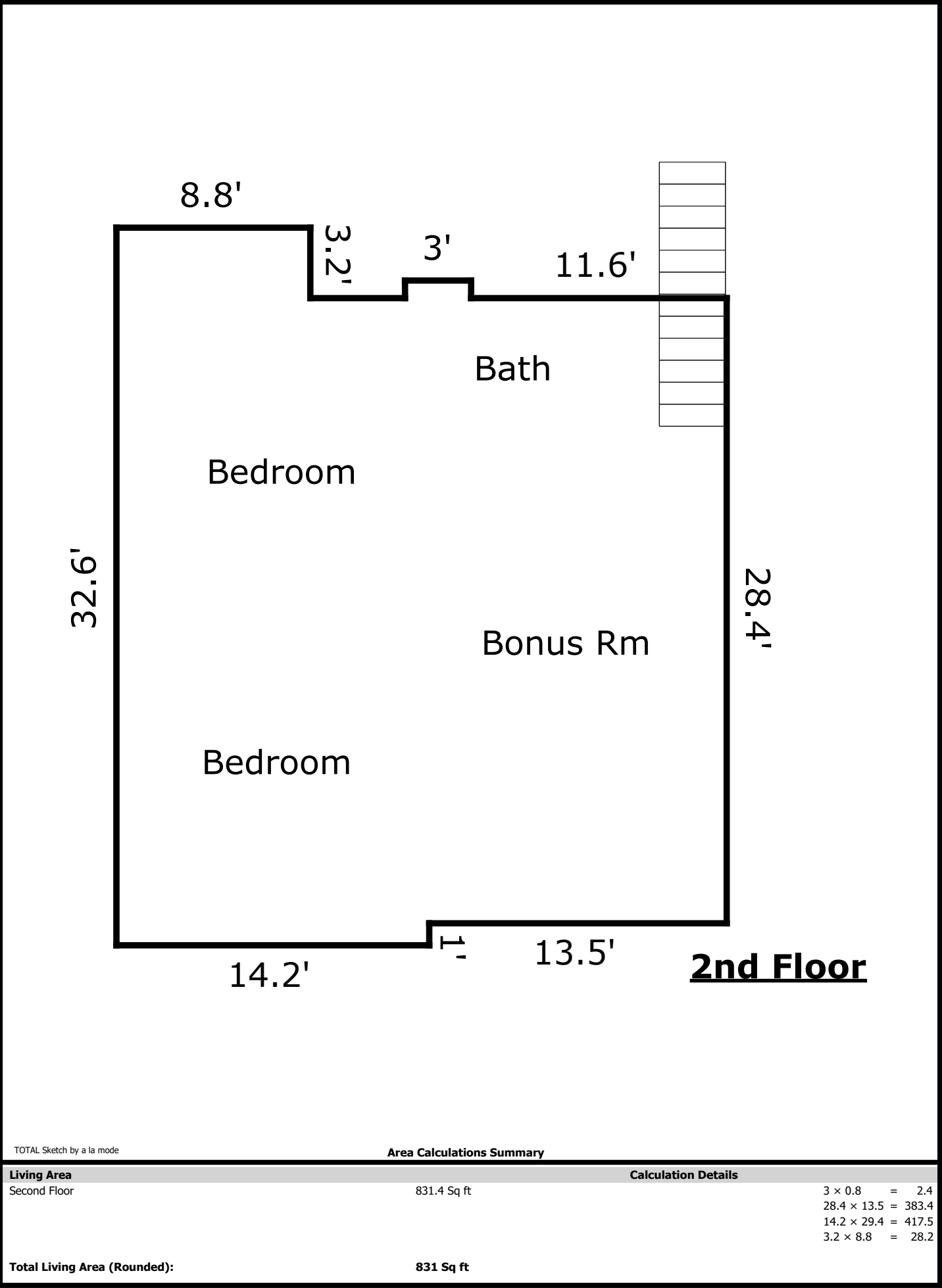

Supplemental Addendum

File No. 241204-A

Client	CAW, LLC				
Property Address	3829 Dauphine St				
City	New Orleans	County		State	LA
				Zip Code	70117
Appraiser	Otis G Shipman				

Interior Dimensions By Room

Room	Width	Depth	Ceiling Height
1st Flr			
Living	26.6	16.4	12.0
Kitchen	13.0	15.9	12.0
Dining	13.0	24.8	8.9-12.0
BR	13.0	14.4	12.0
Bath	7.8	9.9	12.0
2nd Floor			
BR	12.6	11.7	9.8
BR	12.6	12.9	9.8
Bonus Rm	12.9	22.5	5.0-9.8
Bath	9.9	4.9	5.0-9.8

FROM:

Telephone Number: (504) 300-9714

Fax Number:

E-Mail: katie@wcnola.com

Telephone Number: (504) 919-8585

Fax Number:

Alternate Number:

241204-A

Invoice Date: 12/04/2024

Due Date:

Internal Order #: 241204-A

Lender Case #:

Client File #:

FHA/VA Case #:

Main File # on form: 241204-A

Other File # on form:

Federal Tax ID:

Employer ID:

Lender:	CAW, LLC	Client:	CAW, LLC		
Purchaser/Borrower:					
Property Address:	3829 Dauphine St				
City:	New Orleans				
County:		State:	LA	Zip:	70117
Legal Description:					

AMOUNT

Measurement Fee:	150.00
------------------	--------

SUBTOTAL	150.00
-----------------	--------

AMOUNT

Check #:	Date:	Description:
Check #:	Date:	Description:
Check #:	Date:	Description:

Invoice via Google Pay

SUBTOTAL

TOTAL DUE	\$	150.00
-----------	----	--------