

1052 Timber Court, Big Island, Bedford County,  
Virginia, United States, 24526

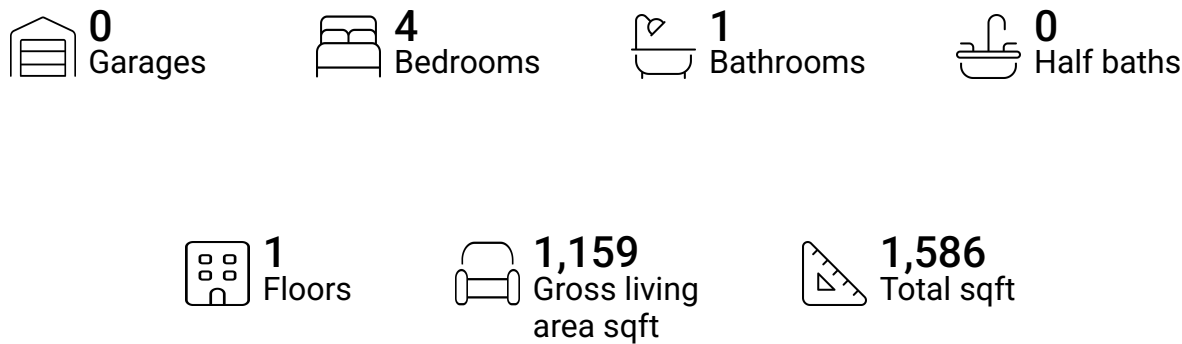

Property summary



# 1052 Timber Court, Big Island, Bedford County, Virginia, United States, 24526

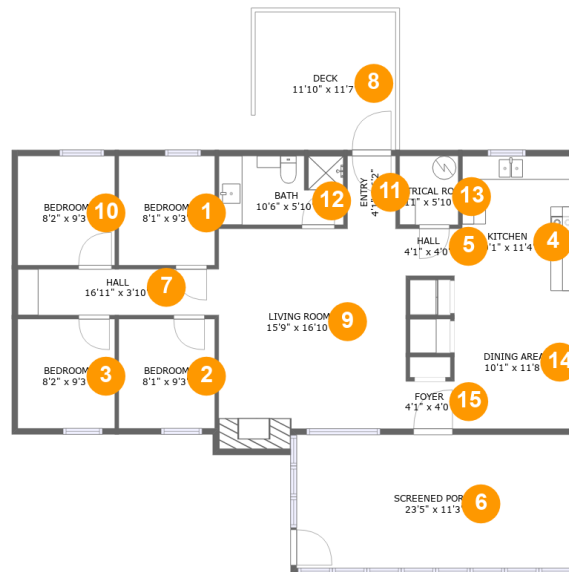

## Room dimensions

### Floor 1

Total sqft: 1586    Living area: 1159

#		Dimensions	sqft	Counted as living area
1	Bedroom	8'1" x 9'3"	75 sq. ft	Yes
2	Bedroom	8'1" x 9'3"	75 sq. ft	Yes
3	Bedroom	8'2" x 9'3"	75 sq. ft	Yes
4	Kitchen	10'1" x 11'4"	111 sq. ft	Yes
5	Hall	4'1" x 4'0"	16 sq. ft	Yes
6	Screened Porch	23'5" x 11'3"	263 sq. ft	No
7	Hall	16'11" x 3'10"	66 sq. ft	Yes
8	Deck	11'10" x 11'7"	138 sq. ft	No
9	Living Room	15'9" x 16'10"	277 sq. ft	Yes
10	Bedroom	8'2" x 9'3"	75 sq. ft	Yes
11	Entry	4'1" x 6'2"	25 sq. ft	Yes

**1052 Timber Court, Big Island, Bedford County,  
Virginia, United States, 24526**

#		Dimensions	sqft	Counted as living area
12	Bath	10'6" x 5'10"	60 sq. ft	Yes
13	Electrical Room	4'11" x 5'10"	29 sq. ft	Yes
14	Dining Area	10'1" x 11'8"	118 sq. ft	Yes
15	Foyer	4'1" x 4'0"	16 sq. ft	Yes

1052 Timber Court, Big Island, Bedford County,  
Virginia, United States, 24526

**1** Floor 1 - Bedroom



Dimensions: 8'1" x 9'3"  
Area: 75 sq. ft  
Counted as living area: Yes

Heated: Yes  
Finished: Yes  
Enclosed: Yes  
Contiguous: Yes  
Permitted: Yes  
Wet space: No  
Addition: No  
Conversion: No

**2** Floor 1 - Bedroom



Dimensions: 8'1" x 9'3"  
Area: 75 sq. ft  
Counted as living area: Yes

Heated: Yes  
Finished: Yes  
Enclosed: Yes  
Contiguous: Yes  
Permitted: Yes  
Wet space: No  
Addition: No  
Conversion: No

1052 Timber Court, Big Island, Bedford County,  
Virginia, United States, 24526

### 3 Floor 1 - Bedroom



Dimensions: 8'2" x 9'3"  
Area: 75 sq. ft  
Counted as living area: Yes

Heated: Yes  
Finished: Yes  
Enclosed: Yes  
Contiguous: Yes  
Permitted: Yes  
Wet space: No  
Addition: No  
Conversion: No

### 4 Floor 1 - Kitchen



Dimensions: 10'1" x 11'4"  
Area: 111 sq. ft  
Counted as living area: Yes

Heated: Yes  
Finished: Yes  
Enclosed: Yes  
Contiguous: Yes  
Permitted: Yes  
Wet space: No  
Addition: No  
Conversion: No

### 5 Floor 1 - Hall



Dimensions: 4'1" x 4'0"  
Area: 16 sq. ft  
Counted as living area: Yes

Heated: Yes  
Finished: Yes  
Enclosed: Yes  
Contiguous: Yes  
Permitted: Yes  
Wet space: No  
Addition: No  
Conversion: No

1052 Timber Court, Big Island, Bedford County,  
Virginia, United States, 24526

## 6 Floor 1 - Screened Porch



Dimensions: 23'5" x 11'3"  
Area: 263 sq. ft  
Counted as living area: No

Heated: No  
Finished: Yes  
Enclosed: No  
Contiguous: Yes  
Permitted: Yes  
Wet space: No  
Addition: No  
Conversion: No

## 7 Floor 1 - Hall



Dimensions: 16'11" x 3'10"  
Area: 66 sq. ft  
Counted as living area: Yes

Heated: Yes  
Finished: Yes  
Enclosed: Yes  
Contiguous: Yes  
Permitted: Yes  
Wet space: No  
Addition: No  
Conversion: No

## 8 Floor 1 - Deck



Dimensions: 11'10" x 11'7"  
Area: 138 sq. ft  
Counted as living area: No

Heated: No  
Finished: Yes  
Enclosed: No  
Contiguous: Yes  
Permitted: Yes  
Wet space: No  
Addition: No  
Conversion: No

1052 Timber Court, Big Island, Bedford County,  
Virginia, United States, 24526

## 9 Floor 1 - Living Room



Dimensions: 15'9" x 16'10"  
Area: 277 sq. ft  
Counted as living area: Yes

Heated: Yes  
Finished: Yes  
Enclosed: Yes  
Contiguous: Yes  
Permitted: Yes  
Wet space: No  
Addition: No  
Conversion: No

## 10 Floor 1 - Bedroom



Dimensions: 8'2" x 9'3"  
Area: 75 sq. ft  
Counted as living area: Yes

Heated: Yes  
Finished: Yes  
Enclosed: Yes  
Contiguous: Yes  
Permitted: Yes  
Wet space: No  
Addition: No  
Conversion: No

## 11 Floor 1 - Entry



Dimensions: 4'1" x 6'2"  
Area: 25 sq. ft  
Counted as living area: Yes

Heated: Yes  
Finished: Yes  
Enclosed: Yes  
Contiguous: Yes  
Permitted: Yes  
Wet space: No  
Addition: No  
Conversion: No

1052 Timber Court, Big Island, Bedford County,  
Virginia, United States, 24526

## 12 Floor 1 - Bath



Dimensions: 10'6" x 5'10"  
Area: 60 sq. ft  
Counted as living area: Yes

Heated: Yes  
Finished: Yes  
Enclosed: Yes  
Contiguous: Yes  
Permitted: Yes  
Wet space: Yes  
Addition: No  
Conversion: No

## 13 Floor 1 - Electrical Room



Dimensions: 4'11" x 5'10"  
Area: 29 sq. ft  
Counted as living area: Yes

Heated: Yes  
Finished: Yes  
Enclosed: Yes  
Contiguous: Yes  
Permitted: Yes  
Wet space: No  
Addition: No  
Conversion: No

## 14 Floor 1 - Dining Area



Dimensions: 10'1" x 11'8"  
Area: 118 sq. ft  
Counted as living area: Yes

Heated: Yes  
Finished: Yes  
Enclosed: Yes  
Contiguous: Yes  
Permitted: Yes  
Wet space: No  
Addition: No  
Conversion: No



**1052 Timber Court, Big Island, Bedford County,  
Virginia, United States, 24526**

## **15** Floor 1 - Foyer



**Dimensions: 4'1" x 4'0"**

**Area: 16 sq. ft**

**Counted as living area: Yes**

**Heated: Yes**

**Finished: Yes**

**Enclosed: Yes**

**Contiguous: Yes**

**Permitted: Yes**

**Wet space: No**

**Addition: No**

**Conversion: No**