

Building Sketch

Borrower/Client				
Property Address 1344 Parkview Circle				
City	Salisbury	County	State NC	Zip Code 28144
Lender				

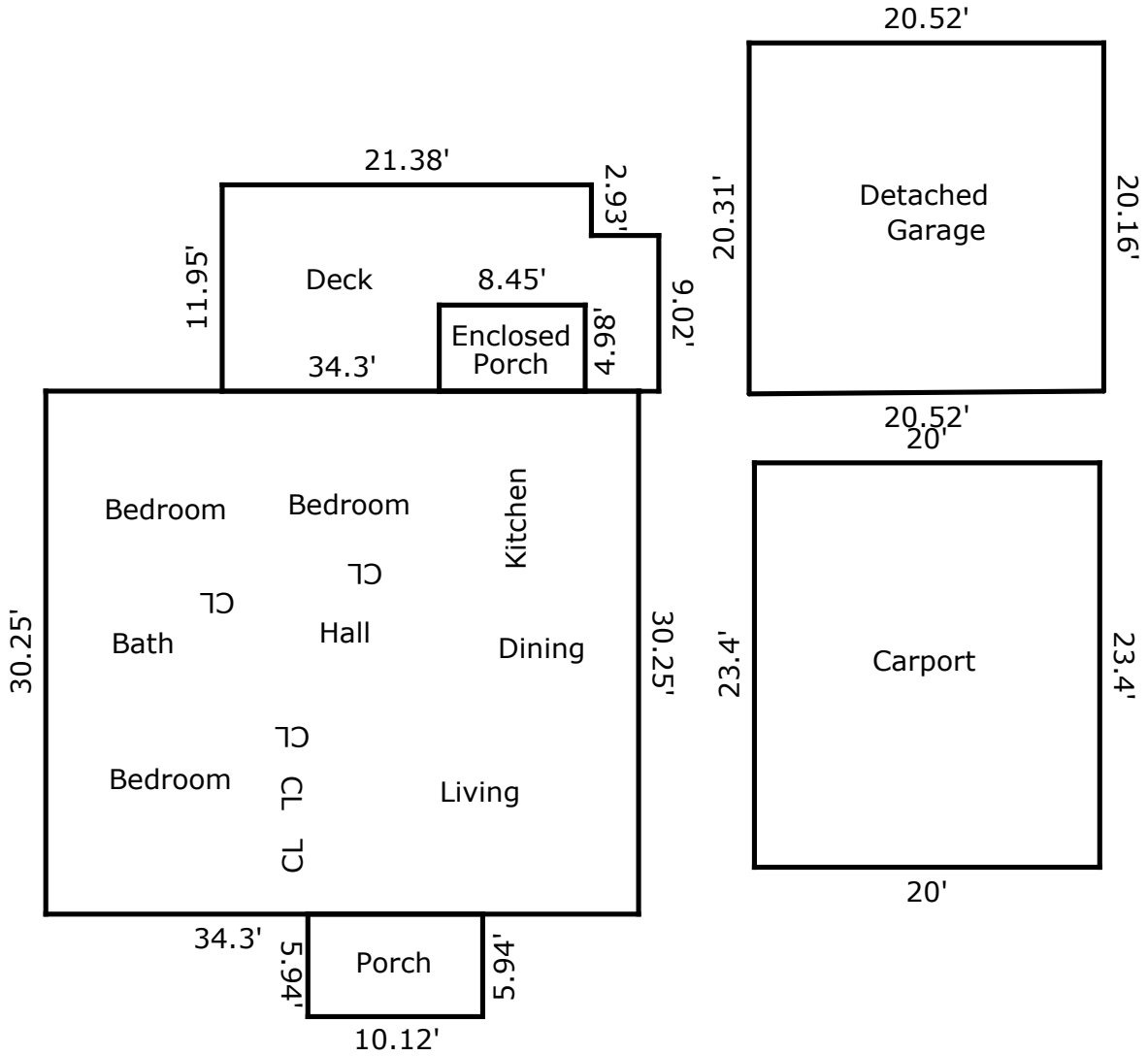

TOTAL Sketch by a la mode

Area Calculations Summary

Living Area	
Main Level	1037.57 Sq ft
Total Living Area (Rounded):	1038 Sq ft
Non-living Area	
Deck	290.58 Sq ft
Detached Garage	415.22 Sq ft
Enclosed Porch	42.08 Sq ft
Porch	60.11 Sq ft
Carport	468 Sq ft