

# Building Sketch

Borrower/Client			
Property Address 1810 Irish Potato Road			
City Concord	County	State NC	Zip Code 28025
Lender			

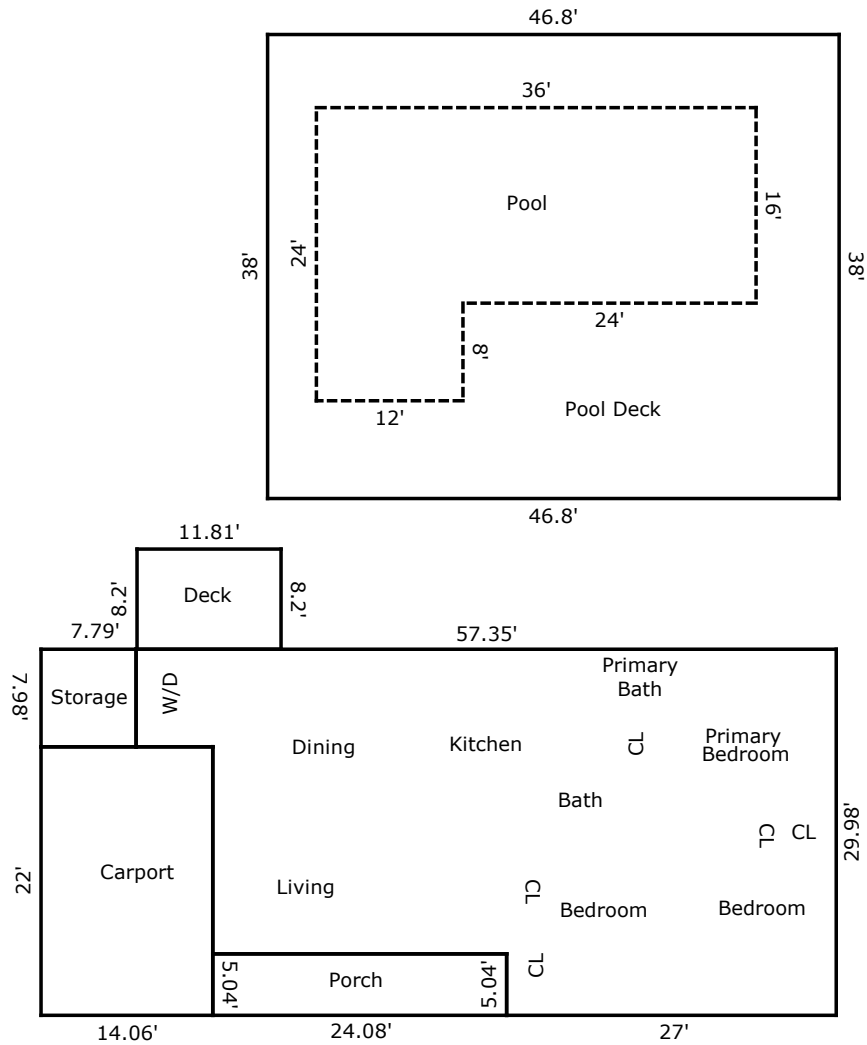

TOTAL Sketch by a la mode

## Area Calculations Summary

<b>Living Area</b>	
Main Level	1460.05 Sq ft
<b>Total Living Area (Rounded):</b>	<b>1460 Sq ft</b>
<b>Non-living Area</b>	
Porch	121.36 Sq ft
Carport	309.32 Sq ft
Pool Deck	1106.4 Sq ft
Storage	62.16 Sq ft
Deck	96.84 Sq ft
Pool	672 Sq ft