

TOTAL Sketch by a la mode

Area Calculations Summary

Living Area

Main Level	1753.47 Sq ft
Second Level	2001.85 Sq ft
Total Living Area (Rounded):	3755 Sq ft

Non-living Area

Porch	120.52 Sq ft
Patio	371.79 Sq ft
Garage	491.19 Sq ft
Area Below 5 Feet	16.69 Sq ft
Area Below 5 Feet	11.34 Sq ft

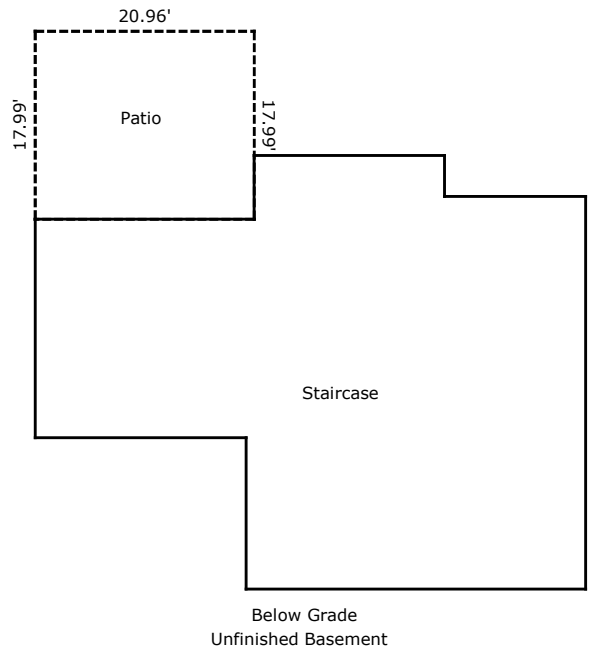

TOTAL Sketch by a la mode

Area Calculations Summary

Non-living Area

Patio	377.07 Sq ft
Below Grade	1712.26 Sq ft

Area Calculations Summary

Living Area		Calculation Details	
Main Level	1753.47 Sq ft	$21.52 \times 20.99 =$	451.7
		$32.81 \times 35.41 =$	1161.8
		$6.1 \times 18.26 =$	111.39
		$1.99 \times 14.36 =$	28.58
Second Level	2001.85 Sq ft	$12.91 \times 11.34 =$	146.4
		$12.55 \times 15.52 =$	194.78
		$22.43 \times 14.23 =$	319.18
		$17.89 \times 6.09 =$	108.95
		$39.82 \times 19.83 =$	789.63
		$8.21 \times 3.7 =$	30.38
		$13.56 \times 16.11 =$	218.45
		$15.5 \times 10.85 =$	168.18
		$8.15 \times 3.18 =$	25.92
Total Living Area (Rounded):	3755 Sq ft		
Non-living Area			
Porch	120.52 Sq ft	$32.31 \times 3.73 =$	120.52
Patio	371.79 Sq ft	$20.35 \times 18.27 =$	371.79
Garage	491.19 Sq ft	$23.18 \times 20.99 =$	486.55
		$0.5 \times 9.29 =$	4.64
Area Below 5 Feet	16.69 Sq ft	$16.69 \times 1 =$	16.69
Area Below 5 Feet	11.34 Sq ft	$1 \times 11.34 =$	11.34
Patio	377.07 Sq ft	$20.96 \times 17.99 =$	377.07
Below Grade	1712.26 Sq ft	$20.91 \times 20.18 =$	421.96
		$32.49 \times 35.39 =$	1149.82
		$6.1 \times 18.2 =$	111.02
		$2.18 \times 13.51 =$	29.45