

# Building Sketch

Borrower/Client				
Property Address 8713 Sedgeburn Drive				
City	Charlotte	County	State NC	Zip Code 28278
Lender				

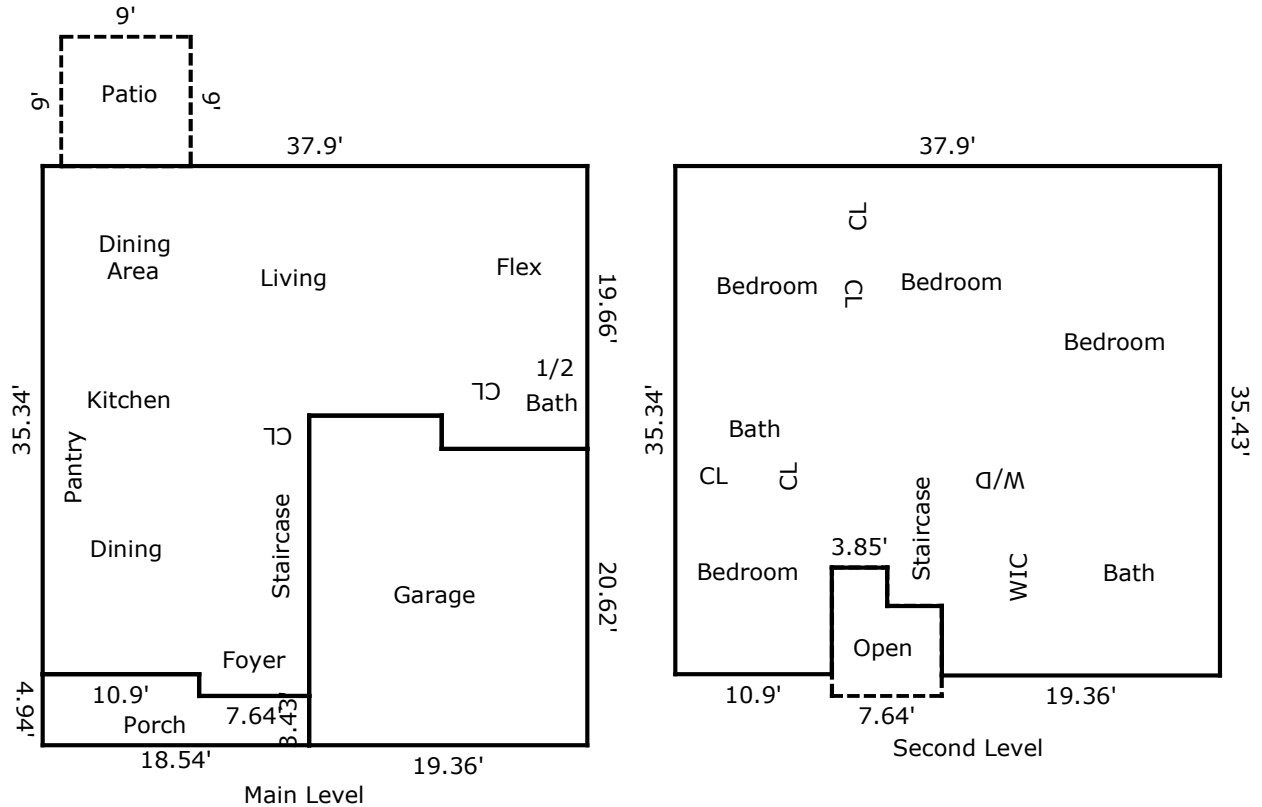

TOTAL Sketch by a la mode

### Area Calculations Summary

<b>Living Area</b>	
Main Level	1026.15 Sq ft
Second Level	1294.56 Sq ft
<b>Total Living Area (Rounded):</b>	<b>2321 Sq ft</b>
<b>Non-living Area</b>	
Garage	420.41 Sq ft
Porch	80.05 Sq ft
Patio	81 Sq ft
Open to Below	58.11 Sq ft