

Building Sketch

| | | | | |
|-------------------------------------|-----------|--------|----------|----------------|
| Borrower/Client | | | | |
| Property Address 302 Nottingham Way | | | | |
| City | Wadesboro | County | State NC | Zip Code 28001 |
| Lender | | | | |

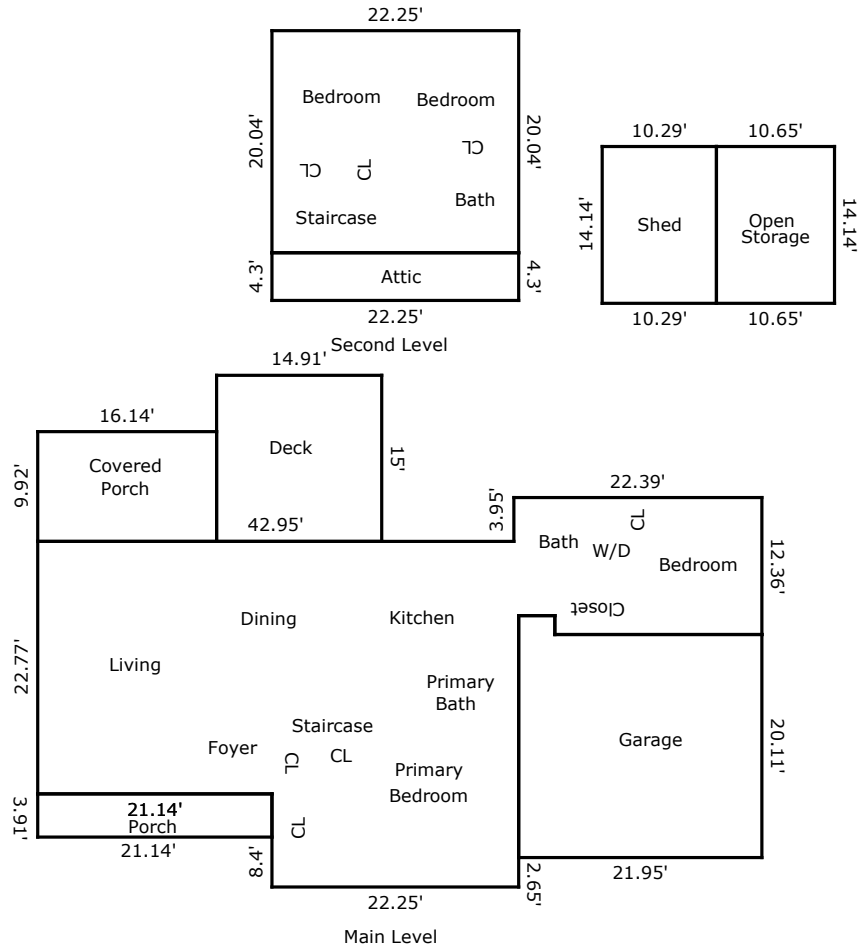

TOTAL Sketch by a la mode

Area Calculations Summary

| Living Area | |
|-------------------------------------|-------------------|
| Main Level | 1442.31 Sq ft |
| Second Level | 445.89 Sq ft |
| Total Living Area (Rounded): | 1888 Sq ft |
| Non-living Area | |
| Porch | 82.66 Sq ft |
| Porch | 160.11 Sq ft |
| Deck | 223.65 Sq ft |
| Garage | 447.04 Sq ft |
| Shed | 145.5 Sq ft |
| Storage | 150.59 Sq ft |
| Attic | 95.68 Sq ft |