

# Building Sketch

Borrower/Client				
Property Address 7919 Concord HWY				
City	Monroe	County	State NC	Zip Code 28110
Lender				

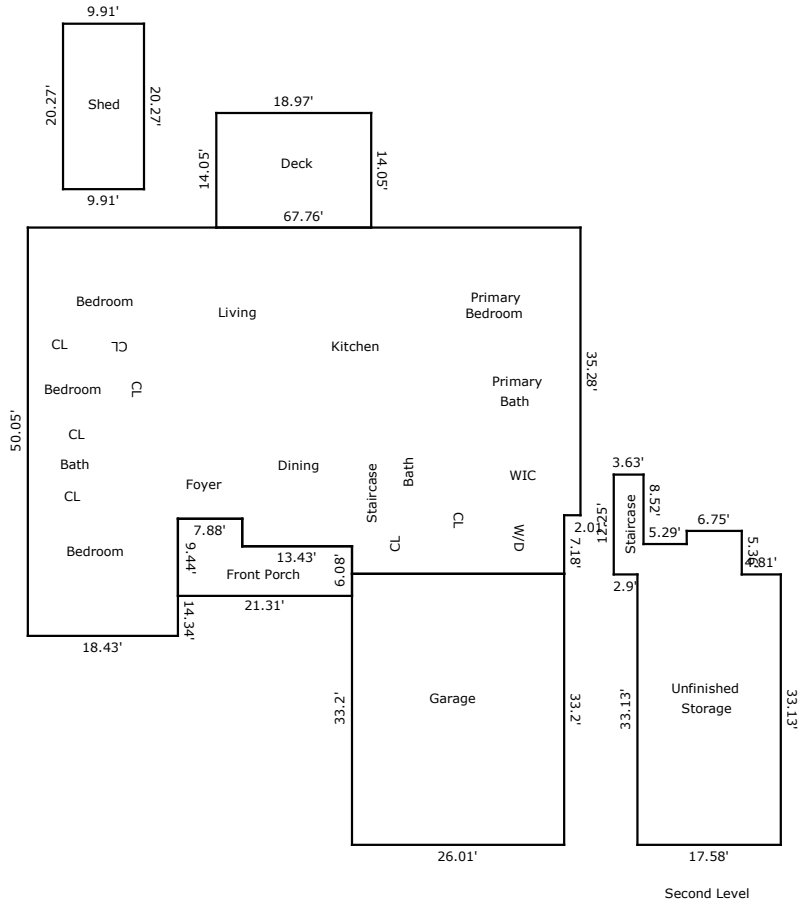

TOTAL Sketch by a la mode

## Area Calculations Summary

Living Area	Calculation Details	
Main Living Area	2903.82 Sq ft	$18.43 \times 14.34 = 264.29$ $35.71 \times 26.31 = 939.53$ $41.45 \times 35.28 = 1462.36$ $3.79 \times 13.43 = 50.9$ $26.01 \times 7.18 = 186.75$
<b>Total Living Area (Rounded):</b>	<b>2904 Sq ft</b>	
Non-living Area		
Deck	266.53 Sq ft	$18.97 \times 14.05 = 266.53$
Shed	200.88 Sq ft	$9.91 \times 20.27 = 200.88$
Porch	156.04 Sq ft	$9.44 \times 7.88 = 74.39$ $6.08 \times 13.43 = 81.65$
Garage	863.53 Sq ft	$26.01 \times 33.2 = 863.53$
Attic	682.8 Sq ft	$17.58 \times 33.13 = 582.43$ $5.36 \times 6.75 = 36.18$ $3.73 \times 5.29 = 19.73$ $3.63 \times 12.25 = 44.47$