

4677 East Rail North Road, Catalina, Tucson, Pima County, Arizona, United States, 85739

Total area: 5760 sq. ft
Gross living area: 4087 sq. ft

Finished area: 4087 sq. ft
Non-standard finished area: 250 sq. ft

Level 1

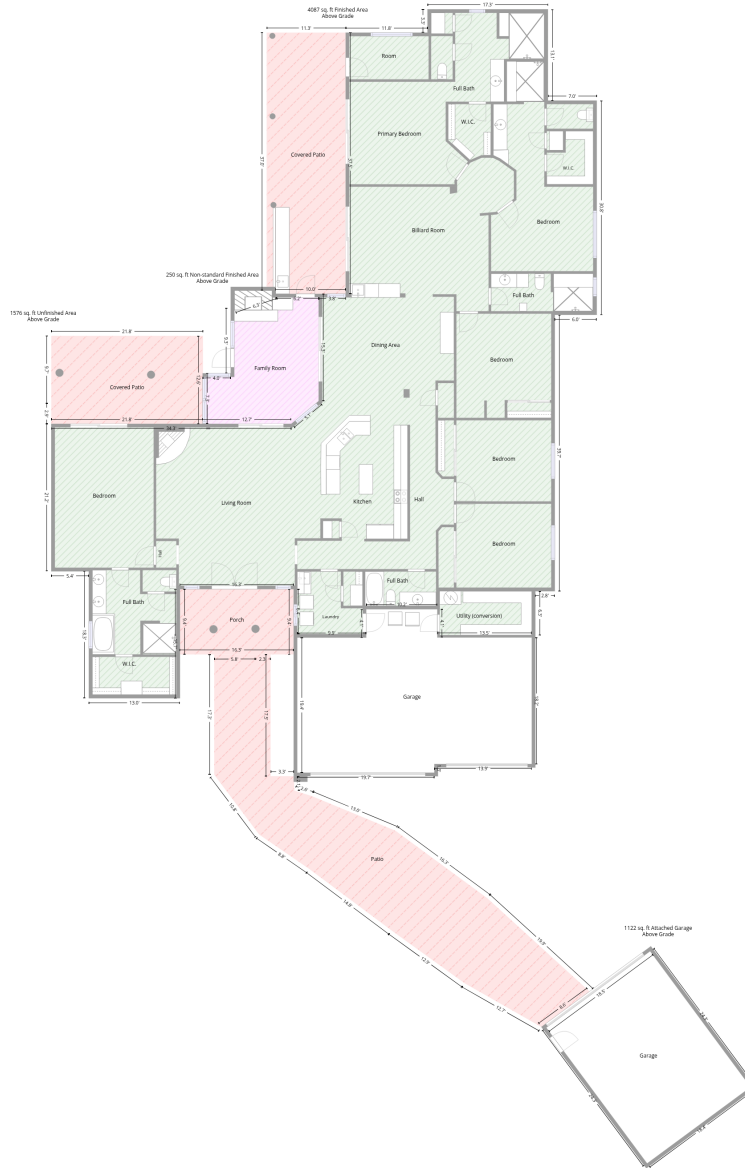

Total area: 5760 sq. ft
Gross living area: 4087 sq. ft

Finished area: 4087 sq. ft
Non-standard finished area: 250 sq. ft

4677 East Rail North Road, Catalina, Tucson, Pima County, Arizona, United States, 85739

Total area: 5760 sq. ft
Gross living area: 4087 sq. ft

Finished area: 4087 sq. ft
Non-standard finished area: 250 sq. ft

Level 1

Space	Area (sq. ft)	Calculation <small>Coordinate Polygon Area Algorithm using inches</small>
Finished Area • Living area • Finished Area	4087	$-(934.3 + 934.3) * (32.2 - 189.3) + (934.3 + 1018.1) * (189.3 - 189.3) + (1018.1 + 1018.1) * (189.3 - 557.9) + (1018.1 + 946.1) * (557.9 - 557.9) + (946.1 + 946.1) * (557.9 - 1033.5) + (946.1 + 912.6) * (1033.5 - 1033.5) + (912.6 + 912.6) * (1033.5 - 1109.1) + (912.6 + 906.6) * (1109.1 - 1109.1) + (906.6 + 906.6) * (1109.1 - 1113.1) + (906.6 + 744.3) * (1113.1 - 1113.1) + (744.3 + 744.3) * (1113.1 - 1064.6) + (744.3 + 622) * (1064.6 - 1064.6) + (622 + 622) * (1064.6 - 1113.4) + (622 + 503.5) * (1113.4 - 1113.4) + (503.5 + 503.5) * (1113.4 - 1107.4) + (503.5 + 497.5) * (1107.4 - 1107.4) + (497.5 + 497.5) * (1107.4 - 1029.9) + (497.5 + 302) * (1029.9 - 1029.9) + (302 + 302) * (1029.9 - 1217.7) + (302 + 145.6) * (1217.7 - 1217.7) + (145.6 + 145.6) * (1217.7 - 999.2) + (145.6 + 81) * (999.2 - 999.2) + (81 + 81) * (999.2 - 745.6) + (81 + 493.3) * (745.6 - 745.6) + (493.3 + 540.5) * (745.6 - 706.2) + (540.5 + 540.5) * (706.2 - 522) + (540.5 + 586.9) * (522 - 522) + (586.9 + 586.9) * (522 - 72.3) + (586.9 + 727.5) * (72.3 - 72.3) + (727.5 + 727.5) * (72.3 - 32.2) + (727.5 + 934.3) * (32.2 - 32.2) * 0.5 * 0.00694$
FAMILY ROOM • Non-living area • Non-Standard Finished Area	250	$-(540.5 + 540.5) * (522 - 706.2) + (540.5 + 493.3) * (706.2 - 745.6) + (493.3 + 341.1) * (745.6 - 745.6) + (341.1 + 341.1) * (745.6 - 658.7) + (341.1 + 389.3) * (658.7 - 658.7) + (389.3 + 389.3) * (658.7 - 546.5) + (389.3 + 395.3) * (546.5 - 546.5) + (395.3 + 466.5) * (546.5 - 522) + (466.5 + 540.5) * (522 - 522) * 0.5 * 0.00694$
COVERED PATIO • Non-living area • Unfinished Area	274	$-(341.6 + 341.6) * (594.2 - 745.6) + (341.6 + 81) * (745.6 - 745.6) + (81 + 81) * (745.6 - 710.6) + (81 + 81) * (710.6 - 594.2) + (81 + 341.6) * (594.2 - 594.2) * 0.5 * 0.00694$
COVERED PATIO • Non-living area • Unfinished Area	424	$-(586.9 + 586.9) * (72.2 - 522) + (586.9 + 466.5) * (522 - 522) + (466.5 + 460.5) * (522 - 524) + (460.5 + 460.5) * (524 - 515.9) + (460.5 + 451) * (515.9 - 515.9) + (451 + 451) * (515.9 - 72.2) + (451 + 586.9) * (72.2 - 72.2) * 0.5 * 0.00694$
PATIO • Non-living area • Unfinished Area	725	$-(457.8 + 457.8) * (1142.4 - 1352) + (457.8 + 497.5) * (1352 - 1352) + (497.5 + 498.7) * (1352 - 1376.8) + (498.7 + 528.5) * (1376.8 - 1386.1) + (528.5 + 672.4) * (1386.1 - 1445.8) + (672.4 + 829.7) * (1445.8 - 1561.6) + (829.7 + 1006.1) * (1561.6 - 1722.9) + (1006.1 + 923.1) * (1722.9 - 1783.4) + (923.1 + 791.1) * (1783.4 - 1708.1) + (791.1 + 665.7) * (1708.1 - 1617.5) + (665.7 + 524.4) * (1617.5 - 1511.7) + (524.4 + 438.2) * (1511.7 - 1452.2) + (438.2 + 360.9) * (1452.2 - 1349.3) + (360.9 + 360.9) * (1349.3 - 1142.5) + (360.9 + 430.8) * (1142.5 - 1142.4) + (430.8 + 457.8) * (1142.4 - 1142.4) * 0.5 * 0.00694$
PORCH • Non-living area • Unfinished Area	153	$-(497.5 + 497.5) * (1029.9 - 1142.4) + (497.5 + 302) * (1142.4 - 1142.4) + (302 + 302) * (1142.4 - 1029.9) + (302 + 497.5) * (1029.9 - 1029.9) * 0.5 * 0.00694$
GARAGE • Attached Garage	1122	$-(1109.9 + 1282.6) * (1653.1 - 1886.9) + (1282.6 + 1104.7) * (1886.9 - 2018.4) + (1104.7 + 931.5) * (2018.4 - 1784.6) + (931.5 + 1109.9) * (1784.6 - 1653.1) * 0.5 * 0.00694 + -(744.3 + 744.3) * (1064.6 - 1113.1) + (744.3 + 906.6) * (1113.1 - 1113.1) + (906.6 + 906.6) * (1113.1 - 1331) + (906.6 + 739.3) * (1331 - 1331) + (739.3 + 739.3) * (1331 - 1346) + (739.3 + 503.5) * (1346 - 1346) + (503.5 + 503.5) * (1346 - 1113.4) + (503.5 + 622) * (1113.4 - 1113.4) + (622 + 622) * (1113.4 - 1064.6) + (622 + 744.3) * (1064.6 - 1064.6) * 0.5 * 0.00694$

4677 East Rail North Road, Catalina, Tucson, Pima County, Arizona, United States, 85739

Total area: 5760 sq. ft

Gross living area: 4087 sq. ft

Finished area: 4087 sq. ft

Non-standard finished area: 250 sq. ft

Property UPD

Data	Value
Structure	2
Unit	1
Level Number	1
Below Grade	false
Level Low Ceiling	false
ADU Indicator	false
Total Area	5035
Finished Area	4087
Non-Standard Finished Area	250
Structure	1
Unit	1
Level Number	1
Below Grade	false
Level Low Ceiling	false
ADU Indicator	false
Total Area	725
Finished Area	0
Non-Standard Finished Area	0