



**TOTAL: 4506 sq. ft**

FLOOR 1: 2872 sq. ft, FLOOR 2: 1634 sq. ft

EXCLUDED AREAS: CARPORT: 736 sq. ft, PORCH: 614 sq. ft, SCREENED PORCH: 890 sq. ft,

PATIO: 1786 sq. ft, STORAGE: 113 sq. ft, GARAGE: 261 sq. ft,

OPEN TO BELOW: 794 sq. ft, LOW CEILING: 135 sq. ft

This floor plan is intended for marketing and illustrative purposes and is to be used as a guide only to give a general indication of the layout. The floor plan contained here, measurements of rooms, square footage and any other items are approximate, may not be to scale and are not meant to be binding nor form any part of a contract. No responsibility is taken for any error, omission, or misstatement. Prospective purchasers are encouraged to conduct their own due diligence.

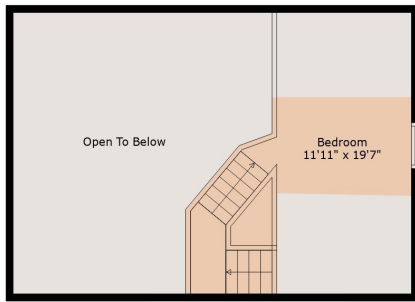

**TOTAL: 4506 sq. ft**  
 FLOOR 1: 2872 sq. ft, FLOOR 2: 1634 sq. ft  
 EXCLUDED AREAS: CARPORT: 736 sq. ft, PORCH: 614 sq. ft, SCREENED PORCH: 890 sq. ft,  
 PATIO: 1786 sq. ft, STORAGE: 113 sq. ft, GARAGE: 261 sq. ft,  
 OPEN TO BELOW: 794 sq. ft, LOW CEILING: 135 sq. ft

This floor plan is intended for marketing and illustrative purposes and is to be used as a guide only to give a general indication of the layout. The floor plan contained here, measurements of rooms, square footage and any other items are approximate, may not be to scale and are not meant to be binding nor form any part of a contract. No responsibility is taken for any error, omission, or misstatement. Prospective purchasers are encouraged to conduct their own due diligence.

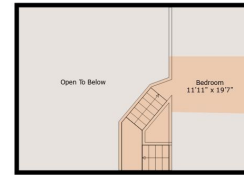

Floor 2

**TOTAL: 4504 sq. ft**  
 FLOOR 1: 2872 sq. ft, FLOOR 2: 1632 sq. ft  
 EXCLUDED AREAS: CARPORT: 736 sq. ft, PORCH: 614 sq. ft, SCREENED PORCH: 890 sq. ft,  
 PATIO: 1786 sq. ft, STORAGE: 113 sq. ft, GARAGE: 261 sq. ft,  
 OPEN TO BELOW: 794 sq. ft, LOW CEILING: 135 sq. ft

This floor plan is intended for marketing and illustrative purposes and is to be used as a guide only to give a general indication of the layout. The floor plan contained here, measurements of rooms, square footage and any other items are approximate, may not be to scale and are not meant to be binding nor form any part of a contract. No responsibility is taken for any error, omission, or misstatement. Prospective purchasers are encouraged to conduct their own due diligence.