

# Building Sketch

Borrower/Client			
Property Address 623 S Fulton Street			
City Salisbury	County	State NC	Zip Code 28144
Lender			

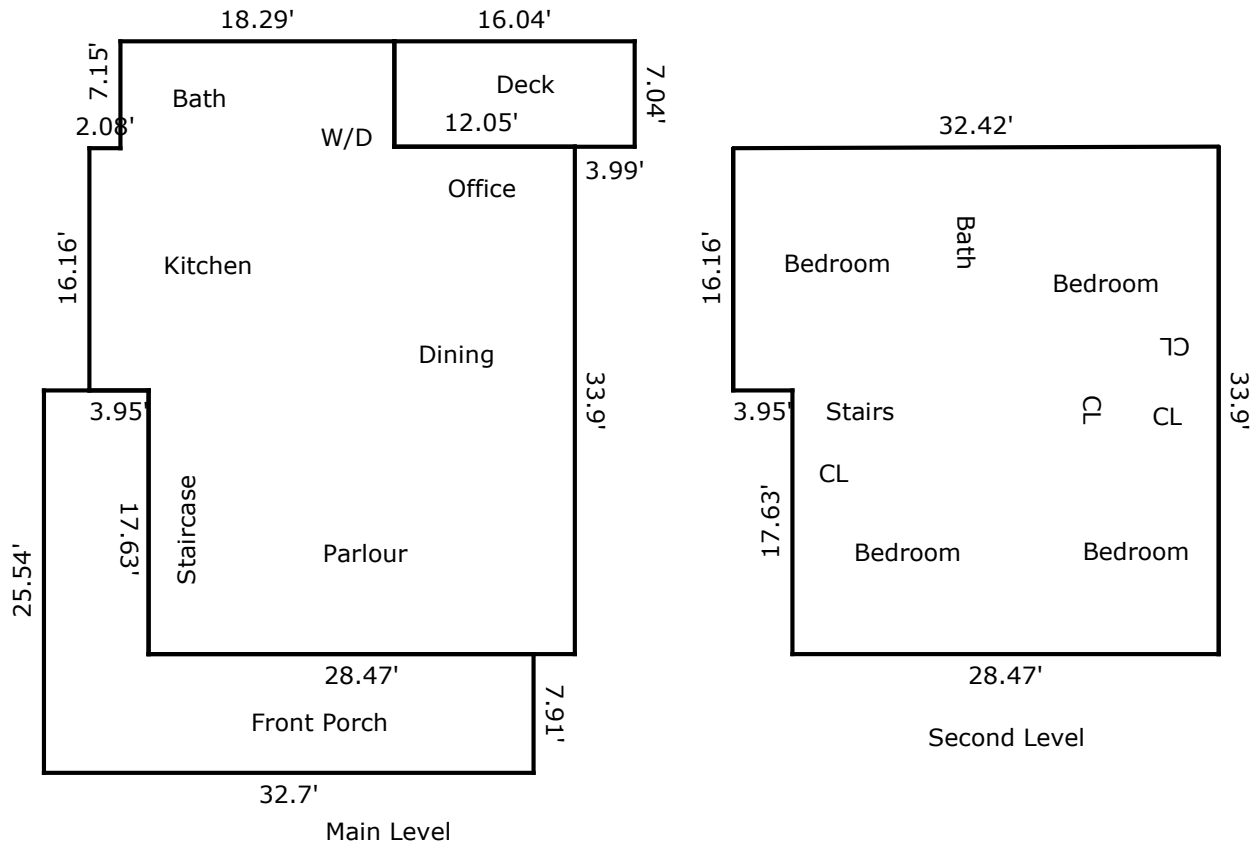

TOTAL Sketch by a la mode

### Area Calculations Summary

<b>Living Area</b>	
Main Level	1157.93 Sq ft
Second Level	1027.62 Sq ft
<b>Total Living Area (Rounded):</b>	<b>2186 Sq ft</b>
<b>Non-living Area</b>	
Porch	381.71 Sq ft
Porch	112.92 Sq ft