

Building Sketch (Page - 1)

Client	Tom Rieck - Riley Jones Media		
Property Address	345 Lockwood Ln SW		
City	Supply	County Brunswick	State NC Zip Code 28462
Client	Tom Rieck - Riley Jones Media		

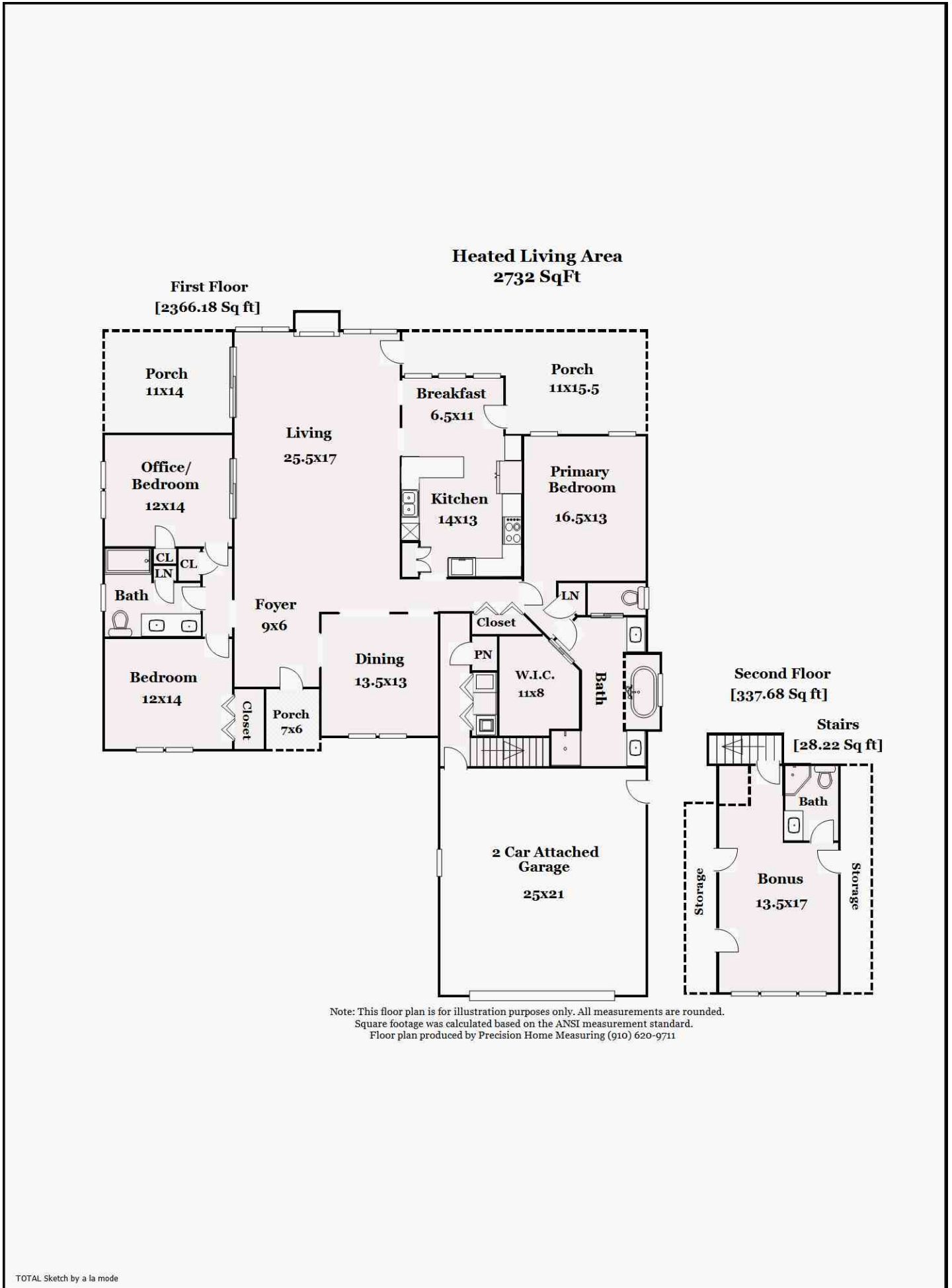

TOTAL Sketch by a la mode

Building Sketch (Page - 2)

Client	Tom Rieck - Riley Jones Media		
Property Address	345 Lockwood Ln SW		
City	Supply	County Brunswick	State NC Zip Code 28462
Client	Tom Rieck - Riley Jones Media		

TOTAL Sketch by a la mode

Area Calculations Summary

Living Area	Calculation Details	
First Floor	2366.18 Sq ft	$8.5 \times 1.5 = 12.75$ $36.7 \times 15.7 = 576.19$ $7.2 \times 3.4 = 24.48$ $34.9 \times 14.3 = 499.07$ $3.5 \times 6.9 = 24.15$ $39.7 \times 11.4 = 452.58$ $8.9 \times 5.4 = 48.06$ $18.5 \times 39.4 = 728.9$
Stairs	28.22 Sq ft	$8.3 \times 3.4 = 28.22$
Second Floor	337.68 Sq ft	$13.4 \times 25.2 = 337.68$
Total Living Area (Rounded):	2732 Sq ft	
Non-living Area		
2 Car Attached	577.08 Sq ft	$22.9 \times 25.2 = 577.08$
Porch	238.69 Sq ft	$11.5 \times 15.7 = 180.55$ $5.1 \times 11.4 = 58.14$
Porch	163.02 Sq ft	$11.4 \times 14.3 = 163.02$
Front Porch	42.09 Sq ft	$6.1 \times 6.9 = 42.09$
Fireplace	10.5 Sq ft	$2.1 \times 5 = 10.5$
Storage	90.72 Sq ft	$25.2 \times 3.6 = 90.72$
Storage	75.6 Sq ft	$21 \times 3.6 = 75.6$