

PRIMARY PROPERTY ADDRESS

NO ASSIGNED ADDRESS

PROPERTY INFORMATION

CITY LIMITS:

ETJ: NOT IN ETJ

POLICE DISTRICT: GASTON COUNTY

FIRE DISTRICT: TRYON

2009 SPECIAL FLOOD HAZARD AREA(S):

LOCAL WATERSHED: LONG CREEK

CENSUS TRACT: 308.01

TAX VALUES

MARKET LAND VALUE: \$860

MARKET IMPR. VALUE: \$0

MARKET VALUE: \$860

FARM DISCOUNT: NO

EXEMPT: NO

TAXABLE VALUE: \$860

TAX INFORMATION

PARCEL #: 152326

PIN #: 3506270840

CURRENT OWNERS: MCFEE PHYLLIS D

MAILING ADDRESS: 610 RAINBOW END LN , BESSEMER CITY, NC 28016-

NBHD #: 6A043

NBHD NAME: WEST CROWDERS MOUNTAIN 6A

TOWNSHIP: CROWDERS MTN TOWNSHIP

LEGAL DESC: . 11 022 014 05 000

DEED BOOK: 4706 **PAGE:** 1698

DEED RECORDING DATE: 11/22/2013

SALES AMOUNT: \$0

PLAT BOOK: **PAGE:**

STRUCTURE TYPE:

YEAR BUILT: 0

SQUARE FOOTAGE: 0

VACANT: VACANT

BASEMENT: NO

BED: 0 **BATH:** 0 **HALF-BATH:**

MULTI-STRUCTURES: NO

ACREAGE: 0.11

TAX CODE: 300

TAX DISTRICT: CHEST RIDGE FD

VOLUNTARY AG DISTRICT: NO

PROPERTY USE: RESIDENTIAL



GASTON COUNTY GIS

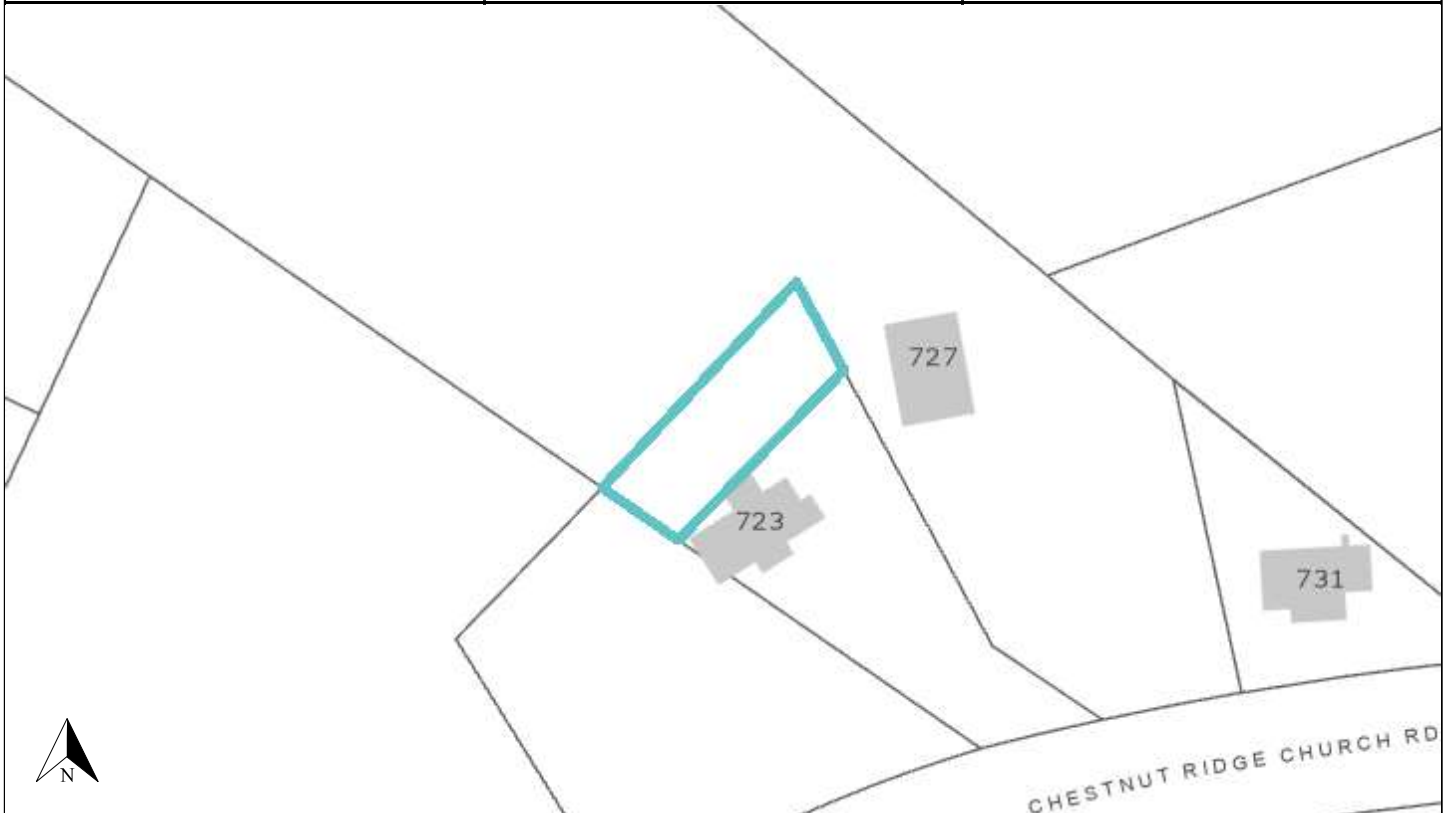

Disclaimer: The information provided is not to be considered as a legal document or description. The map & parcel data is believed to be accurate, but Gaston County does not guarantee its accuracy. Values shown are as of January 1, 2023. - Document created for printing on October 12, 2024