

Building Sketch

Borrower/Client			
Property Address 28403 Hatley Farm Road			
City	Albemarle	County	State NC Zip Code 28001
Lender			

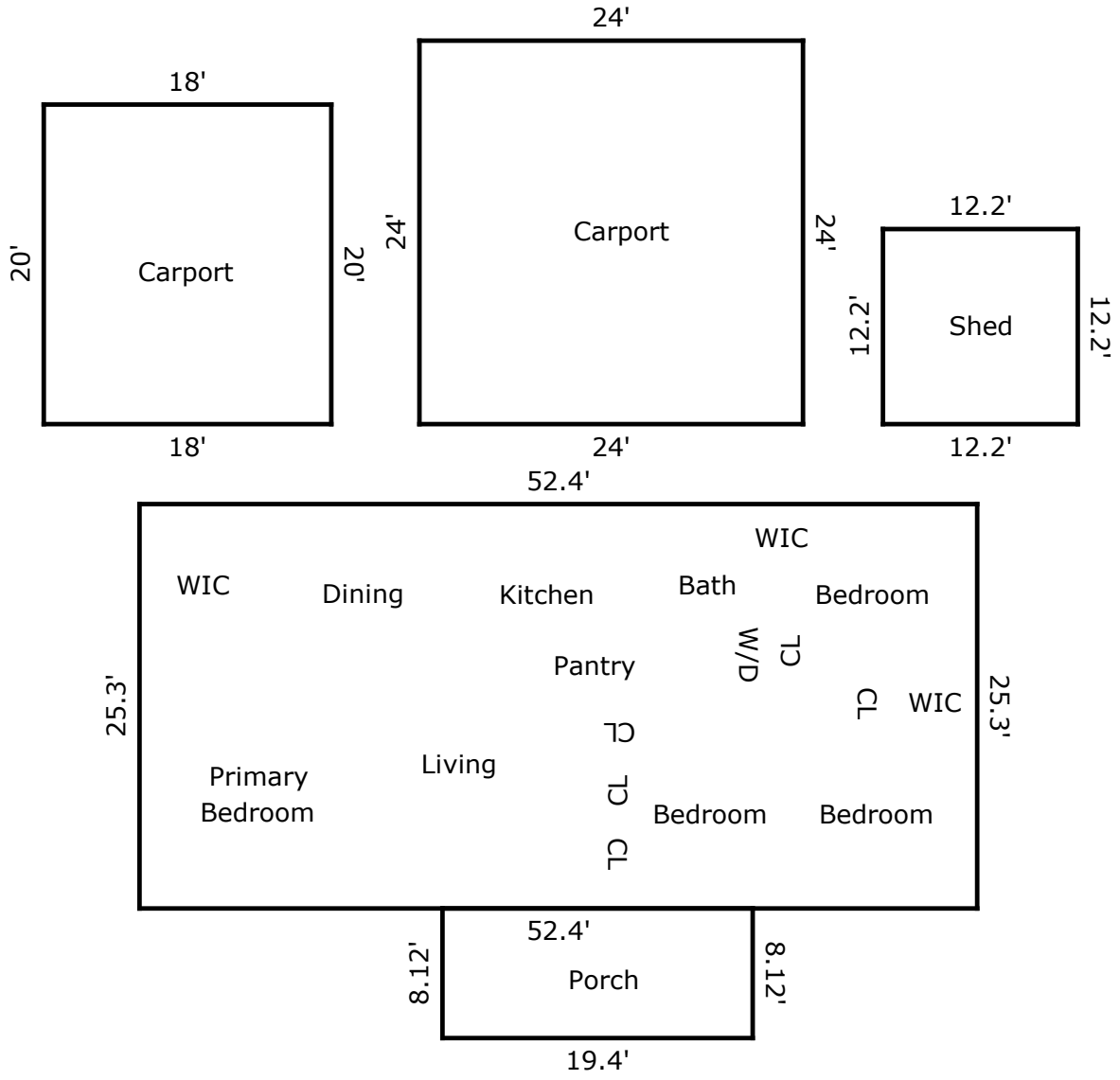

TOTAL Sketch by a la mode

Area Calculations Summary

Living Area	Calculation Details	
Main Living Area	1325.72 Sq ft	$52.4 \times 25.3 = 1325.72$
Total Living Area (Rounded):	1326 Sq ft	
Non-living Area		
Carport	576 Sq ft	$24 \times 24 = 576$
Shed	148.84 Sq ft	$12.2 \times 12.2 = 148.84$
Carport	360 Sq ft	$20 \times 18 = 360$
Porch	157.53 Sq ft	$8.12 \times 19.4 = 157.53$