

Building Sketch

Borrower/Client				
Property Address 162 Four Andrewa Drive				
City	Harmony	County	State	Zip Code 28634
Lender				

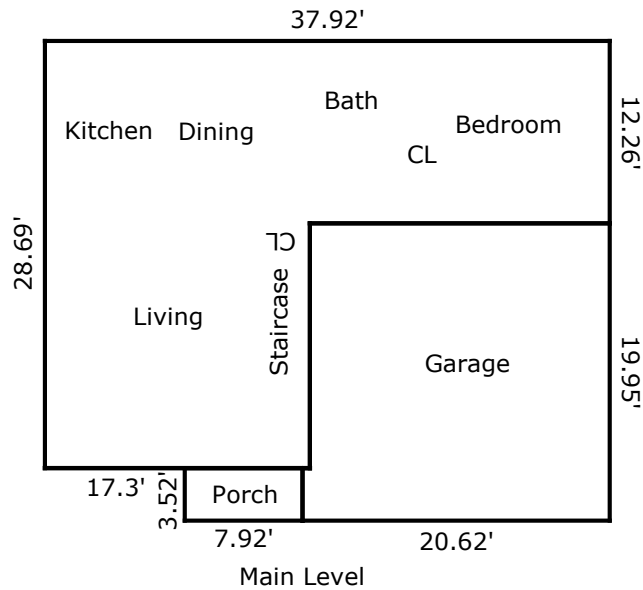
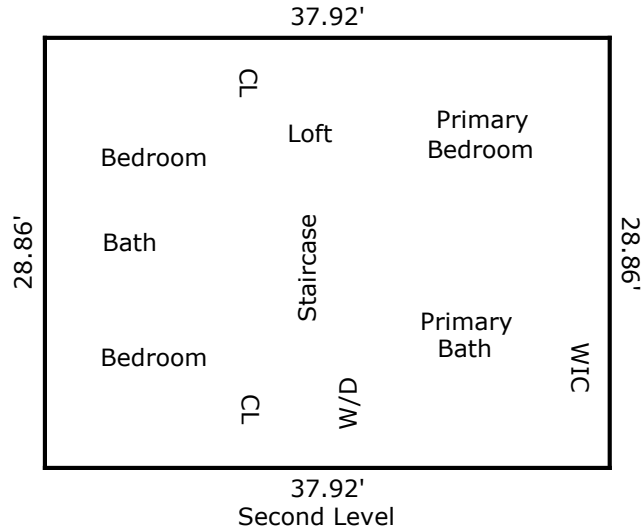

TOTAL Sketch by a la mode

Area Calculations Summary

Living Area	Calculation Details	
Main Living Area	757.35 Sq ft	17.8 × 16.43 = 292.45 12.26 × 37.92 = 464.9
Second Level	1094.37 Sq ft	28.86 × 37.92 = 1094.37
Total Living Area (Rounded):	1852 Sq ft	
Non-living Area		
Garage	403.15 Sq ft	19.95 × 20.12 = 401.39 0.5 × 3.52 = 1.76
Porch	27.88 Sq ft	7.92 × 3.52 = 27.88