

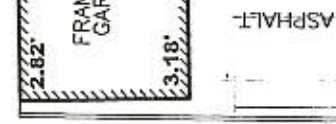

N 42° 47' 30" W 50.00'

C.L. FENCE
0.93' S.W.



122.99'

N 47° 58' 30" E 121.63'

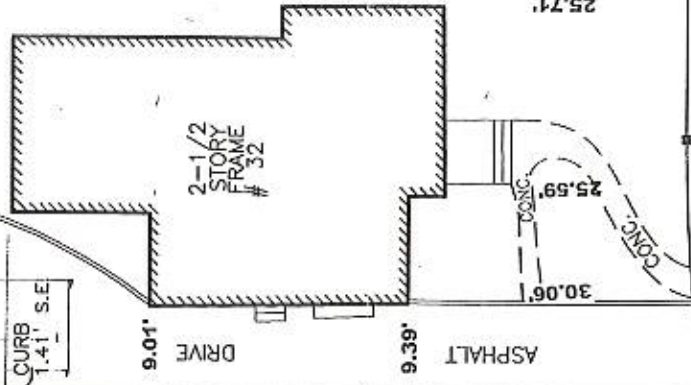

S 47° 58' 30" W

25.71'

ASPHALT

CURB
0.98' N.W.

POB 100.89'

S 42° 01' 30" E
23.24'

CURB
1.38' S.E.
R = 177.50'
L = 26.86'

MYRTLE AVENUE

BAILEY ROAD

NO RESPONSIBILITY OR LIABILITY IS ASSUMED BY SURVEYOR FOR USE OF CURVE FOR ANY OTHER PURPOSE INCLUDING, BUT NOT LIMITED TO, USE OF SURVEY FOR SURVEY AFFIDAVIT, RESALE OF PROPERTY, OR TO ANY OTHER PERSON NOT LISTED IN CERTIFICATION, EITHER DIRECTLY OR INDIRECTLY. A WRITTEN "WAIVER AND DIRECTION NOT TO SET CORNER MARKERS" HAS BEEN OBTAINED FROM THE ULTIMATE USER PURSUANT TO N.J.A.C. 13-40-5.1(g). THIS SURVEY IS SUBJECT TO ANY FACTS THAT MAY BE DISCLOSED BY A FULL AND ACCURATE TITLE SEARCH. THIS SURVEY IS NOT VALID WITHOUT THE EMBOSSED SEAL OF THE LICENSED SURVEYOR

SURVEY OF PROPERTY SITUATED AT # 32 BAILEY ROAD IN THE TOWNSHIP OF MILLBURN, ESSEX COUNTY, NEW JERSEY

BEING KNOWN AS LOT 6 IN BLOCK 212 ON THE MAP IN THE TOWNSHIP OF MILLBURN, ESSEX COUNTY, NEW JERSEY

CERTIFY TO INKAI MU & YING LI; NEW JERSEY TITLE INSURANCE COMPANY & HERITAGE ABSTRACT COMPANY; JOSEPH NITTI, ESQ.; IBS MORTGAGE COMPANY, LLC, ITS SUCCESSORS AND/OR ASSIGNS AS THEIR INTEREST MAY APPEAR

REVISED:

P² LAND SURVEYING, INC.
P.O. BOX 437 MT. FREEDOM, NJ 07970
(973) 895-9681 FAX (973) 895-9682

DRAWN BY: CG SCALE: 1" = 20'

DATE: 11/11/05

TITLE NO. JOB NO.

H-84820

05-4636

CHECKED BY: JP

JAMES PICA

PROFESSIONAL LAND SURVEYOR

NEW JERSEY LICENSE NUMBER 246S03795400