

Sketch			
Case Number:	20250403-1	File Number:	202504
Address:	13604 US Hwy 64 W		
City / State:	Siler City / NC	Zip / County:	27344 /
Borrower:			
Lender or Client:	Eric Andrews	Address:	
Prepared By:	Laura Fuelleman	Prepared By A...	

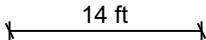

Living Area		Nonliving Area	
First Floor	1779.86 ft²	Sun Porch	172.94 ft²
Laundry-Utility	-63.18 ft²	Stoop	20.48 ft²
		1 Car Carport	289.68 ft²
		Covered Patio	80.00 ft²
Total Living Area (rounded):		1717 ft² Total Non-Living Area (rounded):	563 ft²

This document is designed to be a record of total finished square feet to aid the listing agent in gathering the square feet facts of the property. Measurements are obtained by physical observation of the property by a certified Home Measurement Specialist. Within every measurement project, some degree of art of opinion may be applied as well as rounding as set forth in the standards. Final finished square footage will be rounded to the nearest whole number with the goal of being within a 5% margin of error. Information deemed reliable, but not guaranteed.

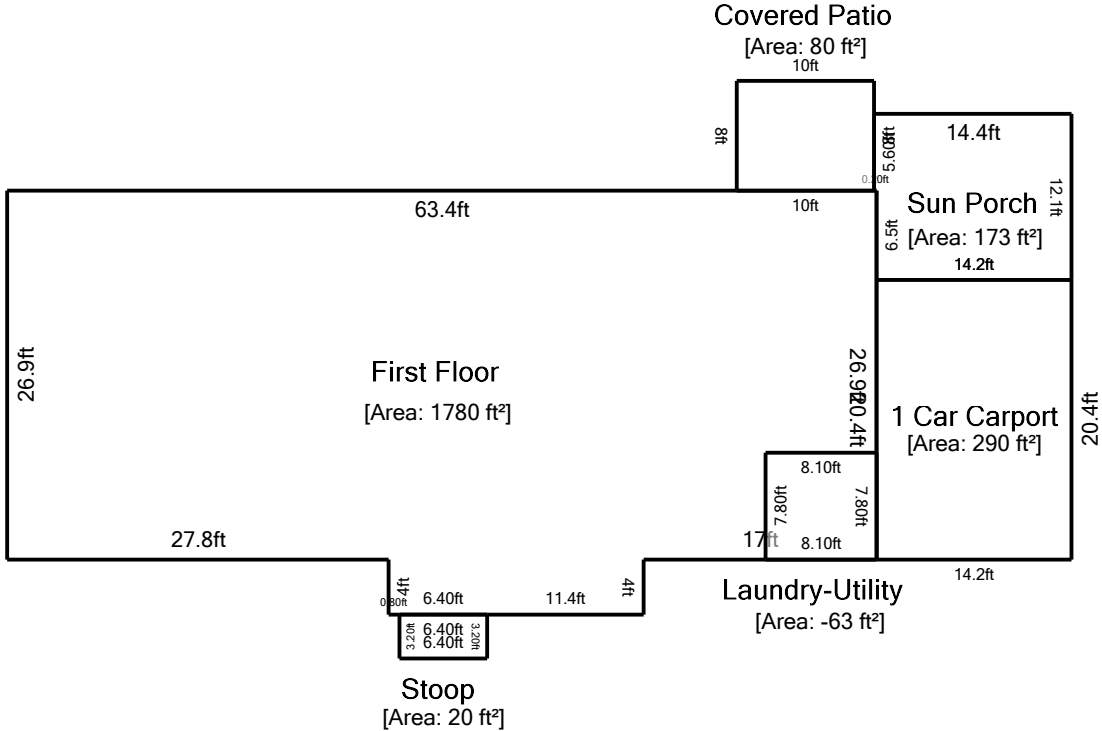