

# Sketch

Case Number: 20250429-1  
Address: 4001 Campbell Road  
City / State: Cary / NC  
Borrower:  
Lender or Client: Justin Burleson  
Prepared By: Laura Fuelleman

File Number: 202504  
Zip / County: 27607 /  
Address:  
Prepared By A...

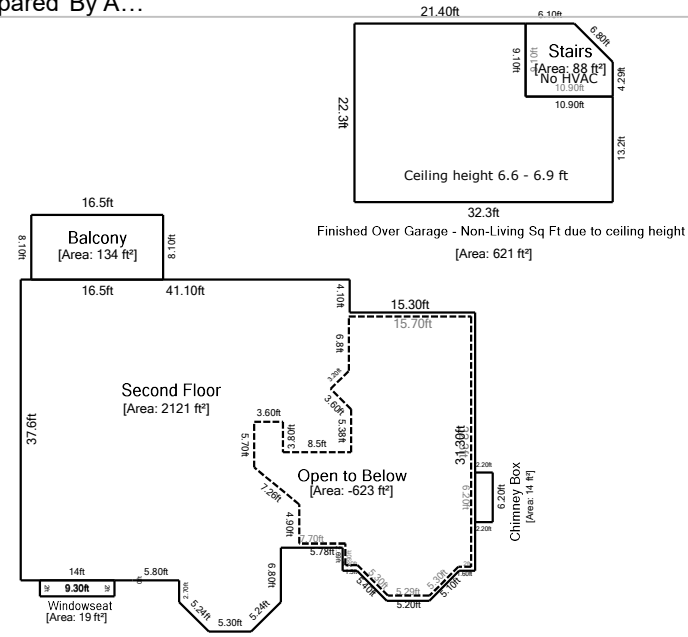
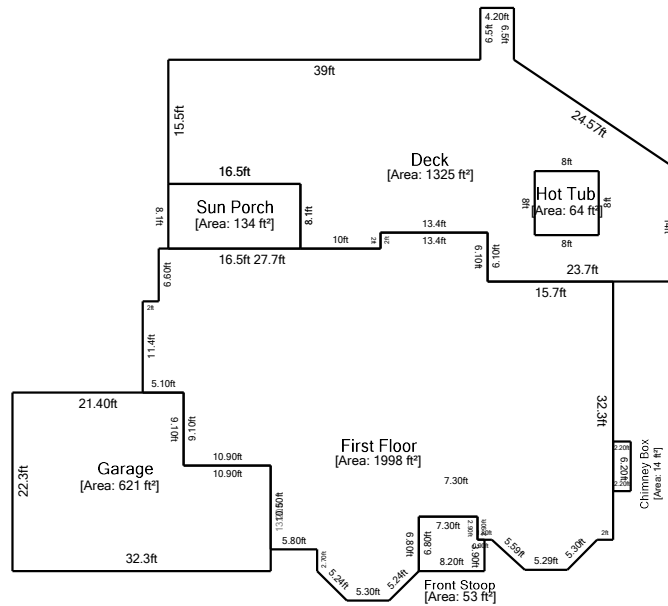

24 ft

Living Area	Nonliving Area	
Second Floor	2121.42 ft²	Chimney Box 13.64 ft²
Open to Below	-623.19 ft²	Chimney Box 13.64 ft²
First Floor	1997.72 ft²	Windowseat 18.60 ft²
		Finished Over Garage - Non-Living Sq Ft due to ceiling height 621.10 ft²
		Stairs 87.69 ft²
		Garage 621.10 ft²
		Sun Porch 133.65 ft²
		Deck 1325.24 ft²
		Hot Tub 64.00 ft²
		Balcony 133.65 ft²
		Front Stoop 53.15 ft²
<b>Total Living Area (rounded):</b>	<b>3496 ft²</b>	<b>Total Non-Living Area (rounded): 3085 ft²</b>

This document is designed to be a record of total finished square feet to aid the listing agent in gathering the square feet facts of the property. Measurements are obtained by physical observation of the property by a certified Home Measurement Specialist. Within every measurement project, some degree of art of opinion may be applied as well as rounding as set forth in the standards. Final finished square footage will be rounded to the nearest whole number with the goal of being within a 5% margin of error. Information deemed reliable, but not guaranteed.