

3126 Tiffany Drive, Belleair Beach, Pinellas County, Florida, United States, 33786

Gross Living Area: 3398 sq. ft

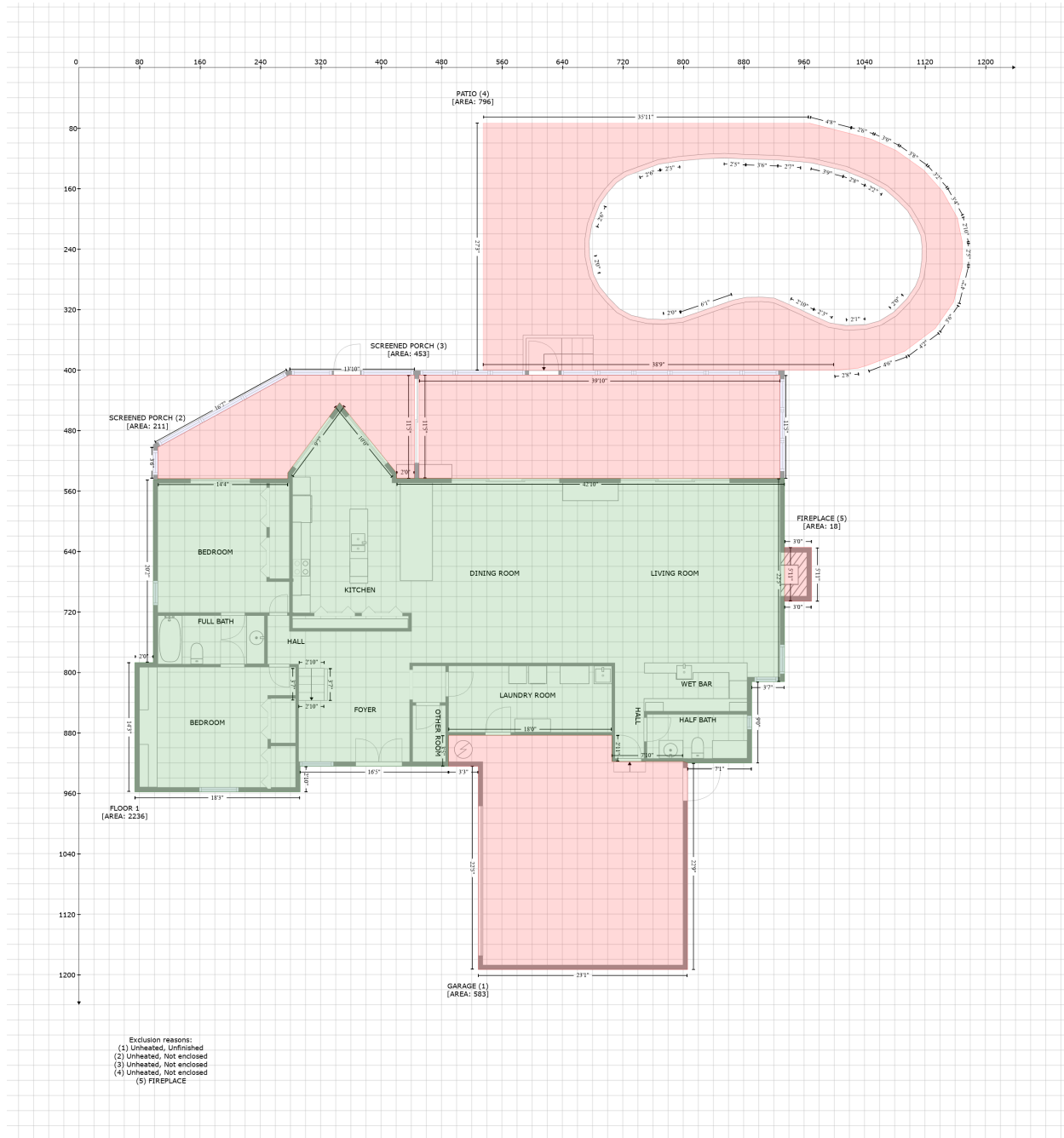

Space	Area (sq. ft)	Calculation
FLOOR 1 (Living area)	2236	Coordinate Polygon Area Algorithm using inches $-((345.1 + 377.6) * (443.5 - 483.9) + (377.6 + 420.5) * (483.9 - 536.5) + (420.5 + 420.5) * (536.5 - 543.6) + (420.5 + 934.1) * (543.6 - 543.6) + (934.1 + 934.1) * (543.6 - 812.6) + (934.1 + 890.7) * (812.6 - 812.6) + (890.7 + 890.7) * (812.6 - 920.2) + (890.7 + 805.7) * (920.2 - 920.2) + (805.7 + 799.7) * (920.2 - 918.2) + (799.7 + 705.5) * (918.2 - 918.2) + (705.5 + 705.5) * (918.2 - 883.5) + (705.5 + 489.4) * (883.5 - 883.5) + (489.4 + 489.4) * (883.5 - 924.5) + (489.4 + 292.8) * (924.5 - 924.5) + (292.8 + 292.8) * (924.5 - 958.4) + (292.8 + 74) * (958.4 - 958.4) + (74 + 74) * (958.4 - 787.3) + (74 + 98.4) * (787.3 - 787.3) + (98.4 + 98.4) * (787.3 - 545.7) + (98.4 + 104.4) * (545.7 -$

3126 Tiffany Drive, Belleair Beach, Pinellas County, Florida, United States, 33786

Gross Living Area: 3398 sq. ft

Space	Area (sq. ft)	Calculation <small>Coordinate Polygon Area Algorithm using inches</small>
GARAGE (Non-living area)	583	$545.7 + (104.4 + 104.4) * (545.7 - 543.9) + (104.4 + 276.5) * (543.9 - 543.9) + (276.5 + 276.5) * (543.9 - 536.3) + (276.5 + 345.1) * (536.3 - 443.5) * 0.5 * 0.00694$ $-((705.5 + 705.5) * (883.5 - 918.2) + (705.5 + 799.7) * (918.2 - 918.2) + (799.7 + 805.7) * (918.2 - 920.2) + (805.7 + 805.7) * (920.2 - 1193.4) + (805.7 + 528.7) * (1193.4 - 1193.4) + (528.7 + 528.7) * (1193.4 - 924.5) + (528.7 + 489.4) * (924.5 - 924.5) + (489.4 + 489.4) * (924.5 - 883.5) + (489.4 + 705.5) * (883.5 - 883.5) * 0.5 * 0.00694$
SCREENED PORCH (Non-living area)	211	$-((444.3 + 444.3) * (407 - 543.6) + (444.3 + 420.5) * (543.6 - 543.6) + (420.5 + 420.5) * (543.6 - 536.5) + (420.5 + 345.1) * (536.5 - 443.5) + (345.1 + 276.5) * (443.5 - 536.3) + (276.5 + 276.5) * (536.3 - 543.9) + (276.5 + 104.4) * (543.9 - 543.9) + (104.4 + 104.4) * (543.9 - 502.4) + (104.4 + 278.7) * (502.4 - 407) + (278.7 + 444.3) * (407 - 407)) * 0.5 * 0.00694$
SCREENED PORCH (Non-living area)	453	$-((928.1 + 928.1) * (407 - 543.6) + (928.1 + 450.3) * (543.6 - 543.6) + (450.3 + 450.3) * (543.6 - 407) + (450.3 + 928.1) * (407 - 407)) * 0.5 * 0.00694$
PATIO (Non-living area)	796	$-((966.1 + 1020.4) * (73.5 - 87.3) + (1020.4 + 1049.7) * (87.3 - 95.1) + (1049.7 + 1082) * (95.1 - 110) + (1082 + 1118.1) * (110 - 135.6) + (1118.1 + 1143.3) * (135.6 - 163.8) + (1143.3 + 1163) * (163.8 - 199.1) + (1163 + 1169.6) * (199.1 - 232.4) + (1169.6 + 1169.9) * (232.4 - 261.6) + (1169.9 + 1157.9) * (261.6 - 310.4) + (1157.9 + 1133.8) * (310.4 - 345.2) + (1133.8 + 1093.6) * (345.2 - 375.3) + (1093.6 + 1043) * (375.3 - 394.4) + (1043 + 1031.8) * (394.4 - 397.8) + (1031.8 + 999.9) * (397.8 - 401) + (999.9 + 535.1) * (401 - 401) + (535.1 + 535.1) * (401 - 73.5) + (535.1 + 966.1) * (73.5 - 73.5) * 0.5 * 0.00694 + -((854.5 + 838.6) * (119.7 - 120.5) + (838.6 + 826.6) * (120.5 - 120.9) + (826.6 + 808.8) * (120.9 - 122.6) + (808.8 + 794.8) * (122.6 - 123.8) + (794.8 + 767.8) * (123.8 - 127.9) + (767.8 + 739.9) * (127.9 - 138) + (739.9 + 730.1) * (138 - 141.5) + (730.1 + 725.3) * (141.5 - 143.4) + (725.3 + 712) * (143.4 - 152.3) + (712 + 699.7) * (152.3 - 165.9) + (699.7 + 689.6) * (165.9 - 180.6) + (689.6 + 679) * (180.6 - 208.2) + (679 + 675.4) * (208.2 - 230.2) + (675.4 + 676.1) * (230.2 - 250.3) + (676.1 + 681.1) * (250.3 - 273.8) + (681.1 + 689.2) * (273.8 - 289.9) + (689.2 + 701.4) * (289.9 - 304.9) + (701.4 + 715.7) * (304.9 - 319.4) + (715.7 + 731.8) * (319.4 - 328.2) + (731.8 + 753.3) * (328.2 - 332.8) + (753.3 + 773.9) * (332.8 - 333.5) + (773.9 + 797.8) * (333.5 - 331.3) + (797.8 + 866.6) * (331.3 - 307.7) + (866.6 + 883.9) * (307.7 - 304.1) + (883.9 + 903.7) * (304.1 - 303.8) + (903.7 + 920.7) * (303.8 - 305.2) + (920.7 + 939) * (305.2 - 312.9) + (939 + 969.3) * (312.9 - 327.2) + (969.3 + 993.8) * (327.2 - 338) + (993.8 + 1015.9) * (338 - 341.6) + (1015.9 + 1041) * (341.6 - 340.5) + (1041 + 1060) * (340.5 - 335.3) + (1060 + 1078.8) * (335.3 - 323.7) + (1078.8 + 1095.9) * (323.7 - 306.3) + (1095.9 + 1107.5) * (306.3 - 289.3) + (1107.5 + 1113) * (289.3 - 275.7) + (1113 + 1115.9) * (275.7 - 255) + (1115.9 + 1116.2) * (255 - 236.5) + (1116.2 + 1114.5) * (236.5 - 222.6) + (1114.5 + 1108.7) * (222.6 - 209.4) + (1108.7 + 1097.1) * (209.4 - 189.8) + (1097.1 + 1082.8) * (189.8 - 175.1) + (1082.8 + 1066.7) * (175.1 - 161.2) + (1066.7 + 1043.8) * (161.2 - 148.9) + (1043.8 + 1014.3) * (148.9 - 136.7) + (1014.3 + 970.9) * (136.7 - 126.5) + (970.9 + 956.5) * (126.5 - 124.8) + (956.5 + 925.9) * (124.8 - 122.4) + (925.9 + 883.5) * (122.4 - 121.1) + (883.5 + 854.5) * (121.1 - 119.7)) * 0.5 * 0.00694$
FIREPLACE (Non-living area)	18	$-((969.9 + 969.9) * (635 - 706.2) + (969.9 + 934.1) * (706.2 - 706.2) + (934.1 + 934.1) * (706.2 - 635) + (934.1 + 969.9) * (635 - 635)) * 0.5 * 0.00694$

3126 Tiffany Drive, Belleair Beach, Pinellas County, Florida, United States, 33786

Gross Living Area: 3398 sq. ft



Space	Area (sq. ft)	Calculation
FLOOR 2 (Living area)	1162	Coordinate Polygon Area Algorithm using inches $-((379.5 + 379.5) * (68 - 144.5) + (379.5 + 591.7) * (144.5 - 144.5) + (591.7 + 591.7) * (144.5 - 402.1) + (591.7 + 486.5) * (402.1 - 402.1) + (486.5 + 486.5) * (402.1 - 402.5) + (486.5 + 485.6) * (402.5 - 402.5) + (485.6 + 485.6) * (402.5 - 524.5) + (485.6 + 391.2) * (524.5 - 524.5) + (391.2 + 391.2) * (524.5 - 400.1) + (391.2 + 326.6) * (400.1 - 400.1) + (326.6 + 326.6) * (400.1 - 505.5) + (326.6 + 254.3) * (505.5 - 505.5) + (254.3 + 254.3) * (505.5 - 518.5) + (254.3 + 248.3) * (518.5 - 524.5) + (248.3 + 248.3) * (524.5 - 408.8) + (248.3 + 61.8) * (408.8 - 408.8) + (61.8 + 61.8) * (408.8 - 144.5) + (61.8 + 249) * (144.5 - 144.5) + (249 + 249) * (144.5 - 68) + (249 + 379.5) * (68 -$

3126 Tiffany Drive, Belleair Beach, Pinellas County, Florida, United States, 33786

Gross Living Area: 3398 sq. ft

Space	Area (sq. ft)	Calculation <small>Coordinate Polygon Area Algorithm using inches</small>
OPEN TO BELOW (Non-living area)	65	$\begin{aligned} &68)) * 0.5 * 0.00694 \\ &-((391.2 + 391.2) * (400.1 - 524.5) + (391.2 + 248.3) * (524.5 - 524.5) + (248.3 + 254.3) * (524.5 - \\ &518.5) + (254.3 + 254.3) * (518.5 - 505.5) + (254.3 + 326.6) * (505.5 - 505.5) + (326.6 + 326.6) * \\ &(505.5 - 400.1) + (326.6 + 391.2) * (400.1 - 400.1)) * 0.5 * 0.00694 \end{aligned}$