

Building Sketch (Page - 1)

Borrower				
Property Address	1711 S Rainbow Ranch Rd			
City	Wimberley	County	Hays	State TX Zip Code 78676
Lender/Client	Jim Donaldson			

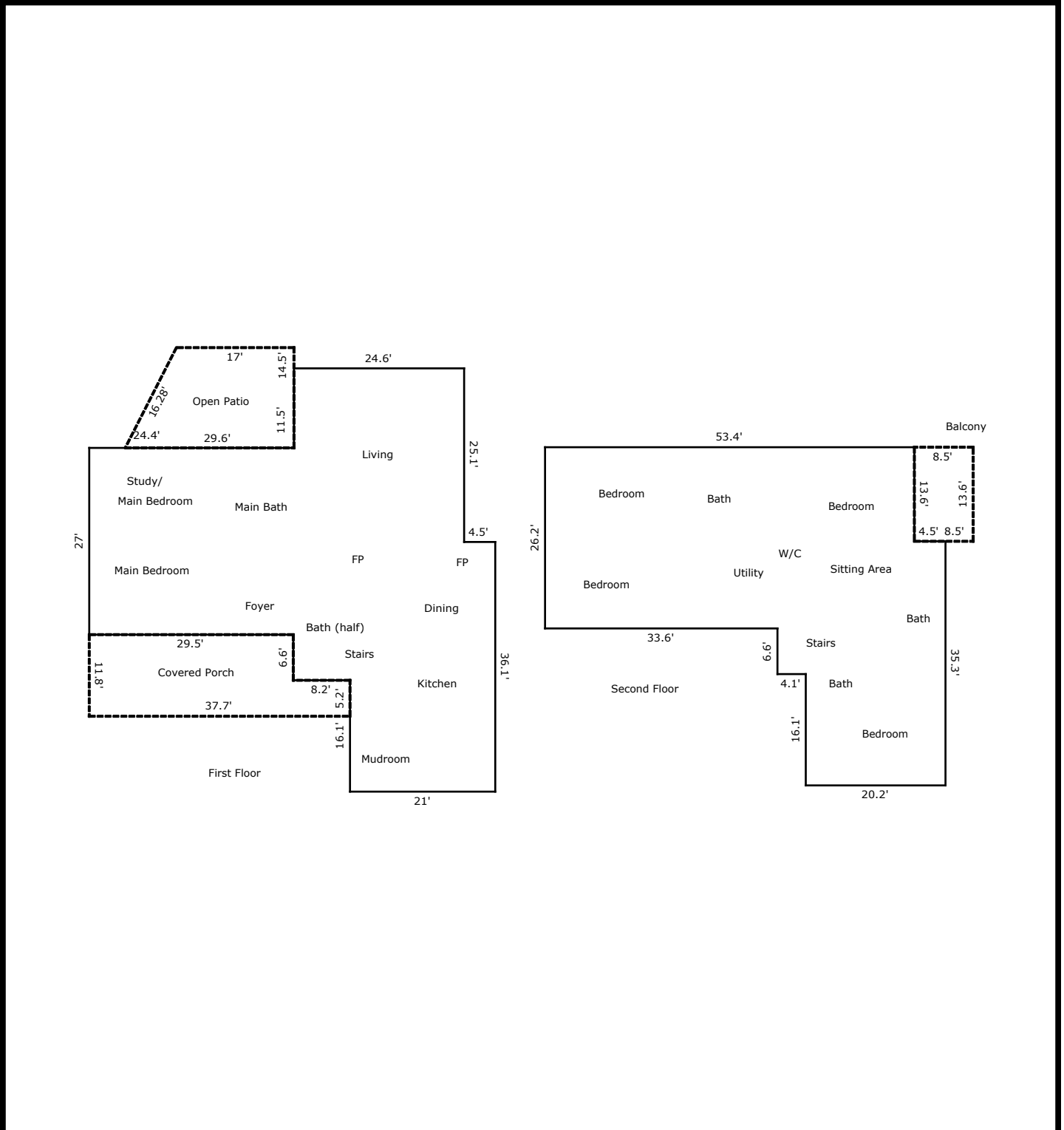

TOTAL Sketch by a la mode

Area Calculations Summary

Living Area	Calculation Details		
First Floor	2337.42 Sq ft	27 × 29.5	= 796.5
		21 × 16.1	= 338.1
		29.2 × 20	= 584
		25.1 × 24.6	= 617.46
		0.1 × 13.6	= 1.36
Second Floor	1941.38 Sq ft	20.2 × 16.1	= 325.22
		26.2 × 33.6	= 880.32
		24.3 × 19.2	= 466.56
		13.6 × 19.8	= 269.28
Total Living Area (Rounded):	4279 Sq ft		
Non-living Area			
Patio	300.15 Sq ft	14.5 × 17	= 246.5
		0.5 × 14.5 × 7.4	= 53.65

Building Sketch (Page - 2)

Borrower				
Property Address	1711 S Rainbow Ranch Rd			
City	Wimberley	County	Hays	State TX Zip Code 78676
Lender/Client	Jim Donaldson			

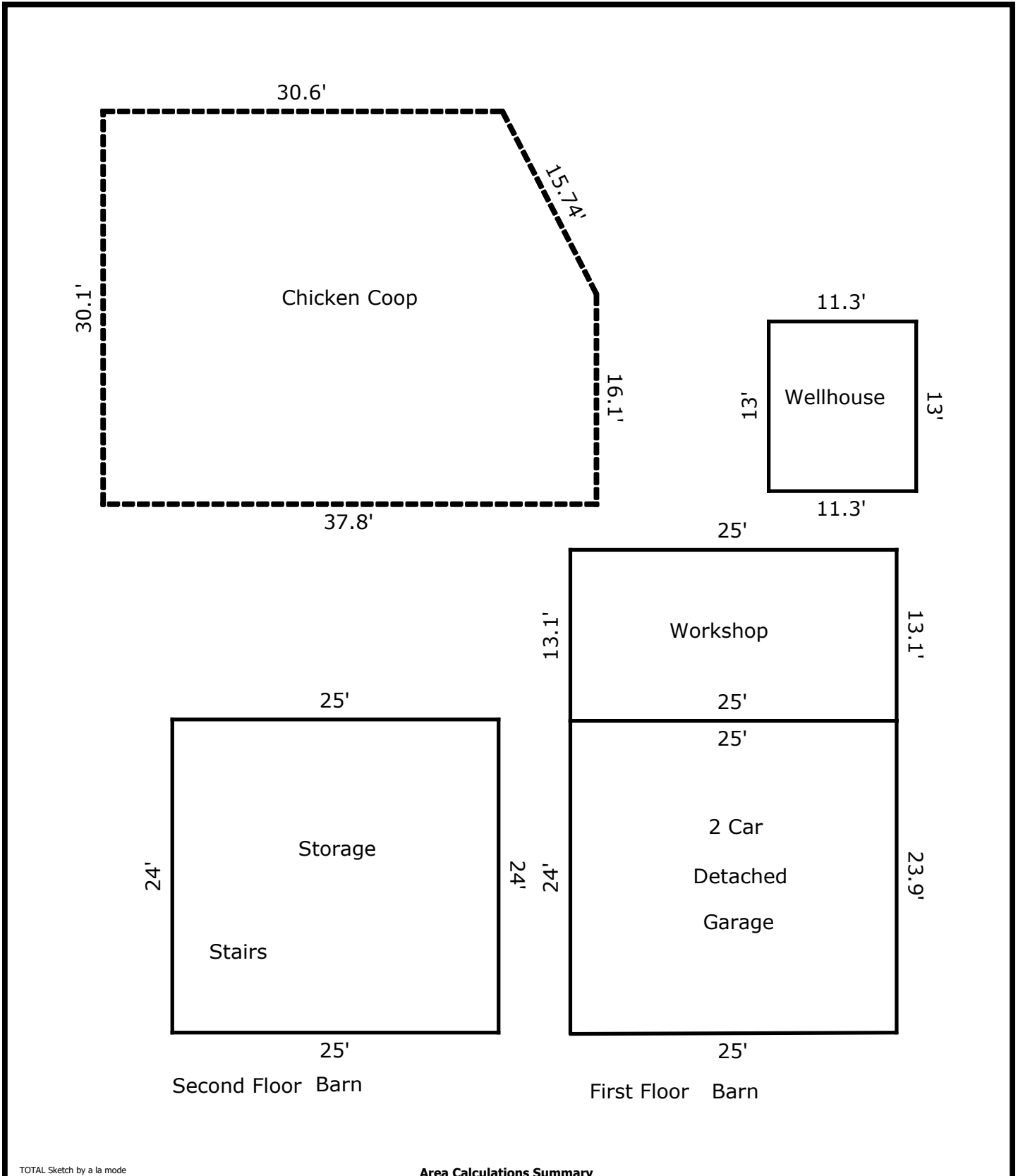

TOTAL Sketch by a la mode

Area Calculations Summary

Non-living Area		
2 Car Detached	598.75 Sq ft	$25 \times 23.9 = 597.5$ $0.5 \times 25 \times 0.1 = 1.25$
Well House	146.9 Sq ft	$13 \times 11.3 = 146.9$
Workshop	327.5 Sq ft	$25 \times 13.1 = 327.5$
Storage	600 Sq ft	$25 \times 24 = 600$