

Building Sketch

Borrower/Client			
Property Address 11700 Mt. Olive Road			
City Gold Hill	County	State NC	Zip Code 28071
Lender			

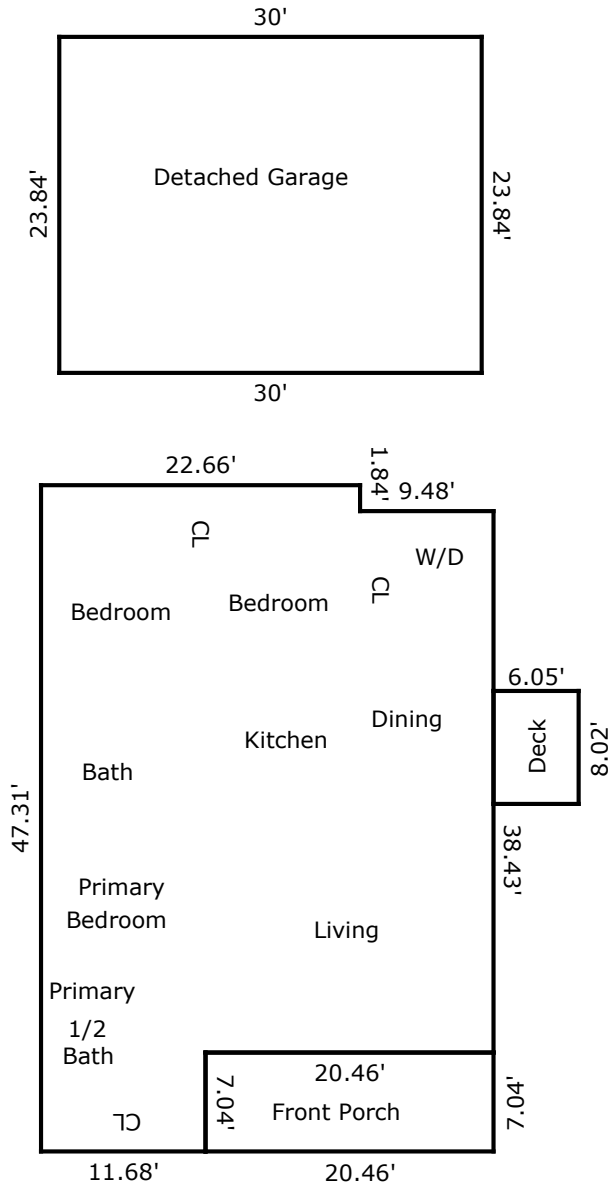

TOTAL Sketch by a la mode

Area Calculations Summary

Living Area	
Main Level	1359.06 Sq ft
Total Living Area (Rounded):	1359 Sq ft
Non-living Area	
Detached Garage	715.2 Sq ft
Deck	48.52 Sq ft
Porch	144.04 Sq ft