

# 3948 Leyte Drive, Maryville, Blount County, Tennessee, United States, 37801



## Property Summary

 **1** garages     **3** bedrooms     **2** bathrooms     **0** half baths

 **1** floors

 **1,957** Gross Living Area sqft

 **3,007** total sqft

# 3948 Leyte Drive, Maryville, Blount County, Tennessee, United States, 37801

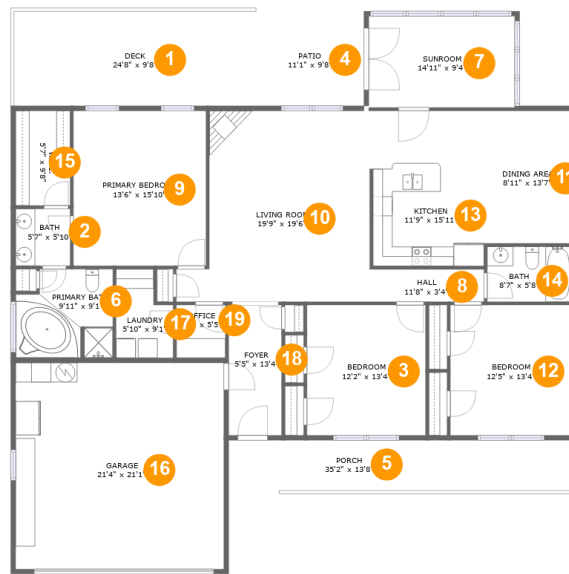

## Room Dimensions

Floor 1

Total sqft: 3007

Living area: 1957

#	Room name	Dimensions	Area (sqft)	Counted as Living Area
1	Deck	24'8" x 9'8"	239 sq. ft	No
2	Bath	5'7" x 5'10"	32 sq. ft	Yes
3	Bedroom	12'2" x 13'4"	162 sq. ft	Yes
4	Patio	11'1" x 9'8"	107 sq. ft	No
5	Porch	35'2" x 13'8"	226 sq. ft	No
6	Primary Bath	9'11" x 9'1"	83 sq. ft	Yes
7	Sunroom	14'11" x 9'4"	139 sq. ft	Yes
8	Hall	11'8" x 3'4"	39 sq. ft	Yes
9	Primary Bedroom	13'6" x 15'10"	215 sq. ft	Yes
10	Living Room	19'9" x 19'6"	331 sq. ft	Yes
11	Dining Area	8'11" x 13'7"	121 sq. ft	Yes

**3948 Leyte Drive, Maryville, Blount County,  
Tennessee, United States, 37801**

#	Room name	Dimensions	Area (sqft)	Counted as Living Area
12	Bedroom	12'5" x 13'4"	165 sq. ft	Yes
13	Kitchen	11'9" x 15'11"	183 sq. ft	Yes
14	Bath	8'7" x 5'8"	49 sq. ft	Yes
15	W.i.c.	5'7" x 9'8"	54 sq. ft	Yes
16	Garage	21'4" x 21'1"	449 sq. ft	No
17	Laundry	5'10" x 9'1"	46 sq. ft	Yes
18	Foyer	5'5" x 13'4"	72 sq. ft	Yes
19	Office	5'0" x 5'5"	27 sq. ft	Yes

# 3948 Leyte Drive, Maryville, Blount County, Tennessee, United States, 37801

## 1 Floor 1 - Deck



Dimensions: 24'8" x 9'8"  
Area: 239 sq. ft  
Counted as Living Area: No

Heated: No  
Finished: Yes  
Enclosed: No  
Contiguous: Yes  
Permitted: Yes  
Wet Space: No  
Addition: No  
Conversion: No

## 2 Floor 1 - Bath



Dimensions: 5'7" x 5'10"  
Area: 32 sq. ft  
Counted as Living Area:  
Yes

Heated: Yes  
Finished: Yes  
Enclosed: Yes  
Contiguous:  
Yes  
Permitted: Yes  
Wet Space: Yes  
Addition: No  
Conversion: No

# 3948 Leyte Drive, Maryville, Blount County, Tennessee, United States, 37801

## 3 Floor 1 - Bedroom



**Dimensions:** 12'2" x 13'4"  
**Area:** 162 sq. ft  
**Counted as Living Area:**  
Yes

**Heated:** Yes  
**Finished:** Yes  
**Enclosed:** Yes  
**Contiguous:**  
Yes  
**Permitted:** Yes  
**Wet Space:** No  
**Addition:** No  
**Conversion:** No

## 4 Floor 1 - Patio



**Dimensions:** 11'1" x 9'8"  
**Area:** 107 sq. ft  
**Counted as Living Area:** No

**Heated:** No  
**Finished:** Yes  
**Enclosed:** No  
**Contiguous:** Yes  
**Permitted:** Yes  
**Wet Space:** No  
**Addition:** No  
**Conversion:** No

## 5 Floor 1 - Porch



**Dimensions:** 35'2" x 13'8"  
**Area:** 226 sq. ft  
**Counted as Living Area:** No

**Heated:** No  
**Finished:** Yes  
**Enclosed:** No  
**Contiguous:** Yes  
**Permitted:** Yes  
**Wet Space:** No  
**Addition:** No  
**Conversion:** No

# 3948 Leyte Drive, Maryville, Blount County, Tennessee, United States, 37801

## 6 Floor 1 - Primary Bath



Dimensions: 9'11" x 9'1"  
Area: 83 sq. ft  
Counted as Living Area:  
Yes

Heated: Yes  
Finished: Yes  
Enclosed: Yes  
Contiguous:  
Yes  
Permitted: Yes  
Wet Space: Yes  
Addition: No  
Conversion: No

## 7 Floor 1 - Sunroom



Dimensions: 14'11" x 9'4"  
Area: 139 sq. ft  
Counted as Living Area:  
Yes

Heated: Yes  
Finished: Yes  
Enclosed: Yes  
Contiguous:  
Yes  
Permitted: Yes  
Wet Space: No  
Addition: No  
Conversion: No

## 8 Floor 1 - Hall



Dimensions: 11'8" x 3'4"  
Area: 39 sq. ft  
Counted as Living Area:  
Yes

Heated: Yes  
Finished: Yes  
Enclosed: Yes  
Contiguous:  
Yes  
Permitted: Yes  
Wet Space: No  
Addition: No  
Conversion: No

# 3948 Leyte Drive, Maryville, Blount County, Tennessee, United States, 37801

## 9 Floor 1 - Primary Bedroom



Dimensions: 13'6" x 15'10"  
Area: 215 sq. ft  
Counted as Living Area:  
Yes

Heated: Yes  
Finished: Yes  
Enclosed: Yes  
Contiguous:  
Yes  
Permitted: Yes  
Wet Space: No  
Addition: No  
Conversion: No

## 10 Floor 1 - Living Room



Dimensions: 19'9" x 19'6"  
Area: 331 sq. ft  
Counted as Living Area:  
Yes

Heated: Yes  
Finished: Yes  
Enclosed: Yes  
Contiguous:  
Yes  
Permitted: Yes  
Wet Space: No  
Addition: No  
Conversion: No

## 11 Floor 1 - Dining Area



Dimensions: 8'11" x 13'7"  
Area: 121 sq. ft  
Counted as Living Area:  
Yes

Heated: Yes  
Finished: Yes  
Enclosed: Yes  
Contiguous:  
Yes  
Permitted: Yes  
Wet Space: No  
Addition: No  
Conversion: No

# 3948 Leyte Drive, Maryville, Blount County, Tennessee, United States, 37801

## 12 Floor 1 - Bedroom



Dimensions: 12'5" x 13'4"  
Area: 165 sq. ft  
Counted as Living Area:  
Yes

Heated: Yes  
Finished: Yes  
Enclosed: Yes  
Contiguous:  
Yes  
Permitted: Yes  
Wet Space: No  
Addition: No  
Conversion: No

## 13 Floor 1 - Kitchen



Dimensions: 11'9" x 15'11"  
Area: 183 sq. ft  
Counted as Living Area:  
Yes

Heated: Yes  
Finished: Yes  
Enclosed: Yes  
Contiguous:  
Yes  
Permitted: Yes  
Wet Space: No  
Addition: No  
Conversion: No

## 14 Floor 1 - Bath



Dimensions: 8'7" x 5'8"  
Area: 49 sq. ft  
Counted as Living Area:  
Yes

Heated: Yes  
Finished: Yes  
Enclosed: Yes  
Contiguous:  
Yes  
Permitted: Yes  
Wet Space: Yes  
Addition: No  
Conversion: No



# 3948 Leyte Drive, Maryville, Blount County, Tennessee, United States, 37801

## 15 Floor 1 - W.i.c.



Dimensions: 5'7" x 9'8"  
Area: 54 sq. ft  
Counted as Living Area:  
Yes

Heated: Yes  
Finished: Yes  
Enclosed: Yes  
Contiguous:  
Yes  
Permitted: Yes  
Wet Space: No  
Addition: No  
Conversion: No

## 16 Floor 1 - Garage



Dimensions: 21'4" x 21'1"  
Area: 449 sq. ft  
Counted as Living Area: No

Heated: No  
Finished: No  
Enclosed: Yes  
Contiguous: Yes  
Permitted: Yes  
Wet Space: No  
Addition: No  
Conversion: No

## 17 Floor 1 - Laundry



Dimensions: 5'10" x 9'1"  
Area: 46 sq. ft  
Counted as Living Area:  
Yes

Heated: Yes  
Finished: Yes  
Enclosed: Yes  
Contiguous:  
Yes  
Permitted: Yes  
Wet Space: No  
Addition: No  
Conversion: No

**3948 Leyte Drive, Maryville, Blount County,  
Tennessee, United States, 37801**

**18 Floor 1 - Foyer**



**Dimensions:** 5'5" x 13'4"  
**Area:** 72 sq. ft  
**Counted as Living Area:**  
Yes

**Heated:** Yes  
**Finished:** Yes  
**Enclosed:** Yes  
**Contiguous:**  
Yes  
**Permitted:** Yes  
**Wet Space:** No  
**Addition:** No  
**Conversion:** No

**19 Floor 1 - Office**



**Dimensions:** 5'0" x 5'5"  
**Area:** 27 sq. ft  
**Counted as Living Area:**  
Yes

**Heated:** Yes  
**Finished:** Yes  
**Enclosed:** Yes  
**Contiguous:**  
Yes  
**Permitted:** Yes  
**Wet Space:** No  
**Addition:** No  
**Conversion:** No