

Building Sketch

Borrower/Client			
Property Address 148 Tetbury Ave NE			
City	Concord	County	State NC
Lender		Zip Code 28025	

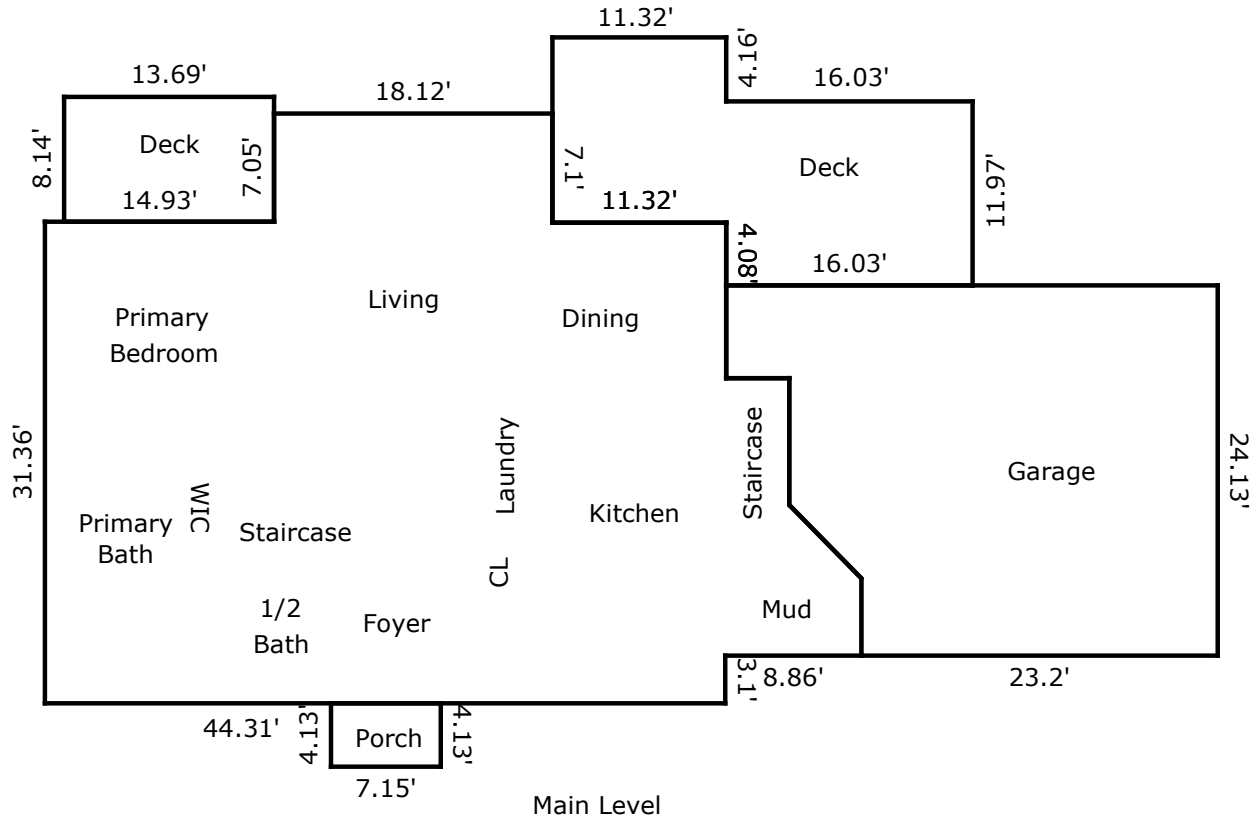

TOTAL Sketch by a la mode

Area Calculations Summary

Living Area	Calculation Details	
Main Living Area	1627.52 Sq ft	$31.36 \times 14.93 = 468.2$ $38.41 \times 18.12 = 695.99$ $31.31 \times 11.26 = 352.55$ $28.21 \times 0.06 = 1.69$ $18.09 \times 4.1 = 74.19$ $0.5 \times 4.78 \times 4.7 = 11.22$ $5.04 \times 4.7 = 23.68$
Total Living Area (Rounded):	1628 Sq ft	
Non-living Area		
Porch	29.53 Sq ft	$7.15 \times 4.13 = 29.53$
Deck	111.44 Sq ft	$8.14 \times 13.69 = 111.44$
Deck	328.29 Sq ft	$12.05 \times 11.32 = 136.41$ $16.03 \times 11.97 = 191.88$
Garage	663.07 Sq ft	$24.13 \times 23.2 = 559.82$ $8.8 \times 6.04 = 53.18$ $4.7 \times 8.27 = 38.85$ $0.5 \times 4.7 \times 4.78 = 11.22$

Building Sketch

Borrower/Client			
Property Address			
City	County	State	Zip Code
Lender			

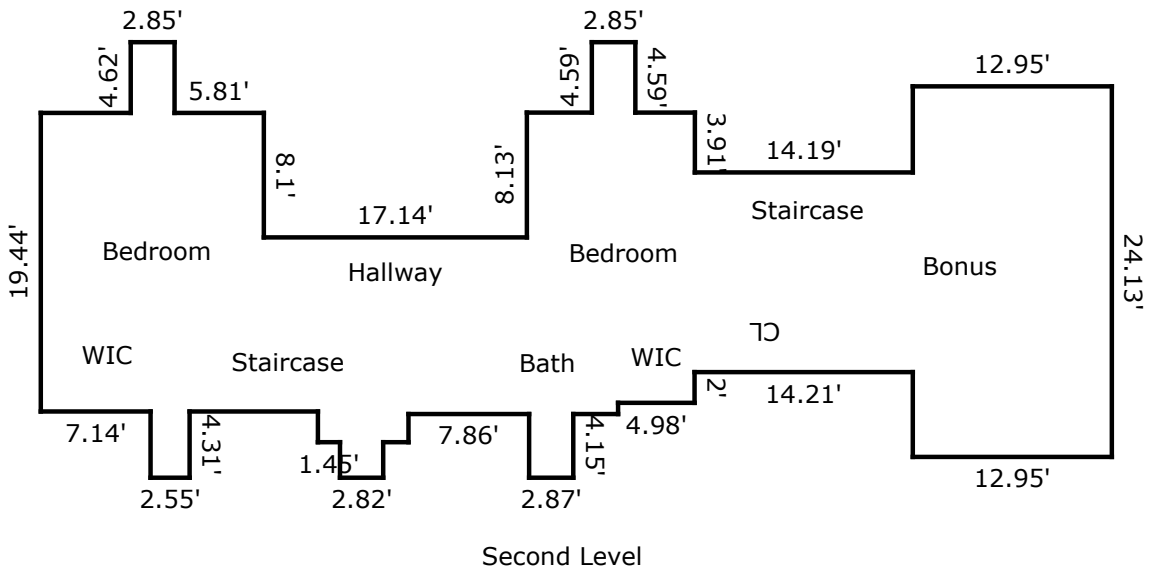

TOTAL Sketch by a la mode

Area Calculations Summary

Living Area	Calculation Details	
Second Level	1253.21 Sq ft	2.87 × 4.15 = 11.91
		2.82 × 2.31 = 6.51
		2.55 × 4.31 = 10.99
		2.85 × 4.62 = 13.17
		2.85 × 4.59 = 13.08
		24.13 × 12.95 = 312.48
		13 × 14.19 = 184.47
		19.44 × 14.51 = 282.07
		10.94 × 8.13 = 88.94
		28.08 × 8.78 = 246.54
		2.56 × 3.52 = 9.01
		4.56 × 5.9 = 26.9
		2 × 4.98 = 9.96
		2.72 × 13.66 = 37.16
Total Living Area (Rounded):	1253 Sq ft	