

Building Sketch

| | | | | |
|--|-------------|--------|----------|----------------|
| Borrower/Client | | | | |
| Property Address 153 Ashford Hollow Lane | | | | |
| City | Mooresville | County | State NC | Zip Code 28117 |
| Lender | | | | |

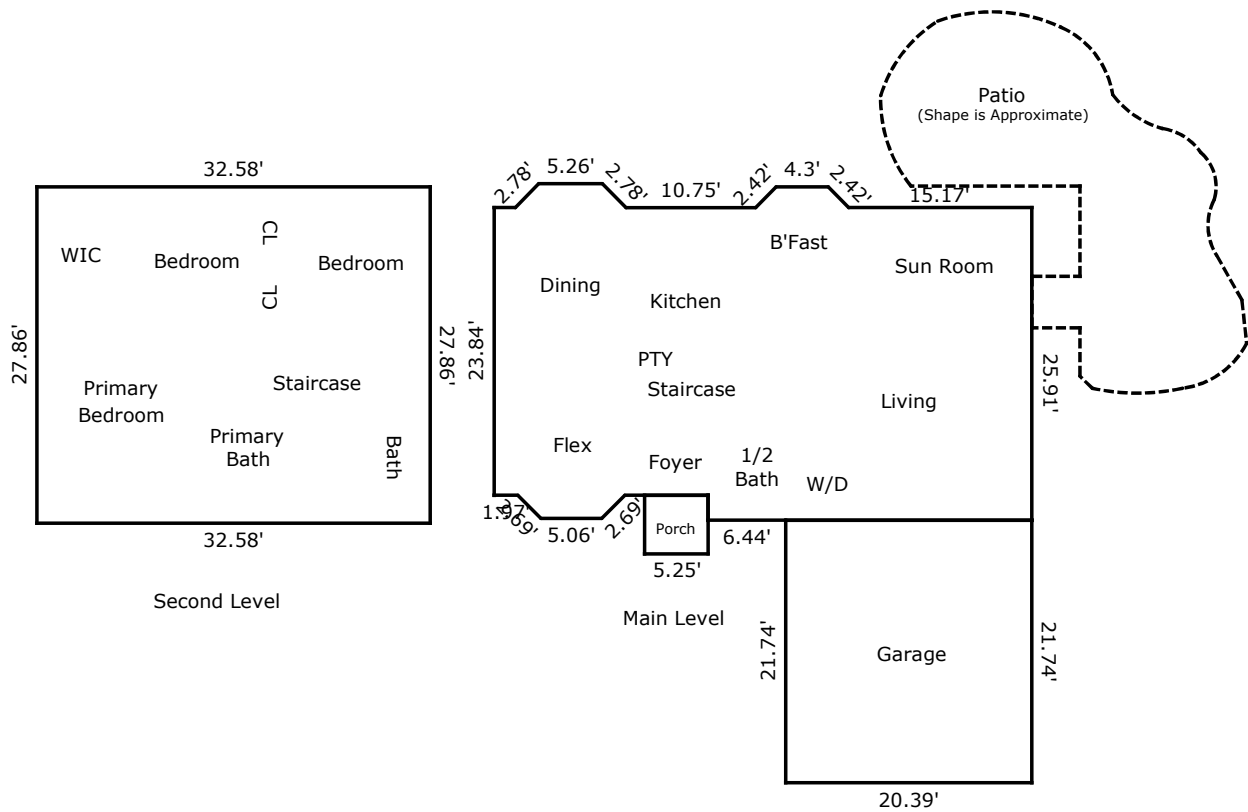

TOTAL Sketch by a la mode

Area Calculations Summary

| | |
|-------------------------------------|-------------------|
| Living Area | |
| Main Level | 1155.63 Sq ft |
| Second Level | 907.68 Sq ft |
| Total Living Area (Rounded): | 2063 Sq ft |
| Non-living Area | |
| Garage | 443.28 Sq ft |
| Porch | 25.46 Sq ft |
| Patio | 500.82 Sq ft |