

Building Sketch

Borrower/Client				
Property Address 1429 Downs Avenue				
City	Charlotte	County	State NC	Zip Code 28205
Lender				

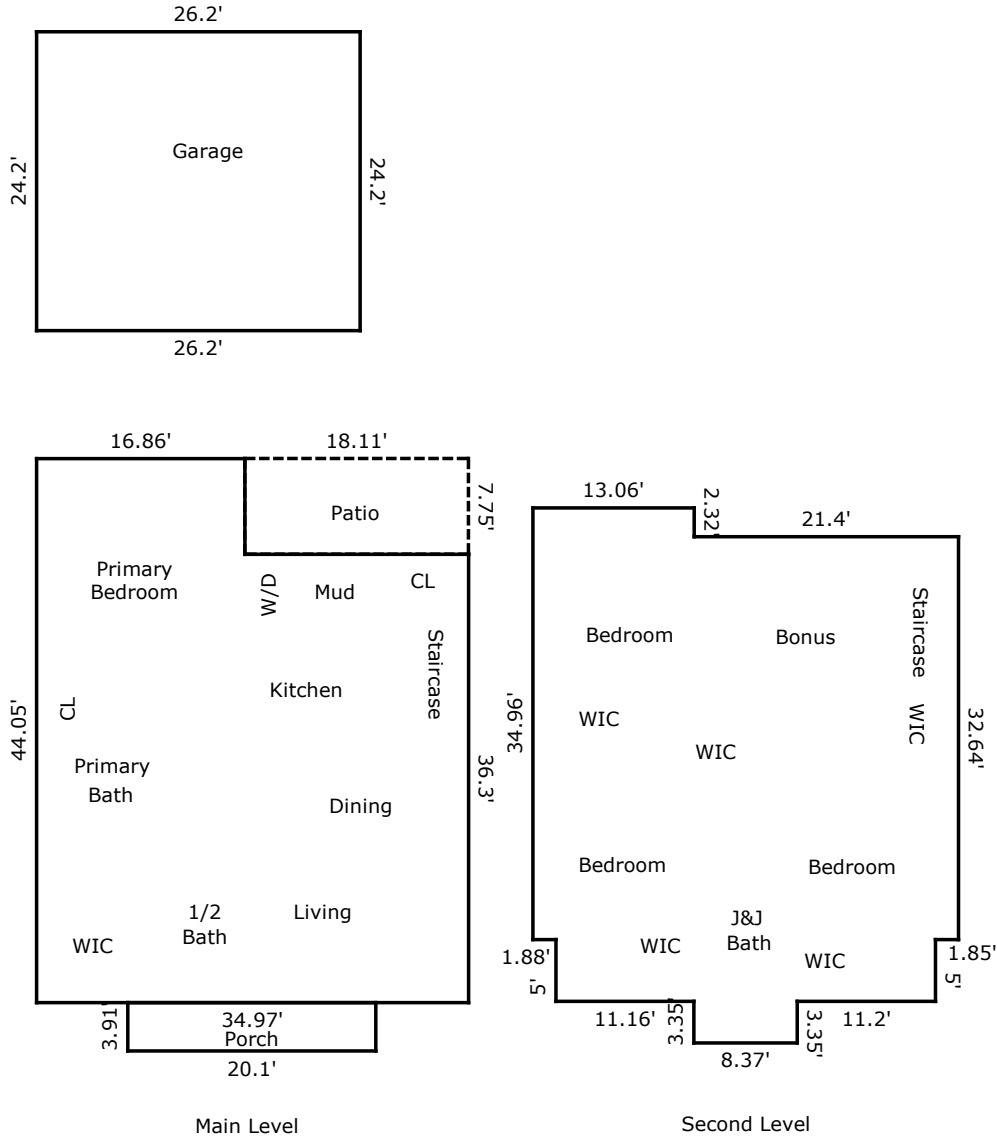

TOTAL Sketch by a la mode

Area Calculations Summary

Living Area	
Main Level	1400.08 Sq ft
Second Level	1336.76 Sq ft
Total Living Area (Rounded):	2737 Sq ft
Non-living Area	
Porch	78.59 Sq ft
Patio	140.35 Sq ft
Garage	634.04 Sq ft