

Below Grade

(Finished Kitchen/Bath area are not connected to the HVAC)

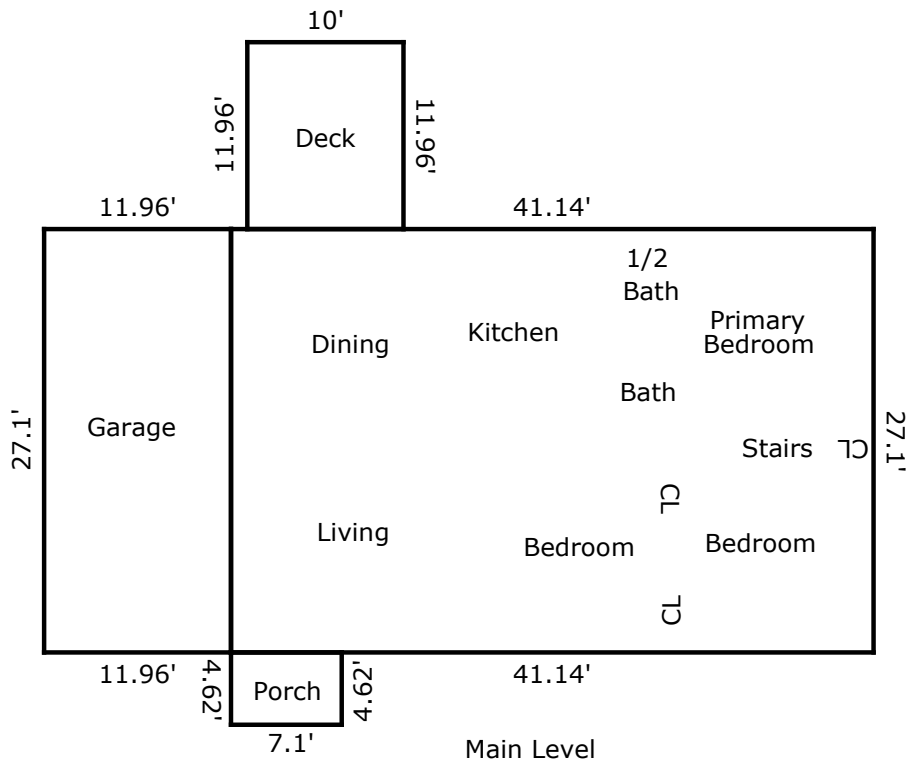

Main Level

TOTAL Sketch by a la mode

Area Calculations Summary

Living Area		Calculation Details
Main Living Area	1114.89 Sq ft	$41.14 \times 27.1 = 1114.89$
Total Living Area (Rounded):	1115 Sq ft	
Non-living Area		
Garage	324.12 Sq ft	$27.1 \times 11.96 = 324.12$
Porch	32.8 Sq ft	$7.1 \times 4.62 = 32.8$
Deck	119.6 Sq ft	$10 \times 11.96 = 119.6$
Below Grade	892.32 Sq ft	$27.15 \times 23.58 = 640.2$ $14.18 \times 17.78 = 252.12$
Below Grade	230.61 Sq ft	$17.78 \times 12.97 = 230.61$