

York County GIS Property Report

Acc #: 105273
2950 COBBY CREEK CT

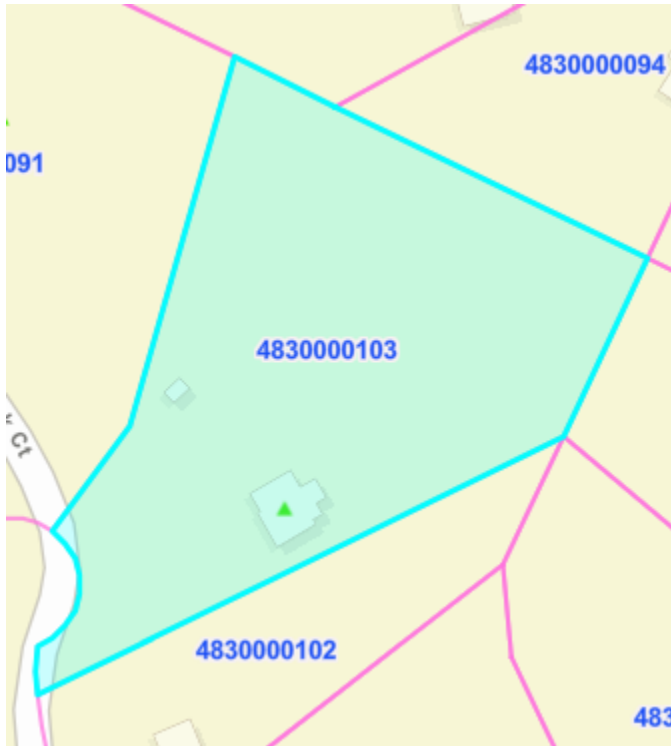

Property Data

Parcel Number: 4830000103
PIN: 4830000103
Lot: 26
Deeded Acres: 3
GIS Acres: 2.52
Deed Book / Page: 4891 / 114
Sold Date: 12/27/2002
Sold Price: 195000
Grantor:
Plat Book / Page: 134 / 21

Legal Description

KINGSBURY ACRES LOT 26 PH I 2.61
AC

Subdivision

KINGSBURY ACRES SDV

Primary Contact (Owner)

Name Line 1 JORDAN EVERETT J JR & ANGELIKA
 Name Line 2
 Name Line 3

Tax Districts

School District: 2LKW
Municipal District:
Fire District: BE-I

Mailing Address

Addr Line 1 2950 COBBY CREEK CT
 Addr Line 2
 Apt
 City CLOVER
 State SC
 Zip 29710
 Country

Values

Market Land Value	\$63250
Market Imp Value	\$174953
Market Misc Value	\$0
Total Market Value	<u>\$238203</u>
Total Taxable Value	\$188025
Total Assessed Value	\$7521

Disclaimer: While every effort is made to keep information provided over the internet accurate and up-to-date, York County does not certify the authenticity or accuracy of such information. No warranties, express or implied, are provided for the records and/or mapping data herein, or for their use or interpretation by the User.

Report Generated: 2/20/2025 11:46 AM