

Sketch

Case Number: 20240909-2
 Address: 120 Orchard Peach Road
 City / State: Garner / NC
 Borrower:
 Lender or Client: Justin Burleson
 Prepared By: Laura Fuelleman

File Number: 2024009
 Zip / County: 27529 /
 Address:
 Prepared By A...

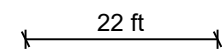
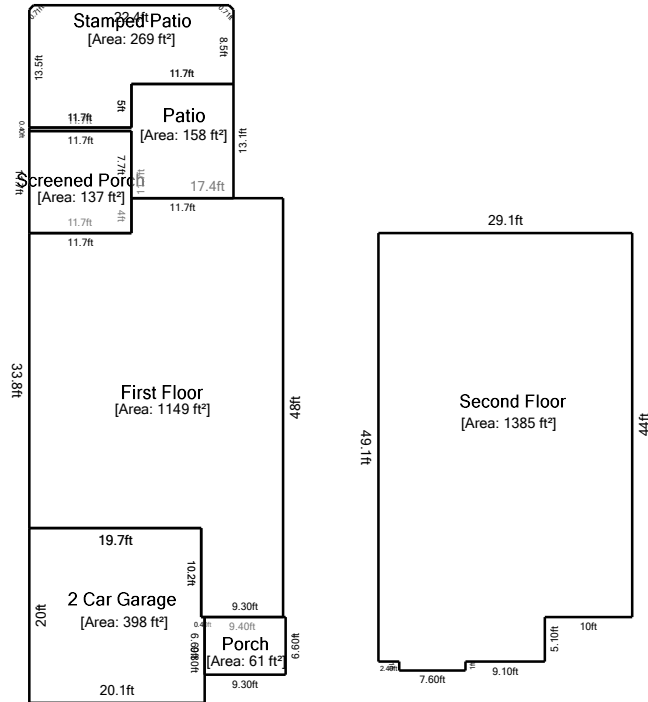

Living Area		Nonliving Area	
First Floor	1149.06 ft ²	2 Car Garage	397.92 ft ²
Second Floor	1385.41 ft ²	Porch	61.38 ft ²
		Screened Porch	136.89 ft ²
		Patio	157.95 ft ²
		Stamped Patio	268.85 ft ²
Total Living Area (rounded):	2534 ft²	Total Non-Living Area (rounded):	1023 ft²

This document is designed to be a record of total finished square feet to aid the listing agent in gathering the square feet facts of the property. Measurements are obtained by physical observation of the property by a certified Home Measurement Specialist. The method of measuring the subject home is in accordance with the NC Residential Square Footage Guidelines and those approved by the American National Standards Institute, Inc (ANSI), which are recognized by the North Carolina Real Estate Commission as comparable standards. Within every measurement project, some degree of art of opinion may be applied as well as rounding as set forth in the standards. Final finished square footage will be rounded to the nearest whole number with the goal of being within a 5% margin of error. Information deemed reliable, but not guaranteed.