

Building Sketch

Borrower/Client			
Property Address 1235 Pebble Point			
City Salisbury	County	State NC	Zip Code 28146
Lender			

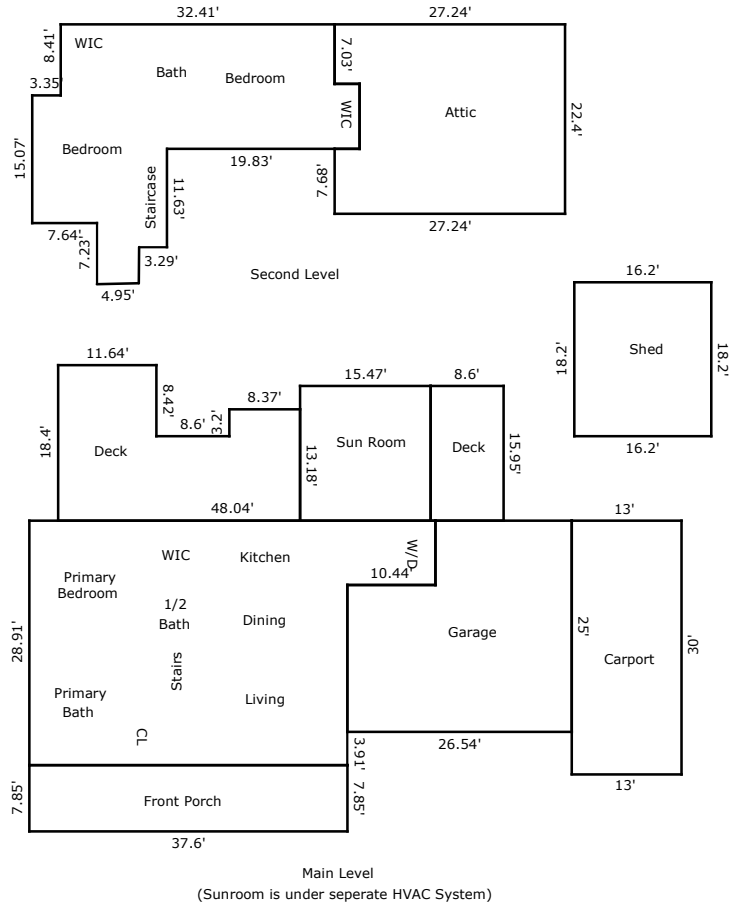

TOTAL Sketch by a la mode

Area Calculations Summary

Living Area

Sunroom	246.75 Sq ft
Main Level	1166.36 Sq ft
Second Level	705.58 Sq ft
Total Living Area (Rounded):	2119 Sq ft

Non-living Area

Deck	410.32 Sq ft
Shed	294.84 Sq ft
Deck	137.17 Sq ft
Garage	584.16 Sq ft
Porch	295.16 Sq ft
Carport	390 Sq ft
Attic	587.57 Sq ft

Building Sketch

Borrower/Client

Property Address 1235 Pebble Point

City Salisbury

County

State NC

Zip Code 28146

Lender

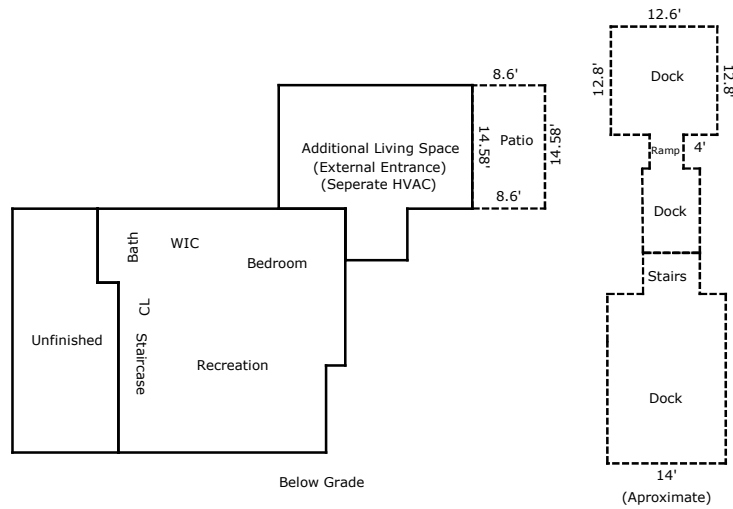

TOTAL Sketch by a la mode

Area Calculations Summary

Living Area

Additional Living Area (External Entrance) 379.02 Sq ft

Below Grade 772.79 Sq ft

Total Living Area (Rounded): 1152 Sq ft

Non-living Area

Patio 125.39 Sq ft

Dock 244.84 Sq ft

Below Grade 339.06 Sq ft

Dock 313.41 Sq ft