

Building Sketch

| | | | | |
|---|--------|--------|----------|----------------|
| Borrower/Client | | | | |
| Property Address 3013 Sandy Ridge Church Road | | | | |
| City | Morven | County | State NC | Zip Code 28119 |
| Lender | | | | |

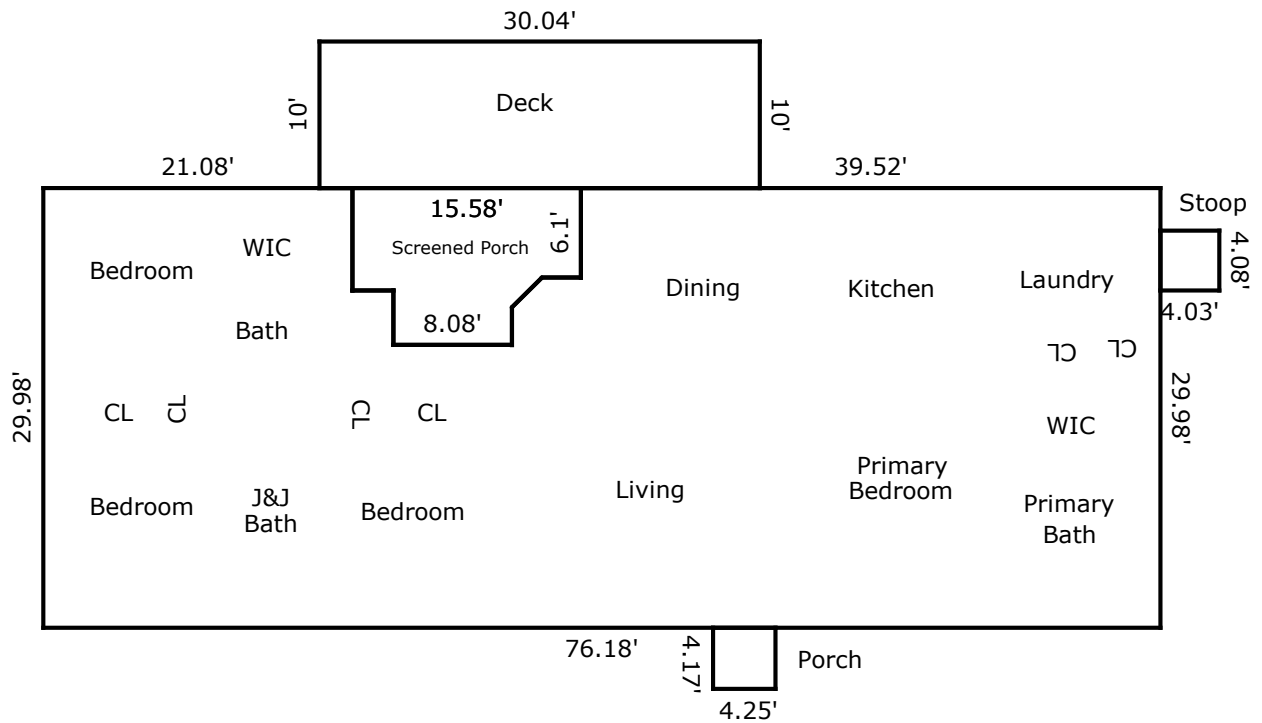

TOTAL Sketch by a la mode

Area Calculations Summary

| | |
|-------------------------------------|-------------------|
| Living Area | |
| Main Level | 2147.19 Sq ft |
| Total Living Area (Rounded): | 2147 Sq ft |
| Non-living Area | |
| Porch | 17.72 Sq ft |
| Stoop | 16.44 Sq ft |
| Deck | 300.4 Sq ft |
| Screened Porch | 136.69 Sq ft |