

FLOORPLAN SKETCH

Borrower:		File No.: 17416
Property Address: 724 Teeter Rd		Case No.:
City: Mooresville	State: NC	Zip: 28117
Lender:		

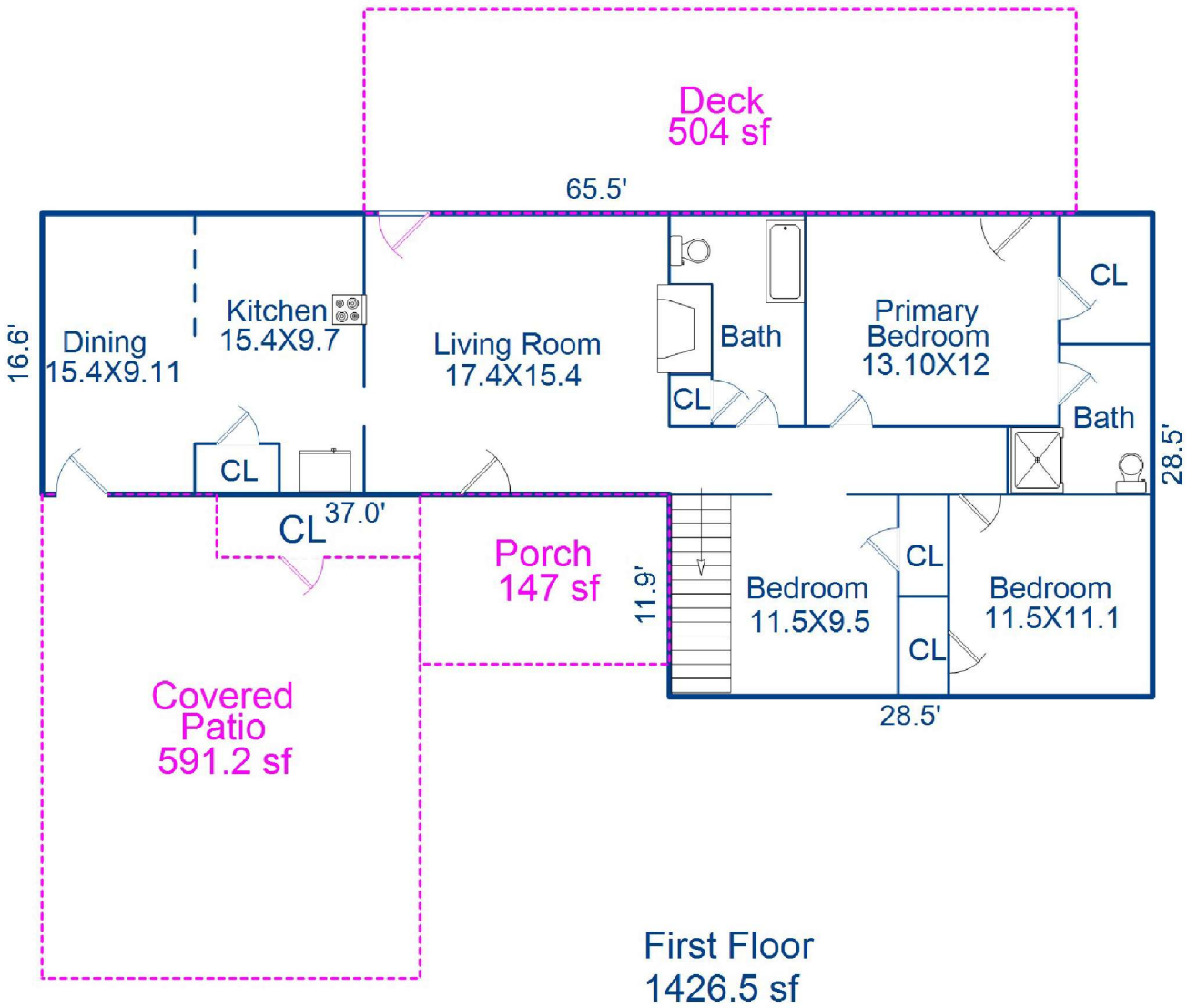

AREA CALCULATIONS SUMMARY						Sketch by ApexSketch				
Code	Description	Factor	Net Size	Perimeter	Net Totals	Name	Base x	Height x	Width =	Area
GLA1	First Floor	1.0	1426.5	188.0	1426.5	First Floor		65.5 x	16.6 =	1087.3
P/P	Wood Deck	1.0	504.0	108.0				28.5 x	11.9 =	339.2
	Porch	1.0	147.0	49.4						
	Patio	1.0	591.2	101.6	1242.2					
Net LIVABLE						2 total items			(rounded)	1,426

FLOORPLAN SKETCH

Borrower:		File No.: 17416
Property Address: 724 Teeter Rd		Case No.:
City: Mooresville	State: NC	Zip: 28117
Lender:		

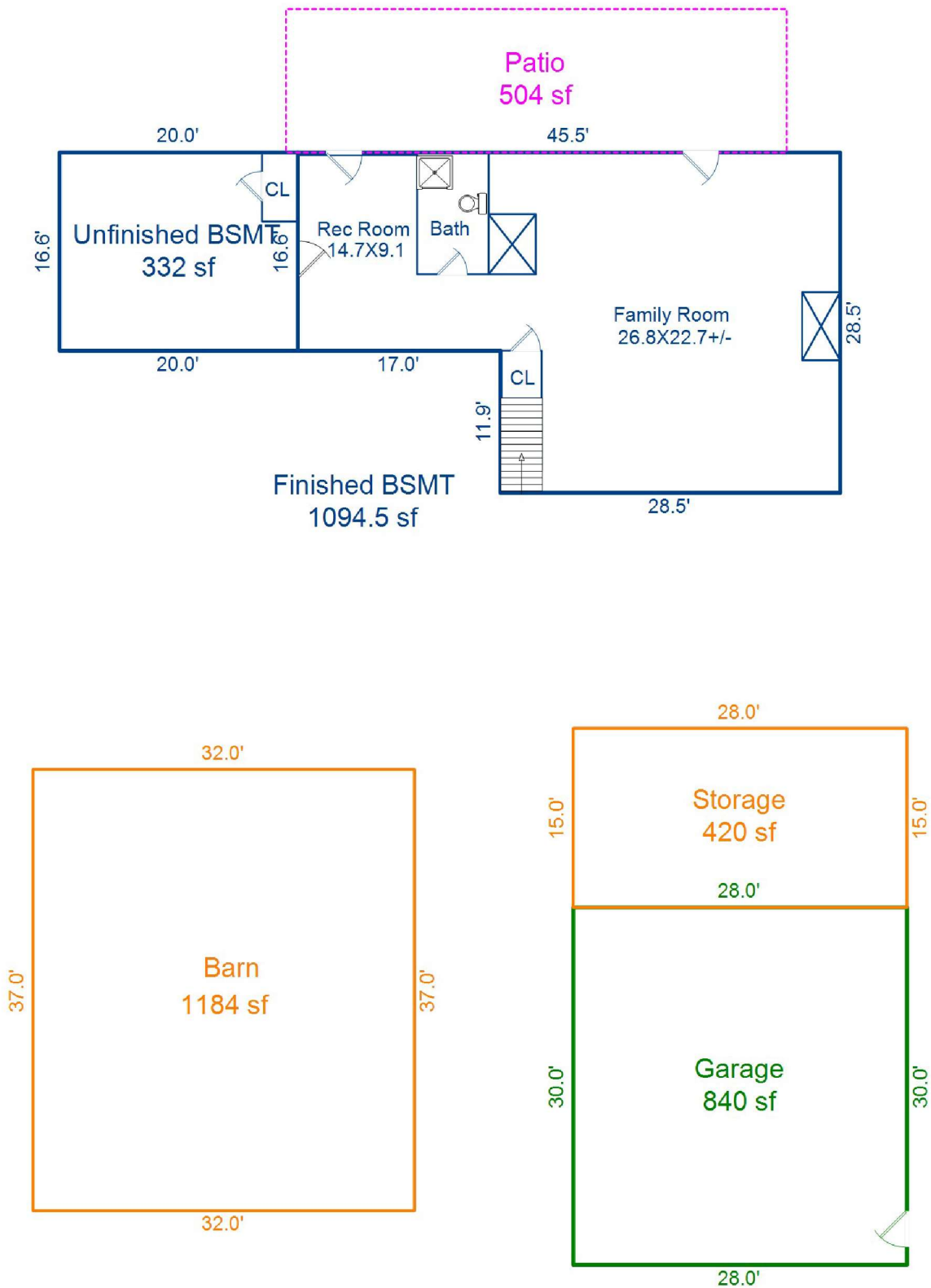

Sketch by ApexSketch

AREA CALCULATIONS SUMMARY						AREA CALCULATIONS BREAKDOWN				
Code	Description	Factor	Net Size	Perimeter	Net Totals	Name	Base x	Height x	Width =	Area
BSMT	Finished BSMT	1.0	1094.5	148.0						
	Unfinished BSMT	1.0	332.0	73.2	1426.5					
GAR	Garage	1.0	840.0	116.0	840.0					
OTH	Storage	1.0	1184.0	138.0						
	Storage	1.0	420.0	86.0	1604.0					
P/P	Patio	1.0	504.0	108.0	504.0					
						0 total items		(rounded)		0

DIMENSION LIST ADDENDUM

Borrower:		File No.: 17416
Property Address: 724 Teeter Rd		Case No.:
City: Mooreville	State: NC	Zip: 28117
Lender:		

GROSS BUILDING AREA (GBA)			3,692
GROSS LIVING AREA (GLA)			1,426
Area(s)	Area	% of GLA	% of GBA
Living	1,426		38.62
Level 1	1,426	100.00	38.62
Level 2			
Level 3			
Other			
	GBA		
Basement	<input checked="" type="checkbox"/> 1,426		38.62
Garage	<input checked="" type="checkbox"/> 840		22.75
Other	<input type="checkbox"/> 3,350		

[illegible]